

AREA 1 - LANDSCAPING MATERIALS AND PLANTS

1. GARDEN SOIL	-3 LOADS (2.7 cu.m./load)
2. CIPLERA (1 ft. - 1 1/2 ft. ht.)	-150 PCS
3. RAPNIS (1 1/2 ft. - 2 ft. ht.)	-15 PCS
4. FOKIEN TEA ROUND	-28 PCS
5. GOLDEN COPIA	-1800 PCS
6. RED CREEPER	-1800 PCS

AREA 2 LANDSCAPING MATERIALS AND PLANTS

1. GARDEN SOIL	-2 LOADS (2.7 cu.m./load)
2. CRUSHED GRAVEL	-2 LOADS (2.7 cu.m./load)
3. WHITE STONE	-50 SACKS
4. GOLDEN MAGUS (10" HT.)	-70 PCS
5. PUDA WAKI CONE (4 1/2 FT. - 6 FT. HT.)	-4 PCS
6. PUDA WAKI ROUND (2 FT. HT.)	-6 PCS
7. CIPLERA (1 FT. - 1 1/2 FT. HT.)	-50 PCS
8. RAPNIS (1 1/2 FT. - 2 FT. HT.)	-5 PCS
9. VOLCANIC ROCK	-1 load (2.7 cu.m./load)

AREA 3.1 & 3.2 LANDSCAPING MATERIALS AND PLANTS

1. GARDEN SOIL	-1 LOAD (2.7 cu.m./load)
2. GOLDEN MAGUS	-35 PCS
3. GOLDEN COPIA	-1000 PCS
4. FOKIEN TEA CONE	-3 PCS
5. SELUM	-3 PCS
6. RED CREEPER (4-5" ht.)	-1000 PCS
7. WHITE STONE	-30 SACKS

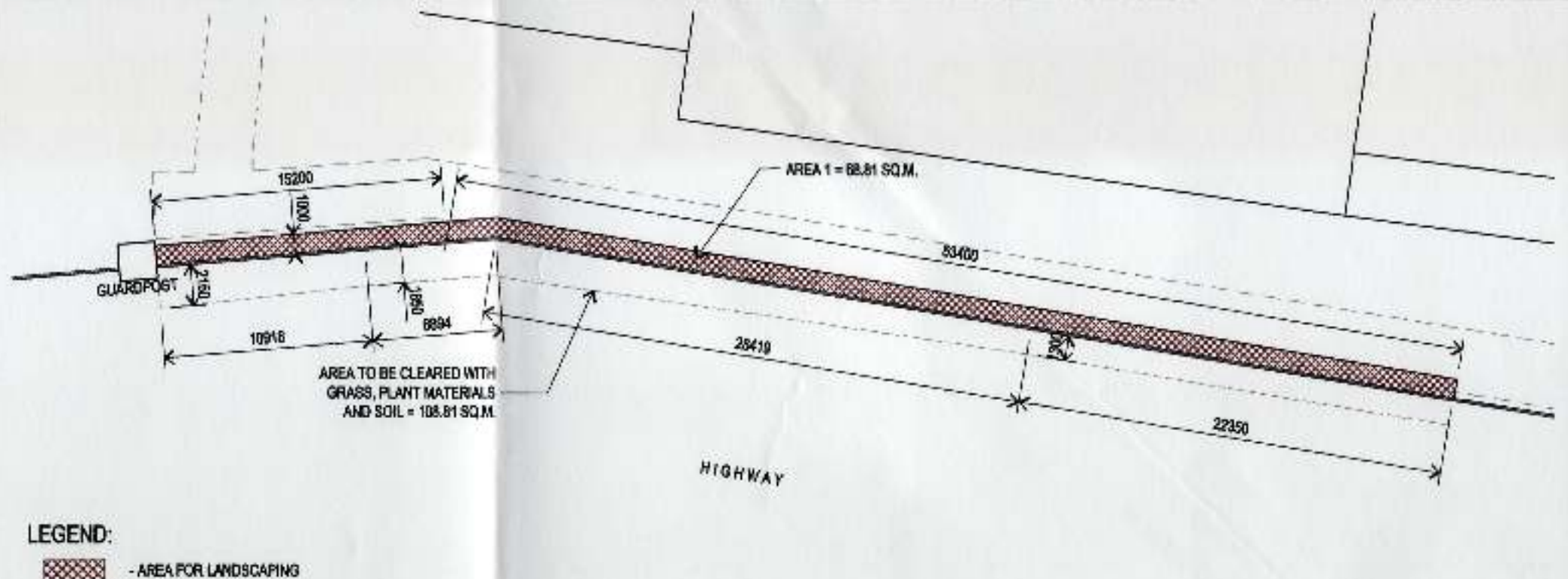

02.1 SCHEDULE OF PLANTS

02.2 BLOW-UP PLAN OF AREA 1 AND THE AREA TO BE CLEARED

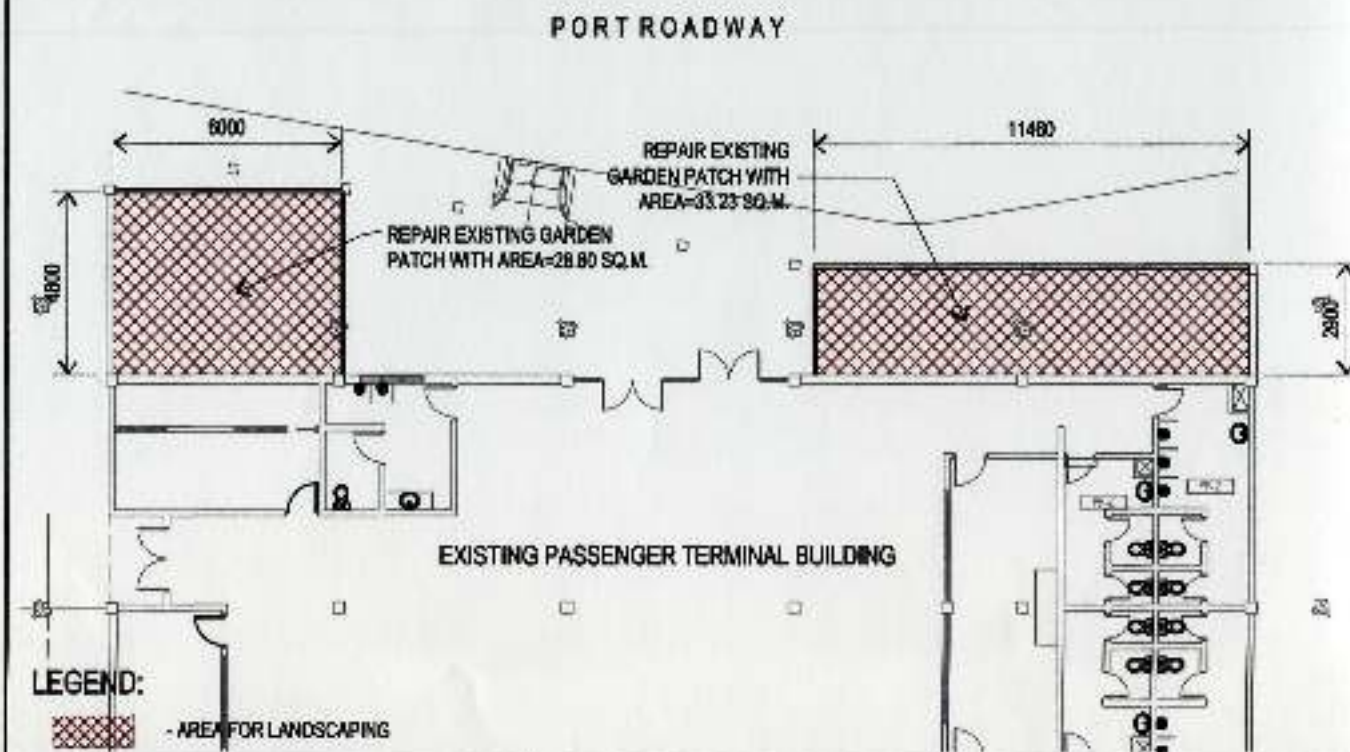

02.3 BLOW-UP PLAN OF AREA 2

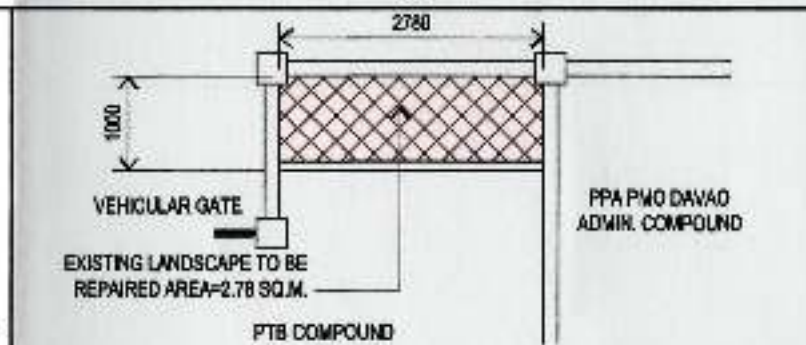

02.4 BLOW-UP PLAN AREA-3.1 (ADJACENT TO VEHICULAR GATE)

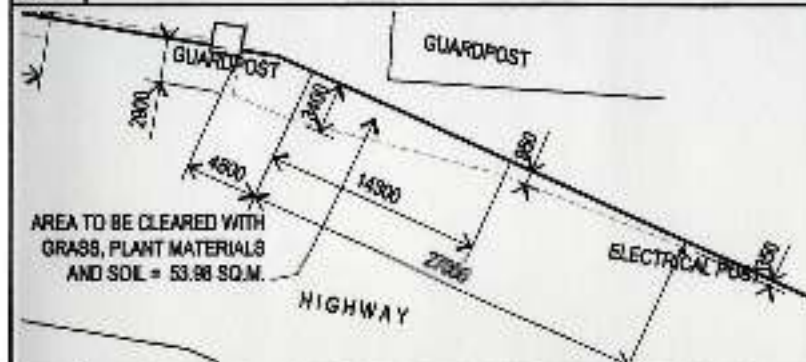

02.5 PLAN OF AREA TO BE CLEARED ALONG THE HIGHWAY

02.6 BLOW-UP PLAN AREA-3.2 (ISLAND LANDSCAPE)

	PREPARED BY:	DRAWN AND REVISION BY:	RECOMMENDING APPROVAL BY:	APPROVED BY:	OWNER:	PROJECT TITLE:	REVISIONS	SHEET NO.	OF
	VICTOR A. JASPE ENGINEERING ASSISTANT-A	LARA SIMONE L. ABA SENIOR ENGINEER-A	ASTERIO G. GALLARDO, JR. ESD MANAGER	ANALEE G. AGUILA PORT MANAGER	ANALEE G. AGUILA PORT MANAGER	SUPPLY OF LABOR AND MATERIALS FOR THE LANDSCAPING OF PASSENGER TERMINAL AREA	DATE: _____ REVISION: _____ ADDENDUM: _____	02	2