

TECHNICAL DESCRIPTION PORT ZONE DELINEATION		
LINE	BEARING	DISTANCE
1 - 2	N 71° - 30' E	220.00 M
2 - 3	N 42° - 00' E	200.00 M
3 - 4	N 18° - 10' W	1,200.00 M
4 - 5	S 71° - 30' W	1,355.00 M
5 - 6	S 26° - 59' E	1,152.00 M
6 - 1	N 83° - 00' E	800.00 M
AREA = approx. 1,559,527.50 sq.m		

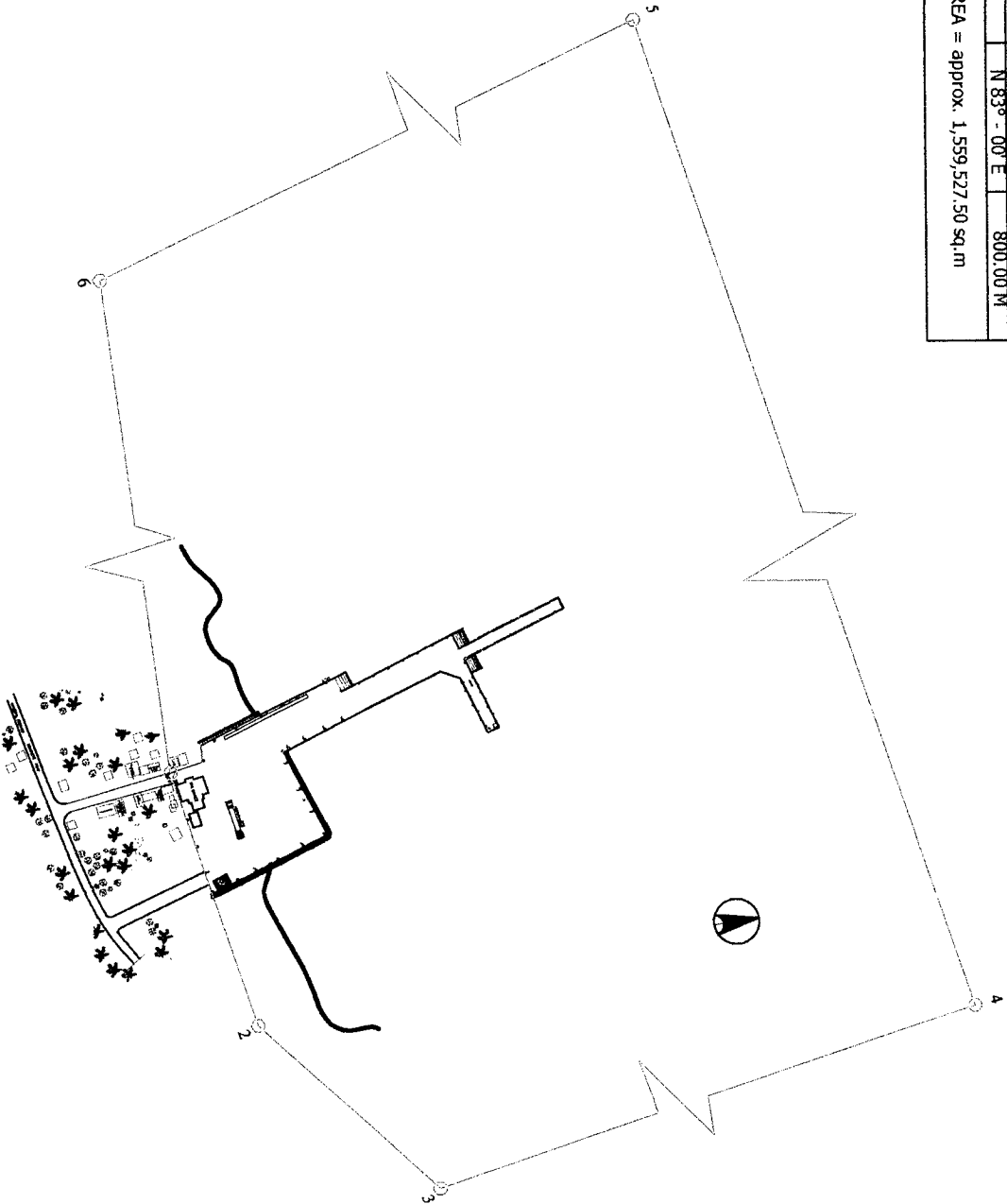

PORT ZONE DELINEATION PLAN

PORT OF ABRA DE ILOG
OCCIDENTAL MINDORO

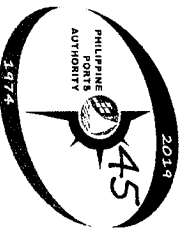

LINE	BEARING	DISTANCE
1 - 2	N 65°31' W	53.76 M
2 - 3	N 54°59' W	70.89 M
3 - 4	N 35°54' W	55.38 M
4 - 5	N 22°49' W	64.44 M
5 - 6	N 49°58' W	35.15 M
6 - 7	N 31°12' W	66.01 M
7 - 8	N 19°17' W	58.22 M
8 - 9	N 07°15' W	106.68 M
9 - 10	N 12°13' E	76.95 M
10 - 11	N 1°11' E	40.89 M
11 - 12	N 73°13' E	20.86 M
12 - 13	N 07°41' E	19.29 M
13 - 14	N 71°04' E	15.14 M
14 - 15	N 34°10' E	28.99 M
15 - 16	N 08°02' E	26.13 M
16 - 17	N 89°14' E	17.31 M
17 - 18	N 17°54' E	13.02 M
18 - 19	N 17°49' W	18.57 M
19 - 20	N 03°55' E	36.15 M
20 - 21	N 16°27' E	41.79 M
21 - 22	N 42°44' W	27.24 M
22 - 23	N 35°19' W	27.14 M
23 - 24	N 27°39' W	115.06 M
24 - 25	N 42°08' W	19.55 M
25 - 26	N 28°27' W	61.71 M
26 - 27	N 34°28' W	126.16 M
27 - 28	N 48°23' W	175.36 M
28 - 29	N 49°24' W	170.35 M
30 - 31	N 48°34' W	54.62 M
31 - 32	N 39°37' W	113.77 M
32 - 33	N 33°37' E	15000 M
33 - 34	S 27°39' E	1553.48 M
34 - 1	S 33°37' W	15000 M
TOTAL AREA =		20,337,876.87 SQ. M.

