

SECTION A - A
SCALE 1 : 50 mtrs.

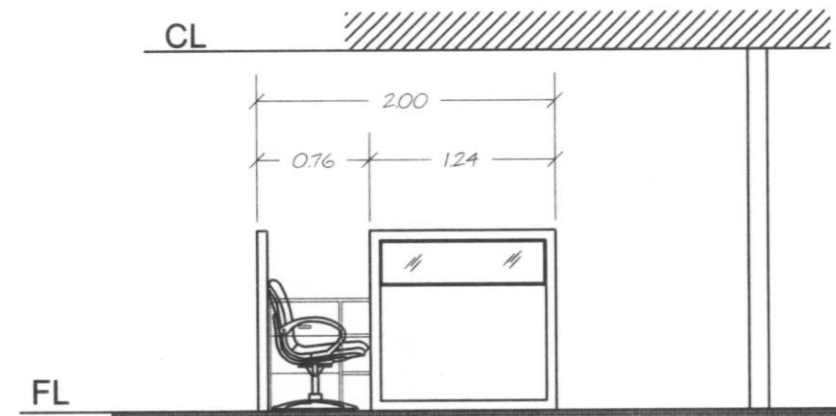

SECTION B - B
SCALE 1 : 50 mtrs.

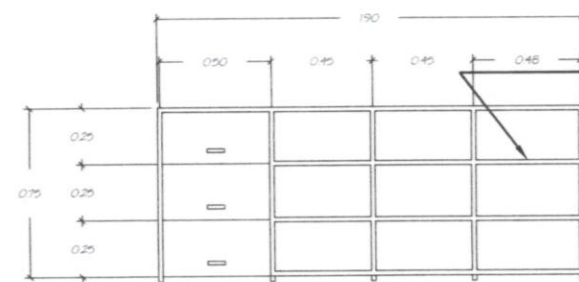

FRONT VIEW (CUBICLE-B)
SCALE 1 : 50 mtrs.

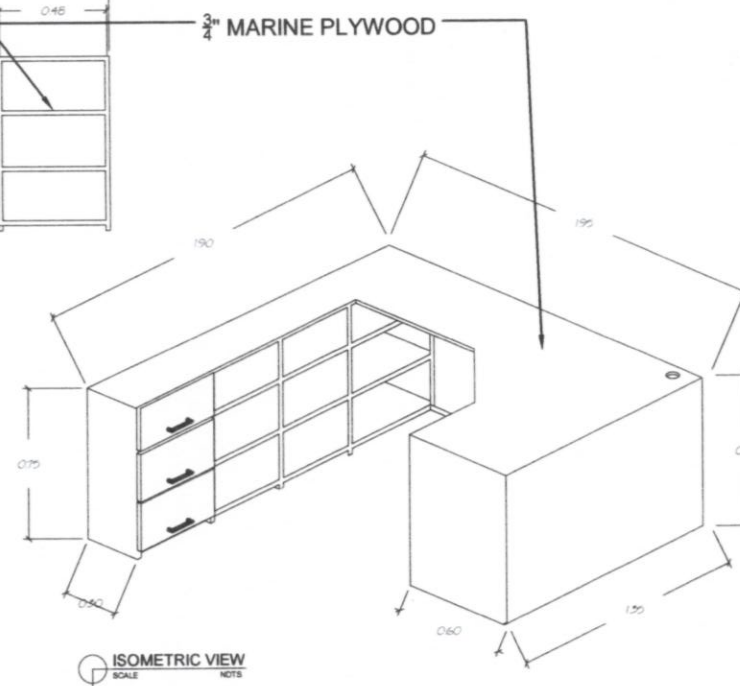

ISOMETRIC VIEW
SCALE 1 : 50 mtrs.



PROJECT TITLE:

REPAIR/EXTENSION OF ESD OFFICE PORT OF DAPITAN, DAPITAN CITY.

SHEET CONTENTS:

SCALE:

AS SHOWN

PREPARED BY:

M. Espina
MOHAMMAD A. ESPINA
ELECTRICIAN FOREMAN-OUTSOURCED

CHECKED BY:

Alleluia W. Mohammad
ALLELUIA W. MOHAMMAD
ENGINEERING ASSISTANT-A

REVIEWED BY:

Engr. Diosdado U. Aramaydo
ENGR. DIOSDADO U. ARANAYDO
PRINCIPAL ENGINEER-A

RECOMMENDING APPROVAL BY:

Engr. Abdurasad S. Hasan
ENGR. ABDURASAD S. HASAN
ESD-MANAGER

APPROVED BY:

Engr. Salvador L. Delina
ENGR. SALVADOR L. DELINA
PORT MANAGER

SHEET NO.:

01-B 09

DATE :

AUGUST 05, 2021