

DEATAIL OF BASE PLATE

Scale: 1:20

INSTALLATION OF TRUSSES TO EXISTING WALL/CONC. COLUMN

Scale: 1:20

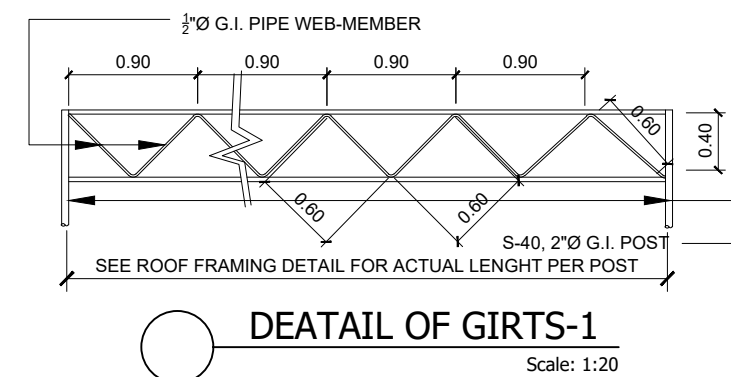
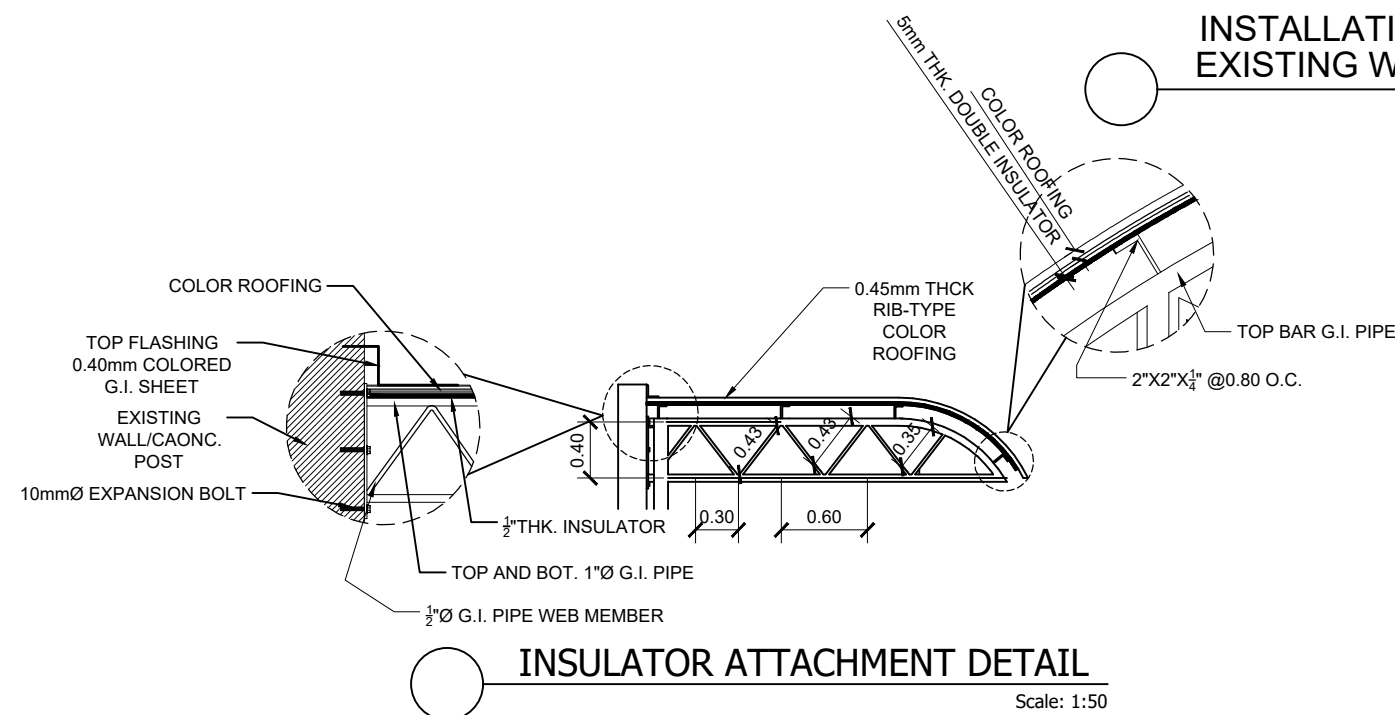

REVISION:										SHEET NO.
NO.	DATE	DESCRIPTION	NAME:	DESIGNATION:	INITIAL:	CHECKED BY:	REVIEWED BY:	RECOMMENDING APPROVAL BY:	APPROVED BY:	
		DESIGNED BY:								04
		CADD BY:	M. ESPINA	ELECTRICIAN FOREMAN(OUTSOURCED)						
		DATE STARTED:								
		DATE FINISHED:								
						ENGR. BRYAN E. BALLON SENIOR ENGINEER - A	ENGR. DIOSDADO U. ARANAYDO PRINCIPAL ENGINEER - A	ENGR. ABDURASAD S. HASAN ESD-MANAGER	ENGR. SUBANRIO I. LIM PORT MANAGER	

REPAIR/RENOVATION AND REPAINTING OF CANOPY, Port of Dapitan, Dapitan City, Zamboanga Del Norte