

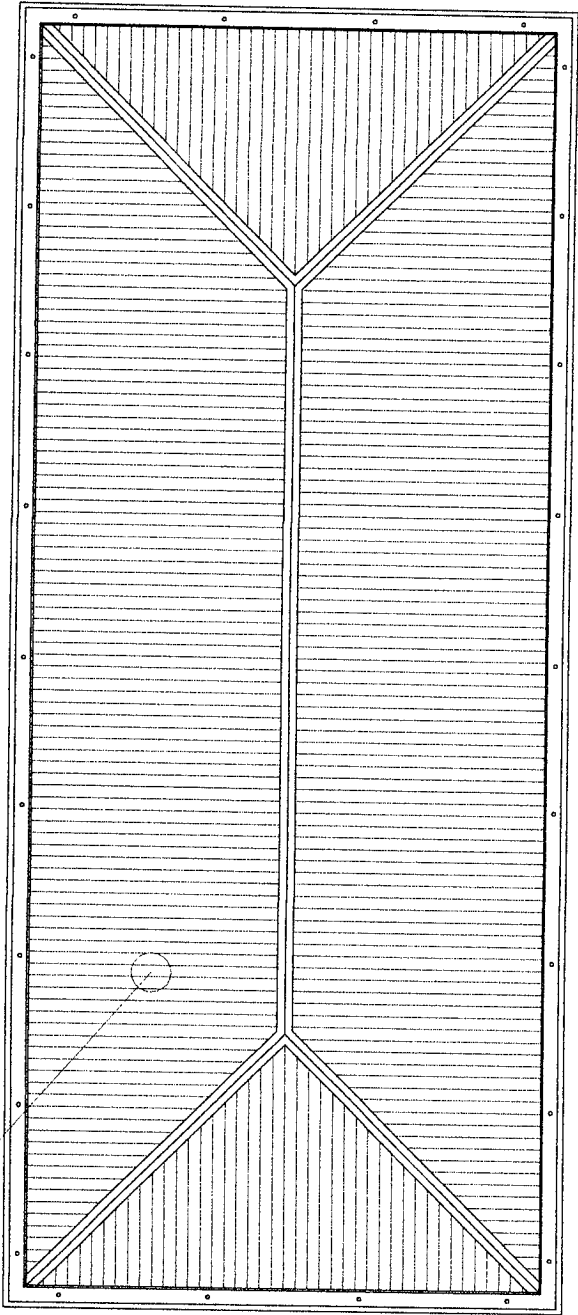

REPAIR OF TMO / PTB ROOF  
AND OUTER CEILING  
PORT OF ROXAS, ORIENTAL MINDORO





ROOF PLAN

SCALE 1 : 200 MTS.

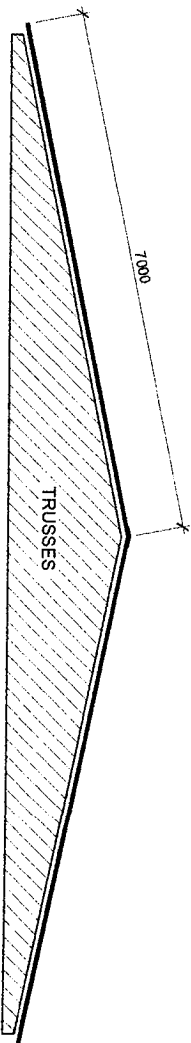

ROOF SECTION DETAIL

EXISTING ROOF TO BE REMOVED & REPLACED  
WITH 0.5mm THK. PRE PAINTED RIB TYPE ROOFING  
NOTE: INCLUDING REPAINTING OF ROOF FRAMING

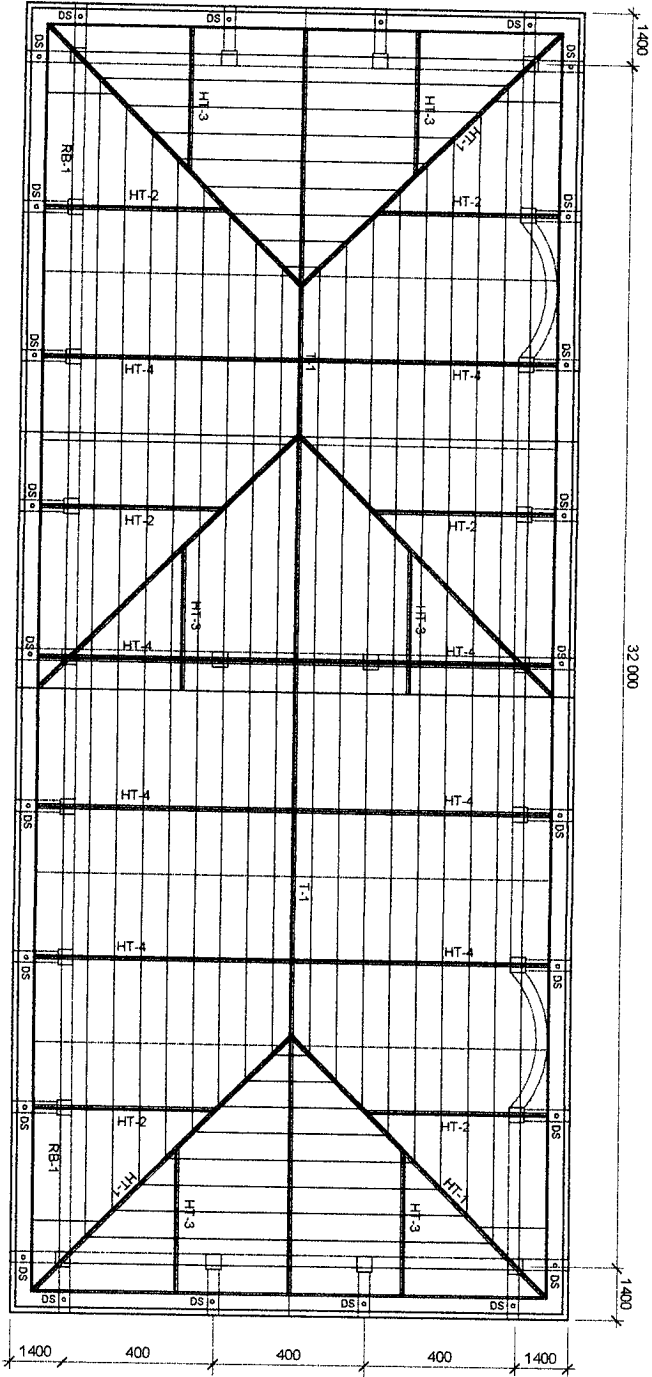

ROOF FRAMING PLAN

SCALE 1 : 200 MTS.

PROJECT TITLE:

REPAIR OF TMO / PTB ROOF AND OUTER CEILING  
PORT OF ROXAS, ORIENTAL MINDORO

PREPARED BY:

FERNANDO J. GALVEZO  
Engineering Assistant A

SUBMITTED BY:

JESSIE J. MERILLO  
Office Engineer

CHECKED / REVIEWED BY:

RONALDO O. MABAG  
Acting Principal Engineer A

RECOMMENDING APPROVAL:

MARGARITO P. DIMALLIG  
Acting Division Manager A, ESD

APPROVED:

ELVIS R. MEDALLA  
Port Manager A

SHEET CONTENTS:

AS SHOWN

SCALE:  
AS SHOWN

SHEET NO.

2 of 3

DATE:  
09 JUNE 2020

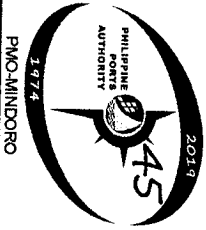

PMA-MINDORO

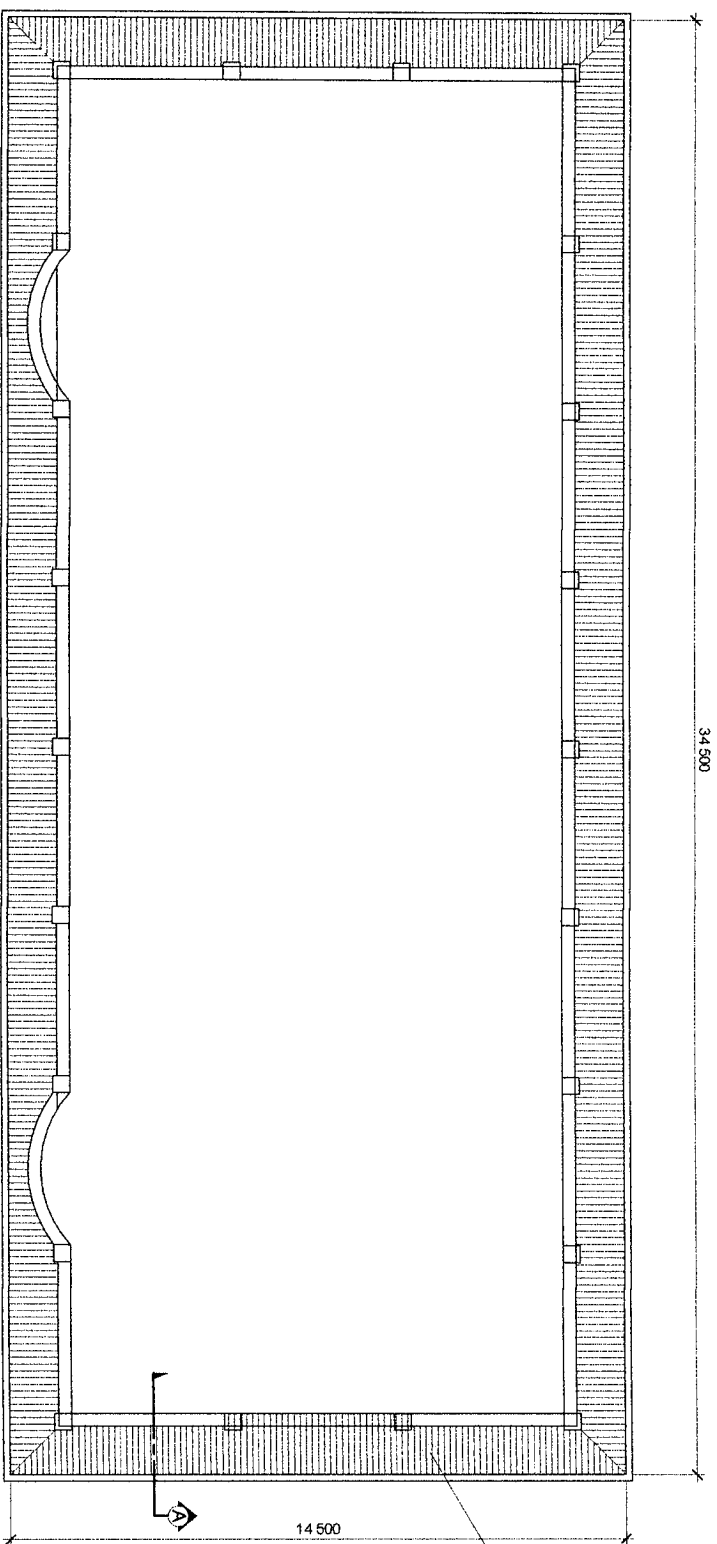

OUTER CEILING TO BE REPAIRED  
NOTE: Existing spandrel ceiling to be removed & replaced with 0.5mm thk. X 150mm metal spandrel ceiling  
Existing wooden ceiling joist will be removed & replaced with metal furring ceiling joist

CEILING PLAN  
SCALE 1 : 50 MTS.

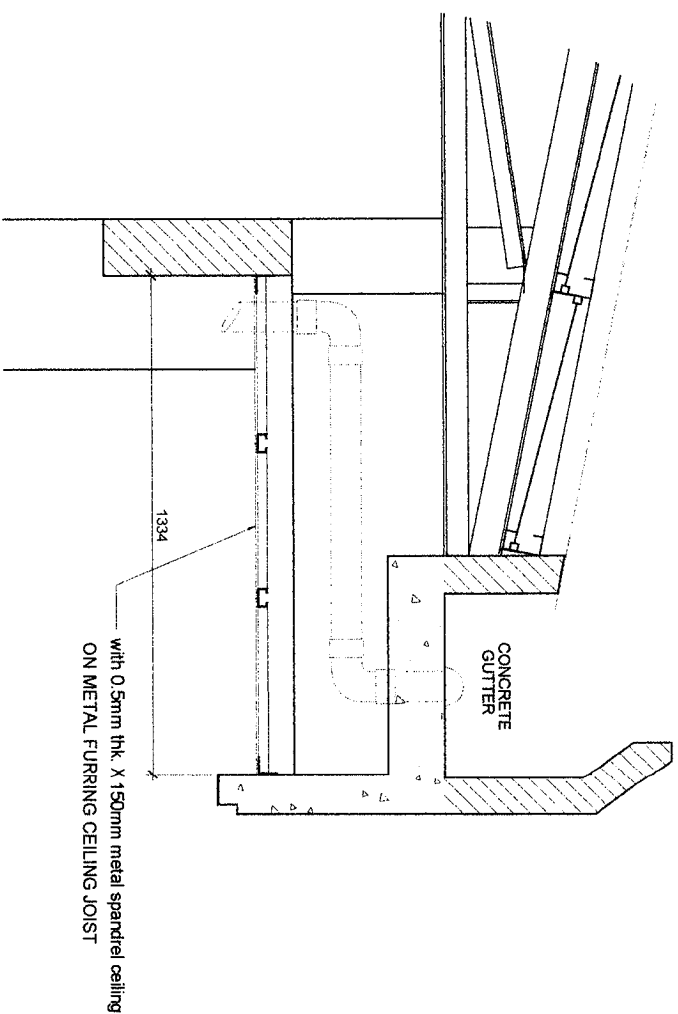

SECTION THRU "A"

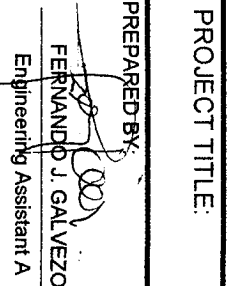
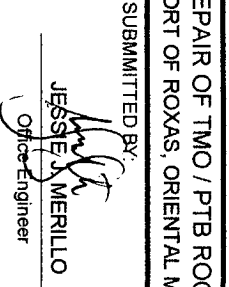
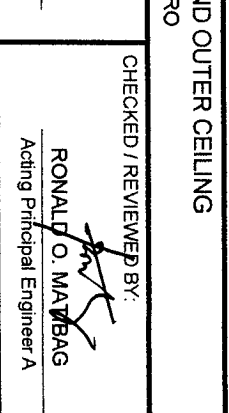
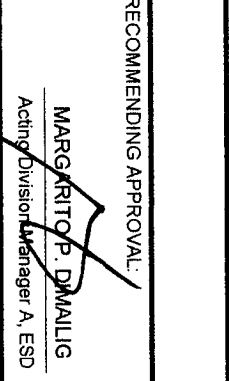
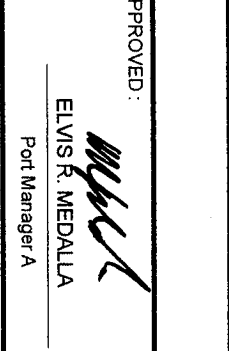
		PROJECT TITLE: REPAIR OF TMO / PTB ROOF AND OUTER CEILING PORT OF ROXAS, ORIENTAL MINDORO		SHEET CONTENTS: AS SHOWN		SCALE: AS SHOWN					
PREPARED BY:  FERNANDO J. GALVEZO Engineering Assistant A		SUBMITTED BY:  JESSE J. MERILLO Office Engineer		CHECKED / REVIEWED BY:  RONALD O. MAYBAG Acting Principal Engineer A		RECOMMENDING APPROVAL:  MARGARITO P. DIMALIG Acting Division Manager A, ESD		APPROVED:  ELVIS R. MEDALLA Port Manager A		DATE: 09 JUNE 2020	