



REPAINTING OF COVERED WALK  
AND REPAIR OF LIGHTS AND ELECTRICAL FIXTURES  
PORT OF CALAPAN, ORIENTAL MINDORO

6-1

COVERED WALK  
@ FINGER PIER-2 TO BE REPAIRED  
SEE DETAIL

COVERED WALK  
@ FINGER PIER-1 TO BE REPAIRED  
SEE DETAIL

COVERED WALK-1  
COVERED WALK-2  
COVERED WALK-3  
TO BE REPAIRED  
SEE DETAIL

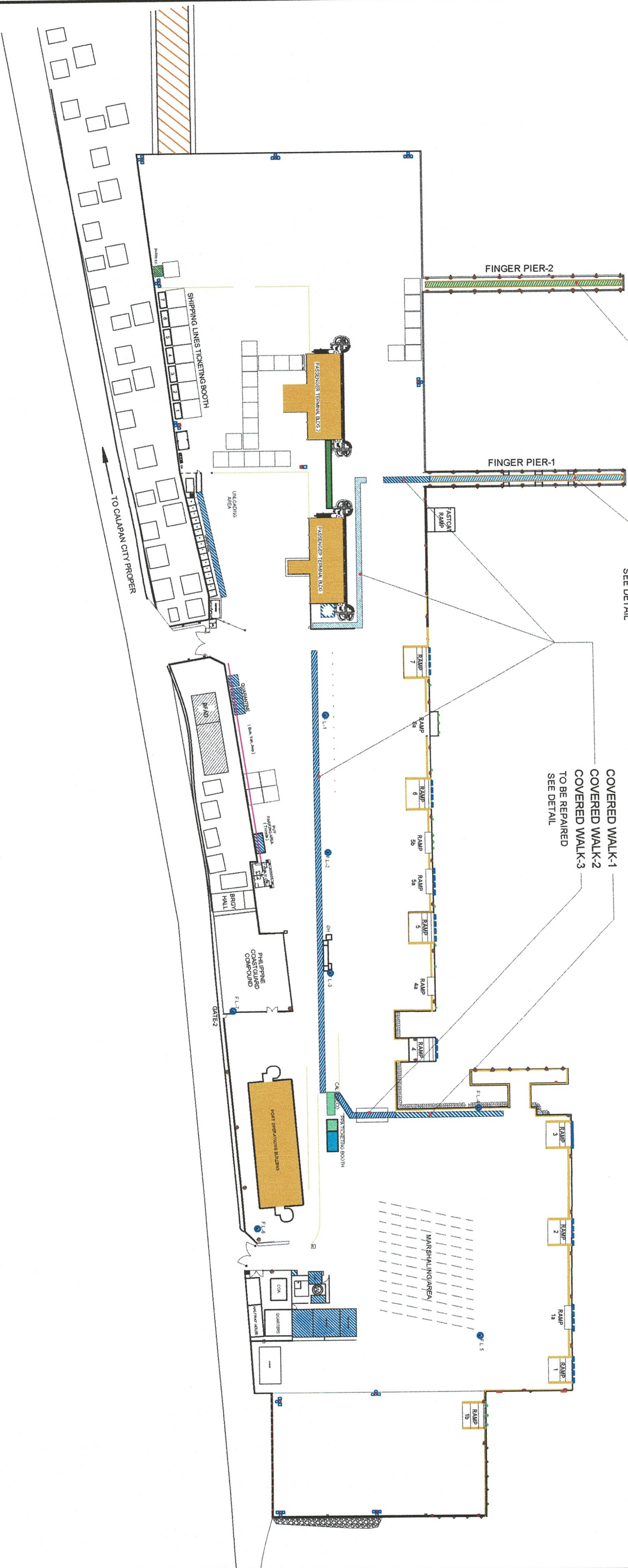

# PORT LAYOUT PLAN PORT OF CALAPAN ORIENTAL MINDORO



PROJECT TITLE: REPAINTING OF COVERED WALK AND REPAIR OF LIGHTS AND ELECTRICAL FIXTURES  
PORT OF CALAPAN, ORIENTAL MINDORO

SHEET CONTENTS: AS SHOWN

SCALE: AS SHOWN

AS SHOWN

SHEET NO. 1 of 9

DATE: 17 JULY 2020

APPROVED: ELVIS R. MEDALLA  
Port Manager A

RECOMMENDING APPROVAL: MARGARITO F. DIMALLIG  
Acting Division Manager A, ESD

CHECKED / REVIEWED BY: RONALD O. MAYBAG  
Acting Principal Engineer A

SUBMITTED BY: EMERSON D. QUIAMBAO  
Assistant Port Engineer

PREPARED BY: FERNANDO J. GALVEZO  
Engineering Assistant A





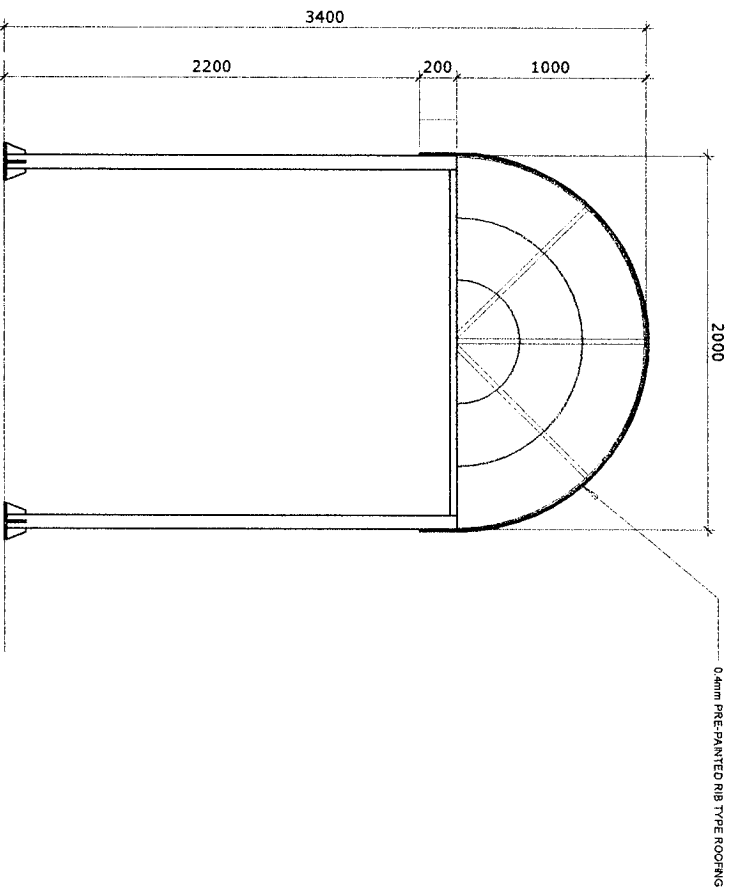
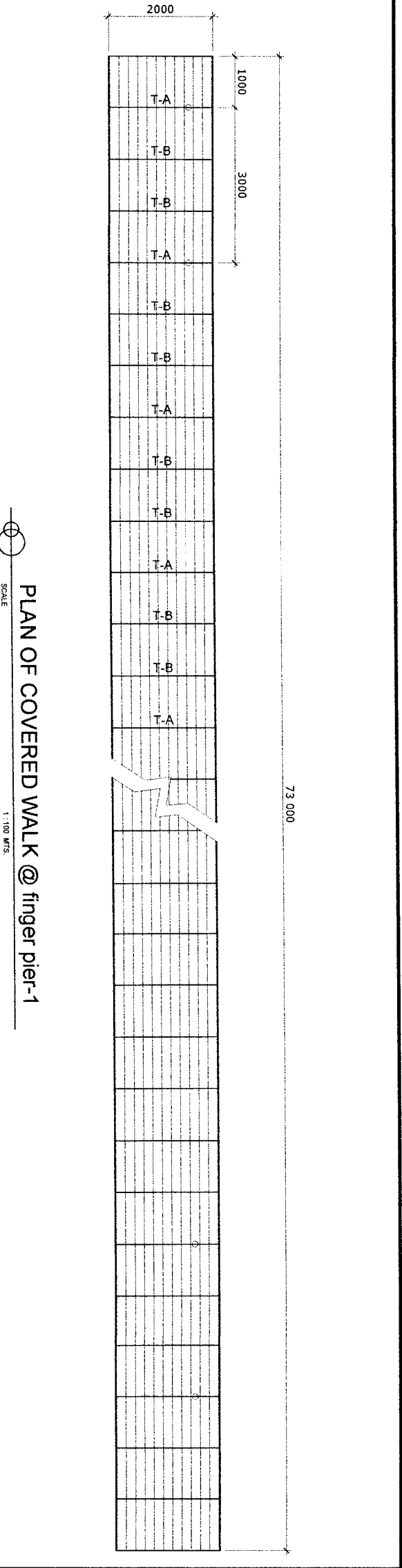
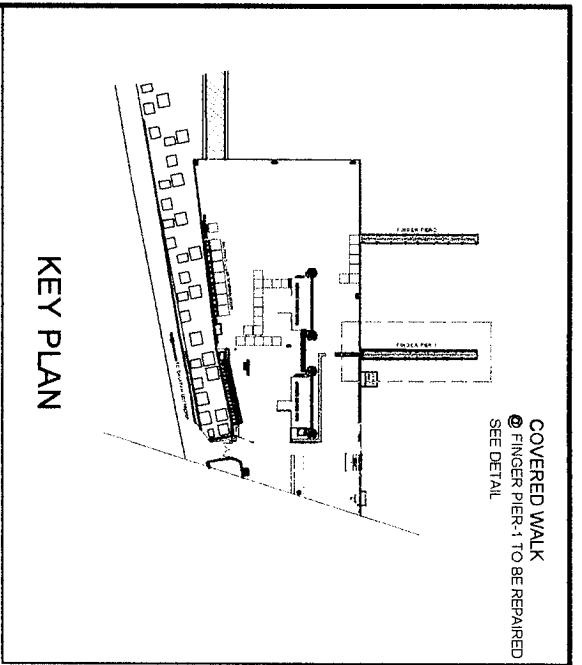



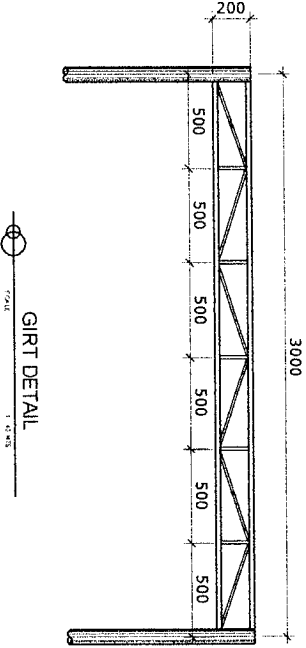
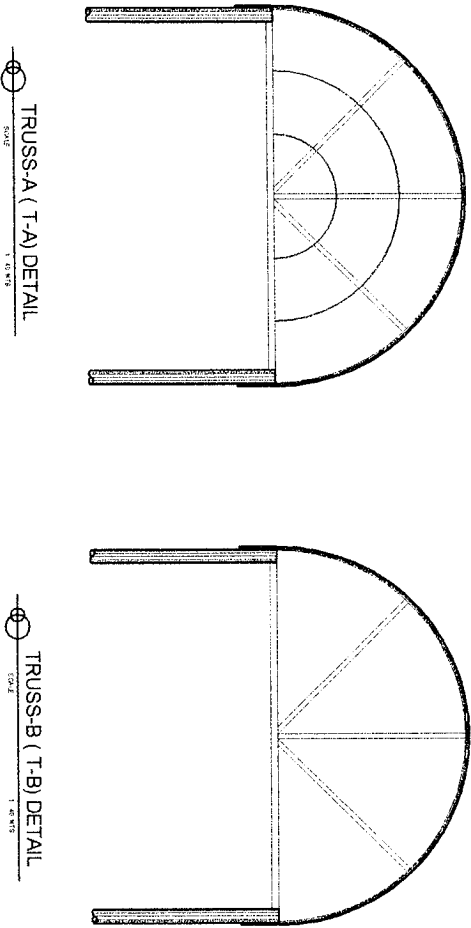

NOTE:  
FOR REPAINTING OF POST, GIRT, TRUSSES, & PURLINS  
PRIMER --- EPOXY PRIMER  
TOP COAT --- EPOXY / AUTOMOTIVE PAINT ( 2 coats )

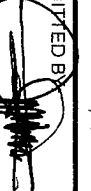

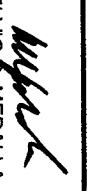
 PMO-MINDORO		PROJECT TITLE: REPAINTING OF COVERED WALK AND REPAIR OF LIGHTS AND ELECTRICAL FIXTURES PORT OF CALAPAN, ORIENTAL MINDORO		SHEET CONTENTS: AS SHOWN		SCALE: AS SHOWN	
PREPARED BY:  FERNANDO J. GALVEZO Engineering Assistant A	SUBMITTED BY:  EMERSON D. QUIAMBAO Assistant Port Engineer	CHECKED / REVIEWED BY:  RONALD O. MATBAG Acting Principal Engineer A	RECOMMENDING APPROVAL:  MARGARITO P. JIMALING Acting Division Manager A, ESD	APPROVED:  ELVIS R. MEDALLA Port Manager A	DATE: 17 JULY 2020		

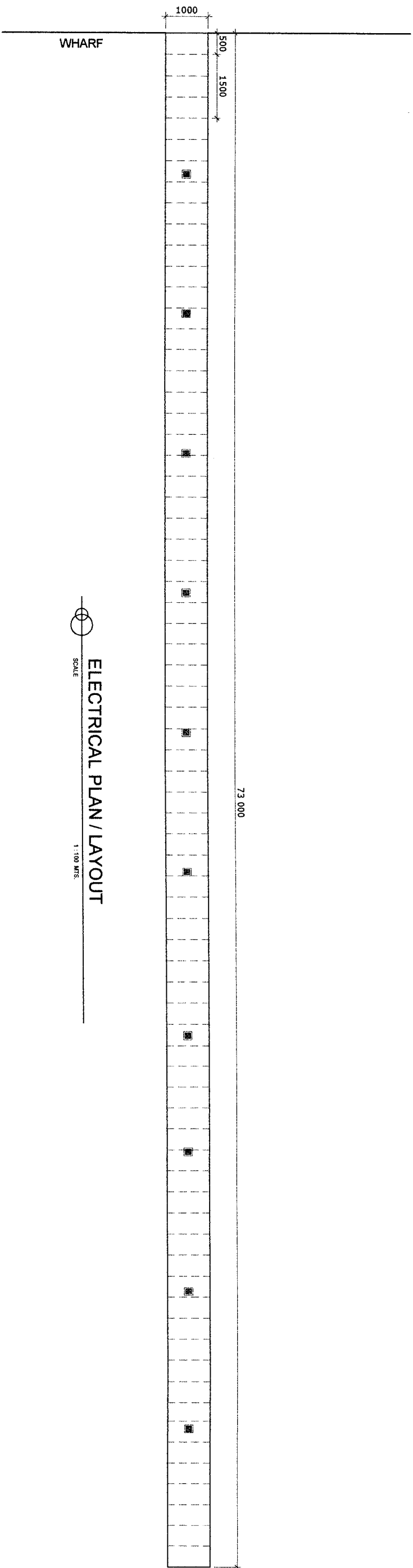

ELECTRICAL PLAN / LAYOUT

LEGEND:

- 10 W LED OUTDOOR FLOODLIGHTS
- PANEL BOARD
- NOTE: Outdoor Panel Board (Weatherproof)

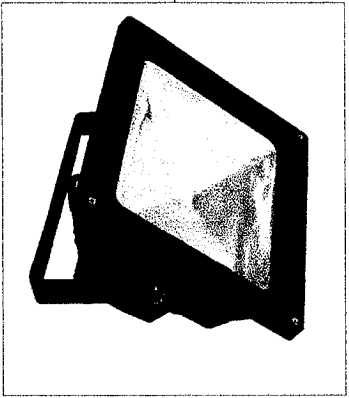

10 SETS

NOTE: TO BE TAPPED / INSTALLED AT  
EXISTING ELECTRICAL LINES  
DAMAGED JUNCTION BOXES AND ELECT'L  
CONDUIT WILL BE REMOVED & REPLACED

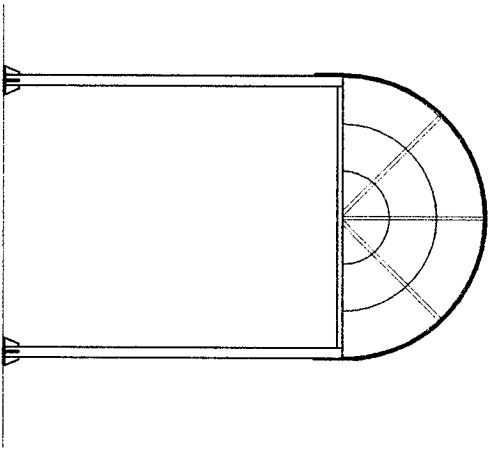

ELEVATION

PROJECT TITLE: REPAINTING OF COVERED WALK AND REPAIR OF LIGHTS AND ELECTRICAL FIXTURES		SHEET CONTENTS: AS SHOWN		SCALE: AS SHOWN	
PORT OF CALAPAN, ORIENTAL MINDORO		AS SHOWN		SHEET NO. 3 of 9	
PREPARED BY: FERNANDO J. GALVEZO Engineering Assistant A		SUBMITTED BY: EMERSON D. QUIAMBAO Assistant Port Engineer		CHECKED / REVIEWED BY: RONALD O. MATIBAG Acting Principal Engineer A	
PNO-MINDORO		RECOMMENDING APPROVAL: MARGARITO P. DIMAILIG Acting Division Manager A, ESD		APPROVED: ELVIS R. MEDALLA Port Manager A	
				DATE: 17 JULY 2020	

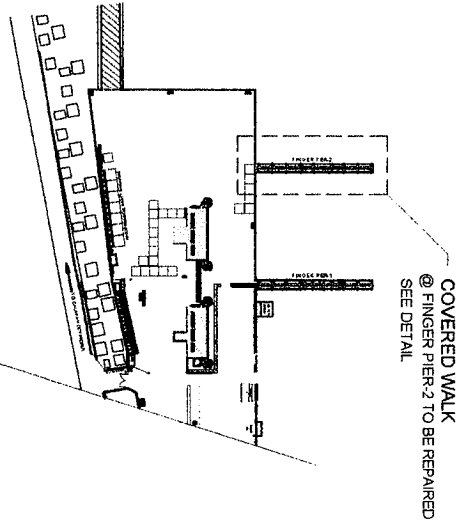

KEY PLAN

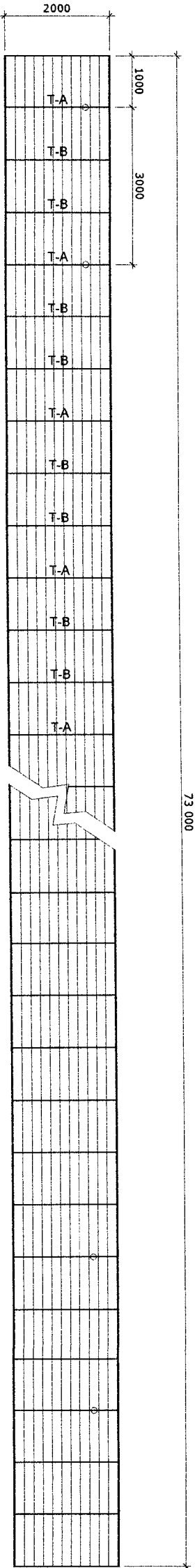

PLAN OF COVERED WALK @ finger pier- 2

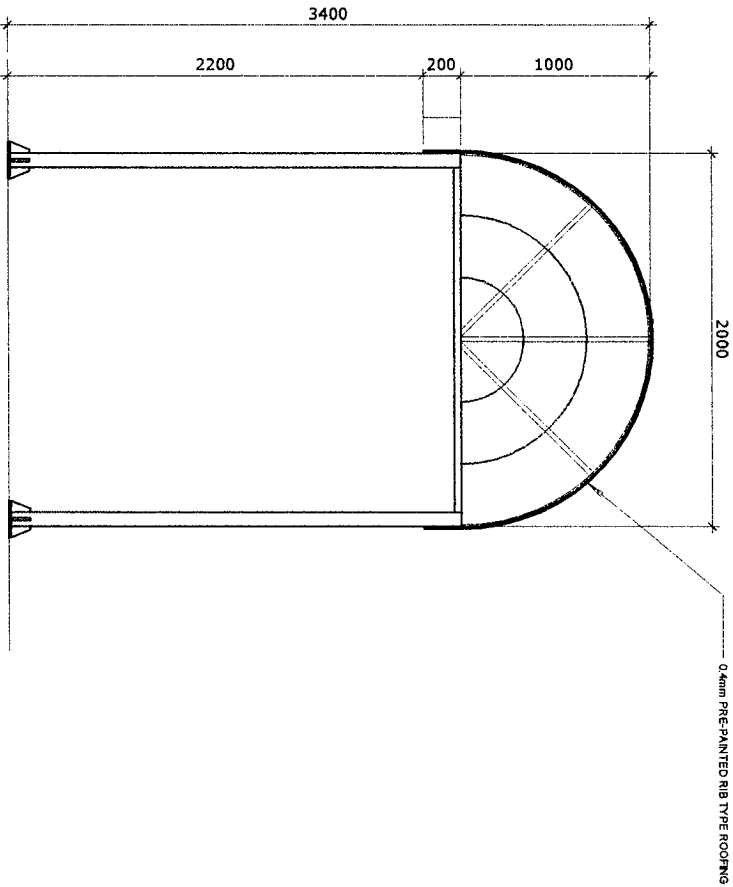

ELEVATION

NOTE:  
FOR REPAINTING OF POST, GIRT, TRUSSES, & PURLINS  
PRIMER --- EPOXY PRIMER  
TOP COAT --- EPOXY / AUTOMOTIVE PAINT ( 2 coats )

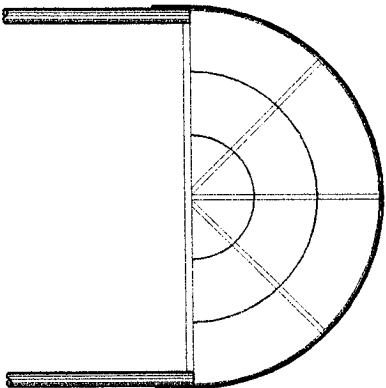

TRUSS-A ( T-A ) DETAIL

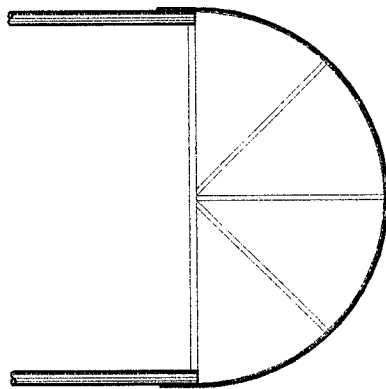

TRUSS-B ( T-B ) DETAIL

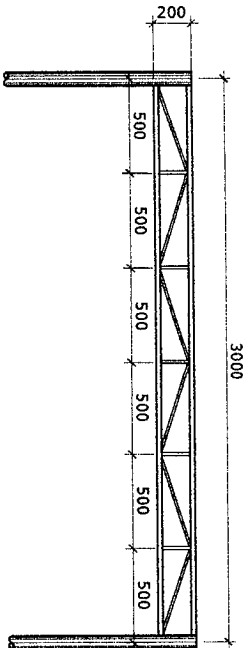

GIRT DETAIL

PROJECT TITLE:

REPAINTING OF COVERED WALK AND REPAIR OF LIGHTS AND ELECTRICAL FIXTURES  
PORT OF CALAPAN, ORIENTAL MINDORO

SHEET CONTENTS:

AS SHOWN

SCALE:  
AS SHOWN

PREPARED BY:

FERNANDO J. GALVEZO  
Engineering Assistant A

SUBMITTED BY:

EMERSON D. BUJAMBAO  
Assistant Port Engineer

CHECKED / REVIEWED BY:

RONALDO O. MABAG  
Acting Principal Engineer A

RECOMMENDING APPROVAL:

MARGARITO P. DIMAYILI  
Acting Division Manager A, ESD

APPROVED:

ELVIS R. MEDALLA  
Port Manager A



PMO-MINDORO

SHEET NO.  
4 of 9

DATE:  
17 JULY 2020

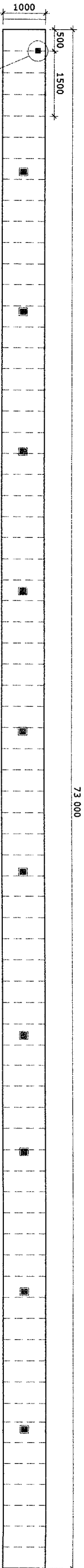

CIRCUIT BREAKER NO. 1  
LOCATION OF SWITCH / CIRCUIT BREAKER ( Weatherproof / for Outdoor with cover )

ELECTRICAL PLAN / LAYOUT  
SCALE 1:100 MTS

LEGEND:

- 10 WLED OUTDOOR FLOODLIGHTS
- PANEL BOARD  
PB NOTE: Outdoor Panel Board ( Weatherproof )

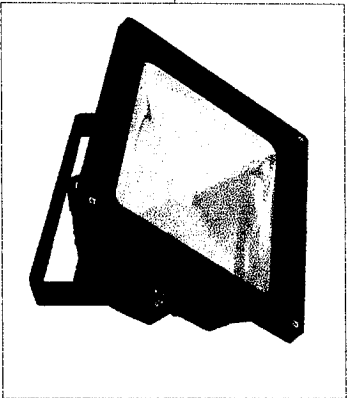

10 SETS

NOTE: TO BE TAPPED / INSTALLED AT  
EXISTING ELECTRICAL LINES  
DAMAGED JUNCTION BOXES AND ELECT'L  
CONDUIT WILL BE REMOVED & REPLACED

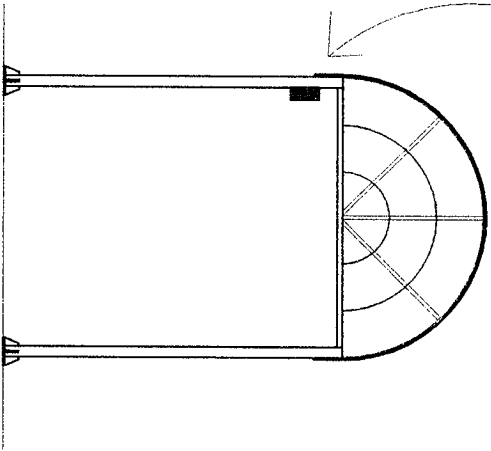

ELEVATION  
SCALE 1:40 MTS

PROJECT TITLE: REPAINTING OF COVERED WALK AND REPAIR OF LIGHTS AND ELECTRICAL FIXTURES PORT OF CALAPAN, ORIENTAL MINDORO		SHEET CONTENTS: AS SHOWN		SCALE: AS SHOWN	
PREPARED BY: FERNANDO J. GALVEZO Engineering Assistant A	SUBMITTED BY: EMERSON D. QUIAMBAO Assistant Port Engineer	CHECKED / REVIEWED BY: RONALDO O. MABAG Acting Principal Engineer A	RECOMMENDING APPROVAL: MARGARITO P. DIMALIG Acting Division Manager A, ESD	APPROVED: ELVIS R. MEDALLA Port Manager A	SHEET NO. 5 of 9 DATE: 17 JULY 2020
PMO-MINDORO					

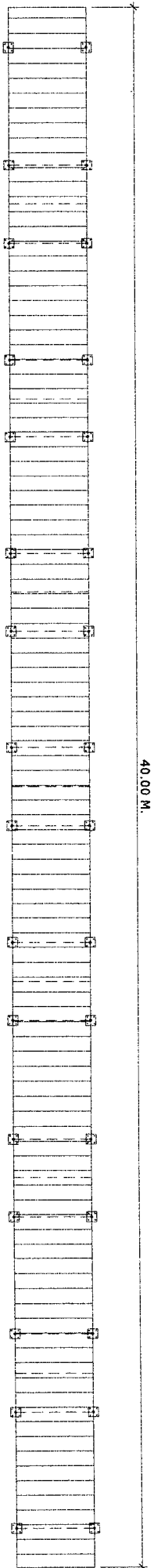

ROOF PLAN

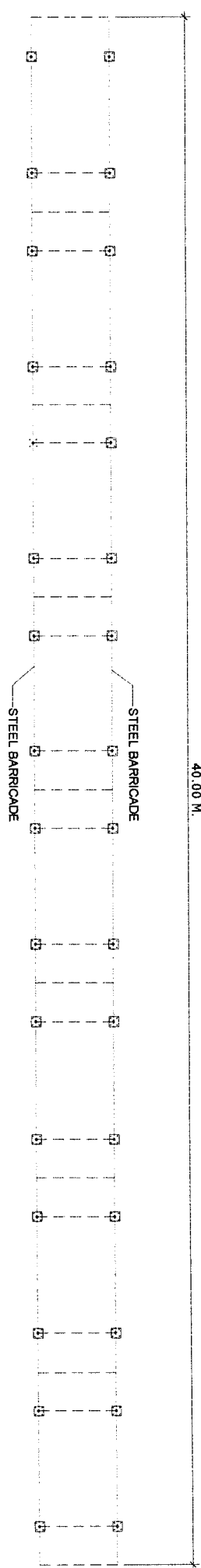

PLAN OF COVERED WALK-1 TO BE REPAIRED / REPAINTED

SCALE 1 : 75 MTS.

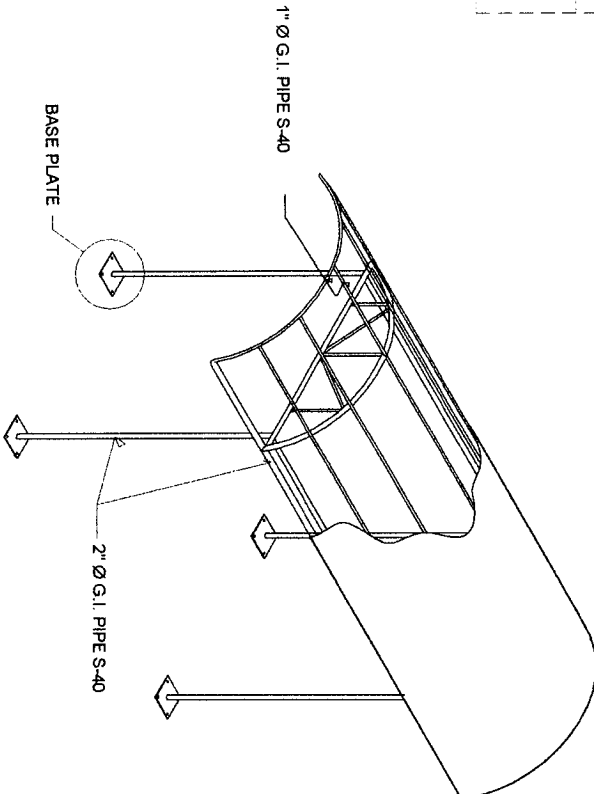

ISOMETRIC VIEW ( per 5.00 m. span )

SCALE 1 : 50 MTS.

NOTE:  
FOR REPAINTING OF BARRICADE, POST, GIRT, TRUSSES, & PURLINS  
PRIMER COATING --- EPOXY PRIMER  
TOP COATING --- EPOXY / AUTOMOTIVE PAINT ( 2 coats )  
  
FOR ELECTRICAL WORKS  
ALL BUSTED BULB WILL BE REPLACED INCLUDING  
DAMAGED JUNCTION BOXES AND ELECTRICAL CONDUIT

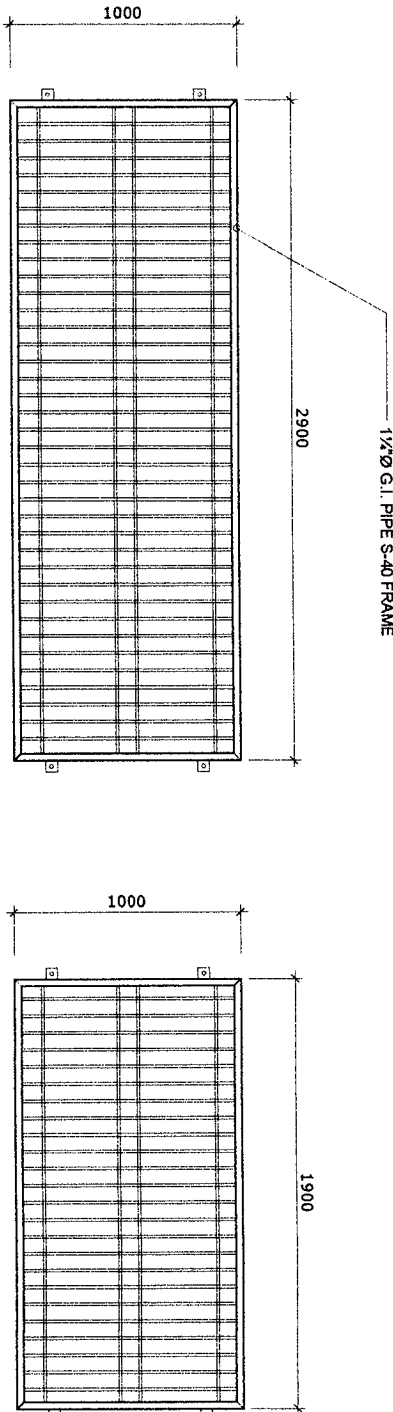

BARRICADE-1

SCALE 1 : 25 MTS.

BARRICADE-2

SCALE 1 : 25 MTS.

	PROJECT TITLE:		REPAIRING OF COVERED WALK AND REPAIR OF LIGHTS AND ELECTRICAL FIXTURES			SHEET CONTENTS:		SCALE:	
	PORT OF CALAPAN, ORIENTAL MINDORO					AS SHOWN		AS SHOWN	
PREPARED BY:	SUBMITTED BY:	CHECKED / REVIEWED BY:	RECOMMENDING APPROVAL:	APPROVED:			SHEET NO.		DATE:
FERNANDO J. GALVEZO Engineering Assistant A	EMERSON D. QUJAMBABO Assistant Port Engineer	RONALD O. MATIBAG Acting Principal Engineer A	MARGARITO P. DIMAALIG Acting Division Manager A, ESD	ELVIS R. MEDALLA Port Manager A			6 of 9		17 JULY 2020

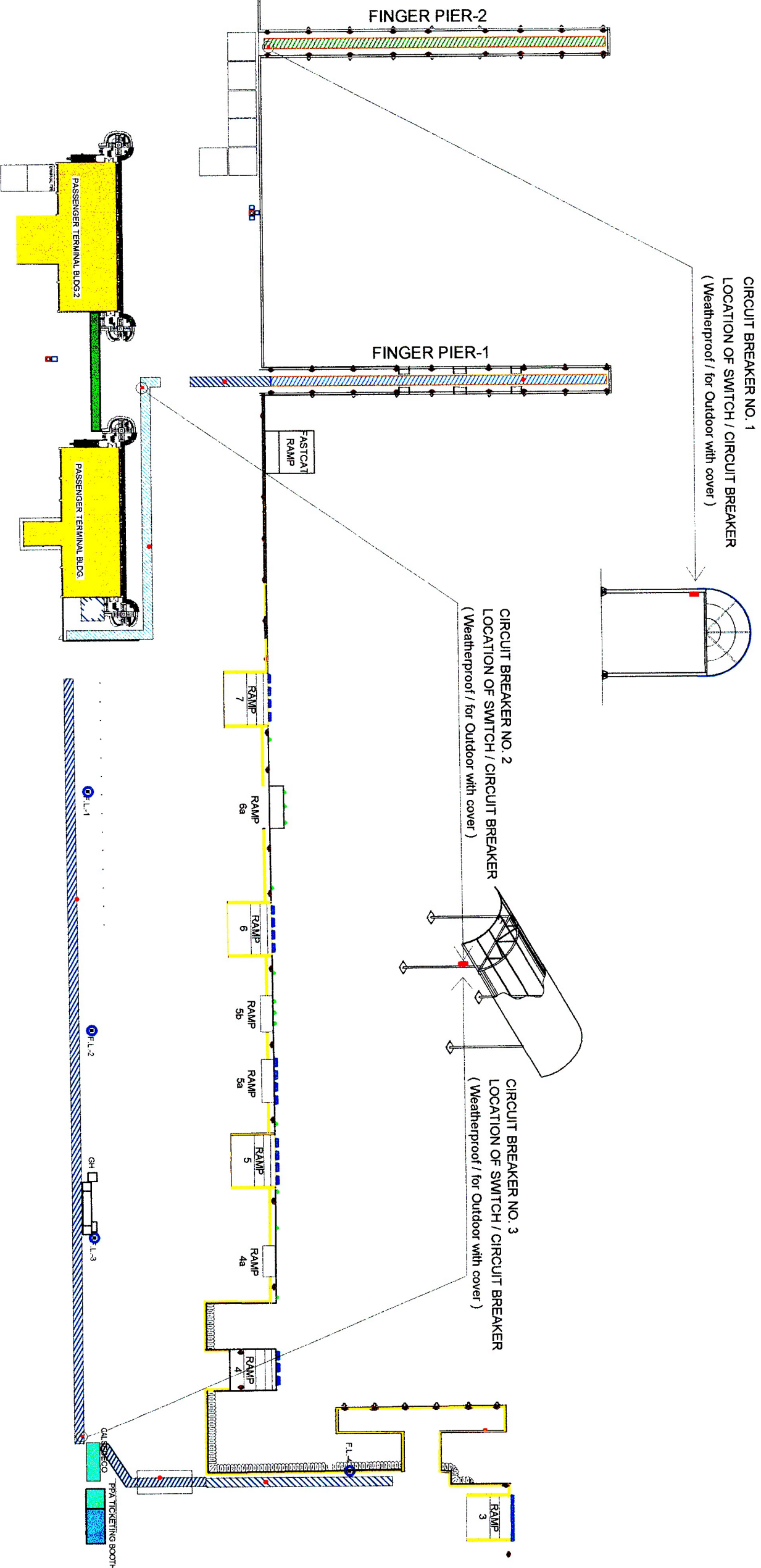

LOCATION OF SWITCH / CIRCUIT BREAKER FOR COVERED WALK

PROJECT TITLE:	REPAINTING OF COVERED WALK AND REPAIR OF LIGHTS AND ELECTRICAL FIXTURES	SHEET CONTENTS:	SCALE:
	PORT OF CALAPAN, ORIENTAL MINDORO	AS SHOWN	AS SHOWN

PREPARED BY:	SUBMITTED BY:	CHECKED / REVIEWED BY:	RECOMMENDING APPROVAL:	APPROVED:		
FERNANDO J. GALVEZO Engineering Assistant A	EMERSON D. DIAMBAO Assistant Port Engineer	RONALD O. MATIBAG Acting Principal Engineer A	MARGARITO P. DIMALIG Acting Division Manager A, ESD	ELVIS R. MEDALLA Port Manager A		



PMO-MINDORO

SHEET NO.	DATE:
9 of 9	17 JULY 2020