

BILL OF QUANTITIES

Conduct of Soil Investigation/Exploration (Package 8)

Dapitan City Zamboanga del Norte

NO. (1)	DESCRIPTION OF WORK (2)	UNIT (3)	QTY. (4)	UNIT PRICE (Pesos) (5)	AMOUNT (Pesos) (4) x (5)
L NO. 3	LABORATORY TEST				
3.01	Visual Classification	test	100		
3.02	Moisture Content	test	100		
3.03	Grain Size analysis	test	100		
3.04	Atterberg Units	test	100		
3.05	Organic Content	test	100		
3.06	Specific Gravity	test	90		
3.07	Unit Weight	test	100		
3.08	Unconfined Compression	test	100		
3.09	Consolidation	test	15		
TOTAL FOR BILL NO. 3					

BILL OF QUANTITIES

Conduct of Soil Investigation/Exploration (Package 8)

Dapitan City Zamboanga del Norte

NO. (1)	DESCRIPTION OF WORK (2)	UNIT (3)	QTY. (4)	UNIT PRICE (Pesos) (5)	AMOUNT (Pesos) (4) x (5)
I. NO. 4	TECHNICAL EVALUATION REPORT				
4.01	Technical Evaluation Report	Lump sum	1		
TOTAL FOR BILL NO. 4					

BILL OF QUANTITIES

Conduct of Soil Investigation/Exploration (Package 8)

Sindangan Zamboanga del Norte

NO. (1)	DESCRIPTION OF WORK (2)	UNIT (3)	QTY. (4)	UNIT PRICE (Pesos) (5)	AMOUNT (Pesos) (4) x (5)
L NO. 1	MOBILIZATION AND DEMOBILIZATION				
1.01	Mobilization, demobilization	Lump Sum	1		
TOTAL FOR BILL NO. 1					

BILL OF QUANTITIES
Conduct of Soil Investigation/Exploration (Package 8)
Sindangan Zamboanga del Norte

NO. (1)	DESCRIPTION OF WORK (2)	UNIT (3)	QTY. (4)	UNIT PRICE (Pesos) (5)	AMOUNT (Pesos) (4) x (5)
I. NO. 2	FIELD WORK				
	OFFSHORE BOREHOLE (3 BH @ 50m)				
2.01	Fabrication and drilling platform	lump sum	1		
2.02	Hole to hole transfer and setting-up including staking of borehole locations	holes	3		
2.03	Drilling on ordinary soils	meter	90		
2.04	Coring of rocks/gravel	meter	10		
2.05	SPT at 1.5m interval	test	90		
2.06	Undisturbed sampling (UDS)	sample	10		
2.07	Safety gears/equipment	set	1		
	INLAND BOREHOLE (BH @ 50m)				
2.08	Hole to hole transfer and setting-up including staking of borehole locations	holes			
2.09	Drilling on ordinary soils	meter			
2.10	Coring of rocks/gravel	meter			
2.11	SPT at 1.5m interval	test			
2.12	Undisturbed sampling (UDS)	sample			
TOTAL FOR BILL NO. 2					

BILL OF QUANTITIES

Conduct of Soil Investigation/Exploration (Package 8)
Sindangan Zamboanga del Norte

NO. (1)	DESCRIPTION OF WORK (2)	UNIT (3)	QTY. (4)	UNIT PRICE (Pesos) (5)	AMOUNT (Pesos) (4) x (5)
1. NO. 3	LABORATORY TEST				
3.01	Visual Classification	test	100		
3.02	Moisture Content	test	100		
3.03	Grain Size analysis	test	100		
3.04	Atterberg Units	test	100		
3.05	Organic Content	test	100		
3.06	Specific Gravity	test	90		
3.07	Unit Weight	test	100		
3.08	Unconfined Compression	test	100		
3.09	Consolidation	test	15		
TOTAL FOR BILL NO. 3					

BILL OF QUANTITIES

Conduct of Soil Investigation/Exploration (Package 8)
Sindangan Zamboanga del Norte

NO. (1)	DESCRIPTION OF WORK (2)	UNIT (3)	QTY. (4)	UNIT PRICE (Pesos) (5)	AMOUNT (Pesos) (4) x (5)
I.L NO. 4	TECHNICAL EVALUATION REPORT				
4.01	Technical Evaluation Report	Lump sum	1		
TOTAL FOR BILL NO. 4					

BILL OF QUANTITIES

Conduct of Soil Investigation/Exploration (Package 8)

Lamao (Liloy) Zamboanga del Norte

NO. (1)	DESCRIPTION OF WORK (2)	UNIT (3)	QTY. (4)	UNIT PRICE (Pesos) (5)	AMOUNT (Pesos) (4) x (5)
LL NO. 1	MOBILIZATION AND DEMOBILIZATION				
1.01	Mobilization, demobilization	Lump Sum	1		
TOTAL FOR BILL NO. 1					

BILL OF QUANTITIES

Conduct of Soil Investigation/Exploration (Package 8)

Lamao (Liloy) Zamboanga del Norte

NO. (1)	DESCRIPTION OF WORK (2)	UNIT (3)	QTY. (4)	UNIT PRICE (Pesos) (5)	AMOUNT (Pesos) (4) x (5)
LL NO. 2	FIELD WORK				
	OFFSHORE BOREHOLE (3 BH @ 50m)				
2.01	Fabrication and drilling platform	lump sum	1		
2.02	Hole to hole transfer and setting-up including staking of borehole locations	holes	3		
2.03	Drilling on ordinary soils	meter	90		
2.04	Coring of rocks/gravel	meter	10		
2.05	SPT at 1.5m interval	test	90		
2.06	Undisturbed sampling (UDS)	sample	10		
2.07	Safety gears/equipment	set	1		
	INLAND BOREHOLE (BH @ 50m)				
2.08	Hole to hole transfer and setting-up including staking of borehole locations	holes			
2.09	Drilling on ordinary soils	meter			
2.10	Coring of rocks/gravel	meter			
2.11	SPT at 1.5m interval	test			
2.12	Undisturbed sampling (UDS)	sample			
TOTAL FOR BILL NO. 2					

BILL OF QUANTITIES
Conduct of Soil Investigation/Exploration (Package 8)
Lamiao (Liloy) Zamboanga del Norte

NO. (1)	DESCRIPTION OF WORK (2)	UNIT (3)	QTY. (4)	UNIT PRICE (Pesos) (5)	AMOUNT (Pesos) (4) x (5)
1. NO. 3	LABORATORY TEST				
3.01	Visual Classification	test	100		
3.02	Moisture Content	test	100		
3.03	Grain Size analysis	test	100		
3.04	Atterberg Units	test	100		
3.05	Organic Content	test	100		
3.06	Specific Gravity	test	90		
3.07	Unit Weight	test	100		
3.08	Unconfined Compression	test	100		
3.09	Consolidation	test	15		
TOTAL FOR BILL NO. 3					

BILL OF QUANTITIES

Conduct of Soil Investigation/Exploration (Package 8)
Lamao (Liloy) Zamboanga del Norte

NO. (1)	DESCRIPTION OF WORK (2)	UNIT (3)	QTY. (4)	UNIT PRICE (Pesos) (5)	AMOUNT (Pesos) (4) x (5)
I. NO. 4	TECHNICAL EVALUATION REPORT				
4.01	Technical Evaluation Report	Lump sum	1		
TOTAL FOR BILL NO. 4					

BILL OF QUANTITIES

Conduct of Soil Investigation/Exploration (Package 8)

Doña Helene, Socorro Surigao Del Norte

NO. (1)	DESCRIPTION OF WORK (2)	UNIT (3)	QTY. (4)	UNIT PRICE (Pesos) (5)	AMOUNT (Pesos) (4) x (5)
1. NO. 1	MOBILIZATION AND DEMOBILIZATION				
1.01	Mobilization, demobilization	Lump Sum	1		
TOTAL FOR BILL NO. 1					

BILL OF QUANTITIES

Conduct of Soil Investigation/Exploration (Package 8)

Doña Helene, Socorro Surigao Del Norte

NO. (1)	DESCRIPTION OF WORK (2)	UNIT (3)	QTY. (4)	UNIT PRICE (Pesos) (5)	AMOUNT (Pesos) (4) x (5)
1. NO. 2	FIELD WORK				
	OFFSHORE BOREHOLE (4 BH @ 50m)				
2.01	Fabrication and drilling platform	lump sum	1		
2.02	Hole to hole transfer and setting-up including staking of borehole locations	holes	4		
2.03	Drilling on ordinary soils	meter	120		
2.04	Coring of rocks/gravel	meter	14		
2.05	SPT at 1.5m interval	test	120		
2.06	Undisturbed sampling (UDS)	sample	14		
2.07	Safety gears/equipment	set	1		
	INLAND BOREHOLE (BH @ 50m)				
2.08	Hole to hole transfer and setting-up including staking of borehole locations	holes			
2.09	Drilling on ordinary soils	meter			
2.10	Coring of rocks/gravel	meter			
2.11	SPT at 1.5m interval	test			
2.12	Undisturbed sampling (UDS)	sample			
TOTAL FOR BILL NO. 2					

BILL OF QUANTITIES

Conduct of Soil Investigation/Exploration (Package 8)

Doña Helene, Socorro Surigao Del Norte

NO. (1)	DESCRIPTION OF WORK (2)	UNIT (3)	QTY. (4)	UNIT PRICE (Pesos) (5)	AMOUNT (Pesos) (4) x (5)
L NO. 3	LABORATORY TEST				
3.01	Visual Classification	test	134		
3.02	Moisture Content	test	134		
3.03	Grain Size analysis	test	134		
3.04	Atterberg Units	test	134		
3.05	Organic Content	test	134		
3.06	Specific Gravity	test	120		
3.07	Unit Weight	test	134		
3.08	Unconfined Compression	test	134		
3.09	Consolidation	test	15		
TOTAL FOR BILL NO. 3					

BILL OF QUANTITIES

Conduct of Soil Investigation/Exploration (Package 8)

Doña Helene, Socorro Surigao Del Norte

NO. (1)	DESCRIPTION OF WORK (2)	UNIT (3)	QTY. (4)	UNIT PRICE (Pesos) (5)	AMOUNT (Pesos) (4) x (5)
J. NO. 4	TECHNICAL EVALUATION REPORT				
4.01	Technical Evaluation Report	Lump sum	1		
TOTAL FOR BILL NO. 4					

BILL OF QUANTITIES

Conduct of Soil Investigation/Exploration (Package 8)
Sultan Naga Dimaporo Lanao del Norte

NO. (1)	DESCRIPTION OF WORK (2)	UNIT (3)	QTY. (4)	UNIT PRICE (Pesos) (5)	AMOUNT (Pesos) (4) x (5)
I. NO. 1	MOBILIZATION AND DEMOBILIZATION				
1.01	Mobilization, demobilization	Lump Sum	1		
TOTAL FOR BILL NO. 1					

BILL OF QUANTITIES

Conduct of Soil Investigation/Exploration (Package 8)
Sultan Naga Dimaporo Lanao del Norte

NO. (1)	DESCRIPTION OF WORK (2)	UNIT (3)	QTY. (4)	UNIT PRICE (Pesos) (5)	AMOUNT (Pesos) (4) x (5)
I. NO. 2	FIELD WORK				
	OFFSHORE BOREHOLE (4 BH @ 50m)				
2.01	Fabrication and drilling platform	lump sum	1		
2.02	Hole to hole transfer and setting-up including staking of borehole locations	holes	4		
2.03	Drilling on ordinary soils	meter	120		
2.04	Coring of rocks/gravel	meter	14		
2.05	SPT at 1.5m interval	test	120		
2.06	Undisturbed sampling (UDS)	sample	14		
2.07	Safety gears/equipment	set	1		
	INLAND BOREHOLE (BH @ 50m)				
2.08	Hole to hole transfer and setting-up including staking of borehole locations	holes			
2.09	Drilling on ordinary soils	meter			
2.10	Coring of rocks/gravel	meter			
2.11	SPT at 1.5m interval	test			
2.12	Undisturbed sampling (UDS)	sample			
TOTAL FOR BILL NO. 2					

BILL OF QUANTITIES

Conduct of Soil Investigation/Exploration (Package 8)
Sultan Naga Dimaporo Lanao del Norte

NO. (1)	DESCRIPTION OF WORK (2)	UNIT (3)	QTY. (4)	UNIT PRICE (Pesos) (5)	AMOUNT (Pesos) (4) x (5)
1. NO. 3	LABORATORY TEST				
3.01	Visual Classification	test	134		
3.02	Moisture Content	test	134		
3.03	Grain Size analysis	test	134		
3.04	Atterberg Units	test	134		
3.05	Organic Content	test	134		
3.06	Specific Gravity	test	120		
3.07	Unit Weight	test	134		
3.08	Unconfined Compression	test	134		
3.09	Consolidation	test	15		
TOTAL FOR BILL NO. 3					

BILL OF QUANTITIES

Conduct of Soil Investigation/Exploration (Package 8)
Sultan Naga Dimaporo Lanao del Norte

NO. (1)	DESCRIPTION OF WORK (2)	UNIT (3)	QTY. (4)	UNIT PRICE (Pesos) (5)	AMOUNT (Pesos) (4) x (5)
I.L NO. 4	TECHNICAL EVALUATION REPORT				
4.01	Technical Evaluation Report	Lump sum	1		
TOTAL FOR BILL NO. 4					

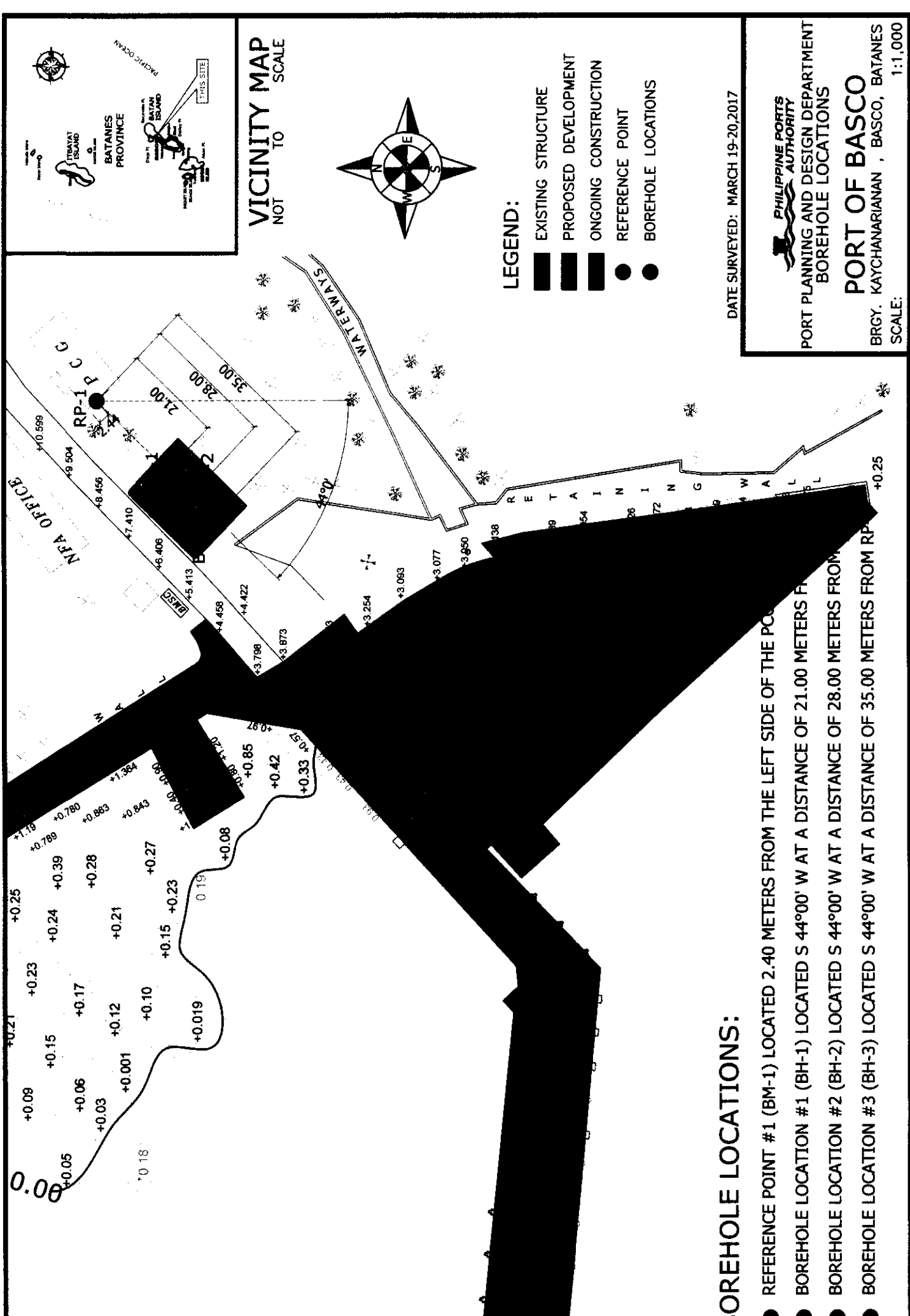

DATE SURVEYED: MARCH 19-20,2017

PHILIPPINE PORTS AUTHORITY
PORT PLANNING AND DESIGN DEPARTMENT
BOREHOLE LOCATIONS

PORT OF BASCO
BRGY. KAYCHANARIANAN , BASCO, BATANES

SCALE: 1:1,000

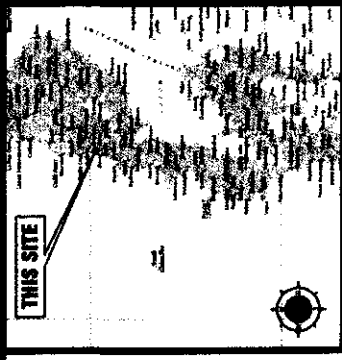

VICINITY MAP
NOT TO SCALE

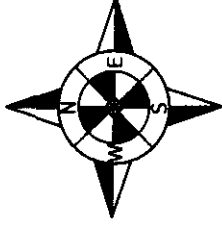

LEGEND:

- EXISTING STRUCTURE
- PROPOSED DEVELOPMENT
- REFERENCE POINT
- BOREHOLE LOCATIONS

DATE SURVEYED: JANUARY 22-24, 2017

PHILIPPINE PORTS
AUTHORITY
PORT PLANNING AND DESIGN DEPARTMENT
BOREHOLE LOCATIONS

PORT OF CURRIMAO

CURIMAO, ILOCOS NORTE

SCALE: 1: 1,000 M.

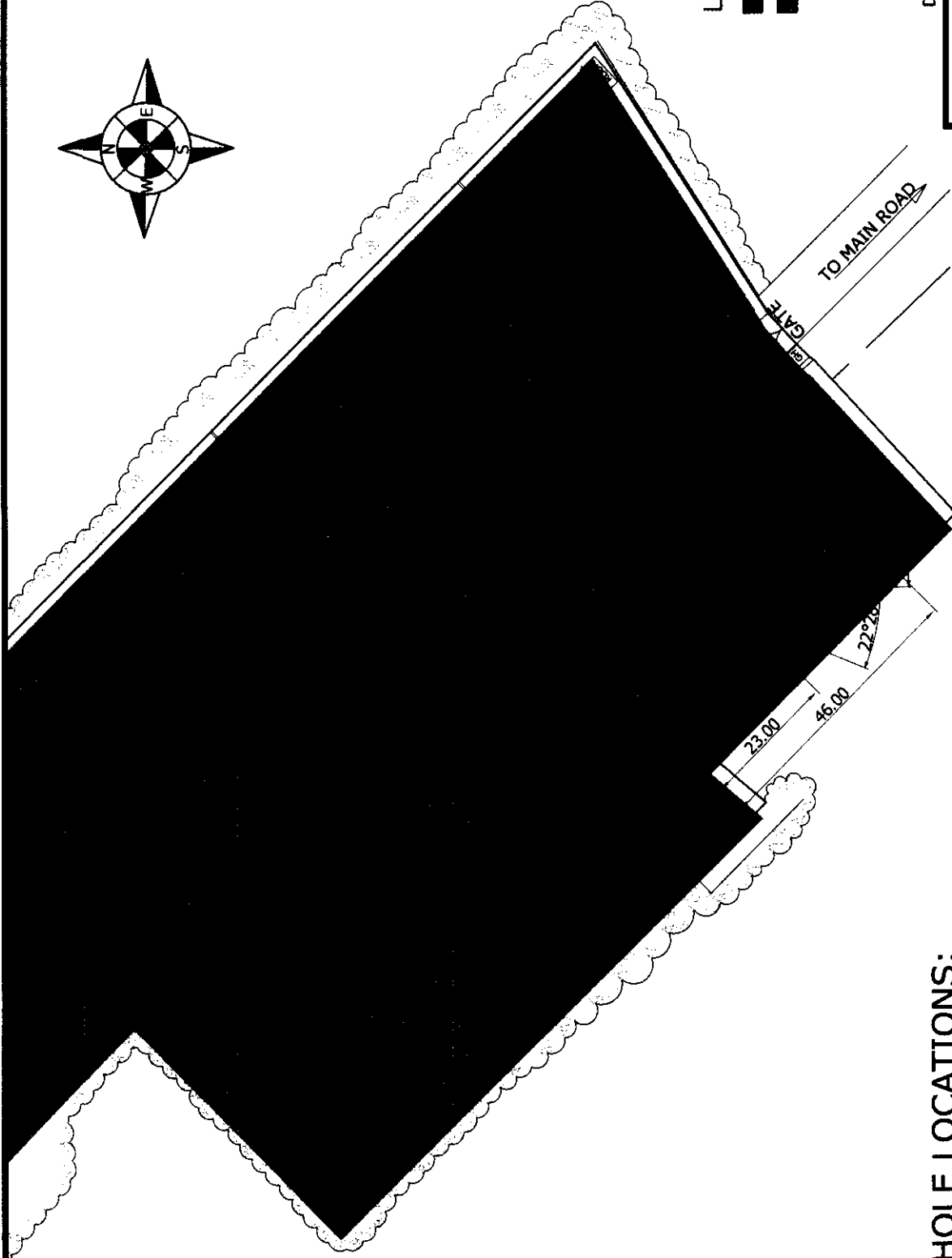

BOREHOLE LOCATIONS:

- REFERENCE POINT #1 (BM-1) LOCATED FROM THE CORNER OF EXISTING PPA BUILDING
- BOREHOLE LOCATION #1 (BH-1) LOCATED S 19° 35' E AT A DISTANCE OF 28.0 METERS FROM RP-1
- BOREHOLE LOCATION #2 (BH-2) LOCATED S 22°28' W AT A DISTANCE OF 13.0 METERS FROM RP-1
- BOREHOLE LOCATION #3 (BH-3) LOCATED N 83°57' W AT A DISTANCE OF 19.0 METERS FROM RP-1

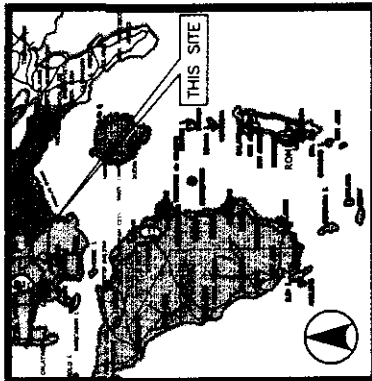

VICINITY MAP
NOT TO SCALE

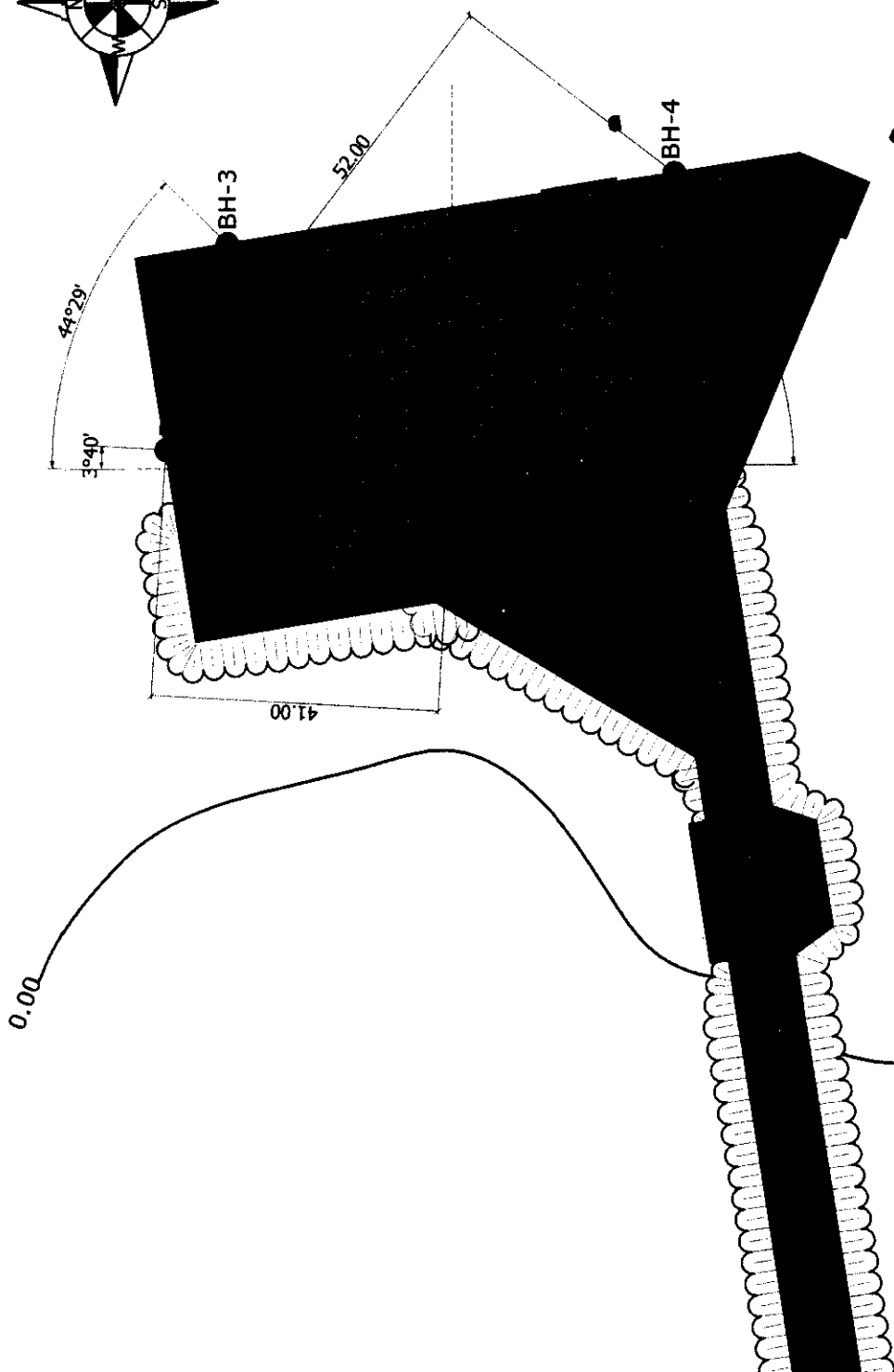
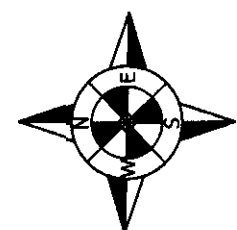

LEGEND:

- EXISTING STRUCTURE
- PROPOSED DEVELOPMENT
- REFERENCE POINT
- BOREHOLE LOCATIONS

DATE SURVEYED: OCTOBER 28 - NOVEMBER 1, 2007



PORT PLANNING AND DESIGN DEPARTMENT
BOREHOLE LOCATIONS

PORT OF SAN JUAN

BRGY. SUBUKIN, SAN JUAN, BATANGAS

SCALE:

1:1000

BOREHOLE LOCATIONS:

- REFERENCE POINT #1 (BM-1) LOCATED AT THE CORNER OF THE EXISTING PTB
- BOREHOLE LOCATION #1 (BH-1) LOCATED N 3°21' W AT A DISTANCE OF 27.0 METERS FROM RP-1
- BOREHOLE LOCATION #2 (BH-2) LOCATED N 3°40' E AT A DISTANCE OF 41.0 METERS FROM RP-1
- BOREHOLE LOCATION #3 (BH-3) LOCATED N 44°29' E AT A DISTANCE OF 45.0 METERS FROM RP-1
- BOREHOLE LOCATION #4 (BH-4) LOCATED S 52°27' E AT A DISTANCE OF 52.0 METERS FROM RP-1

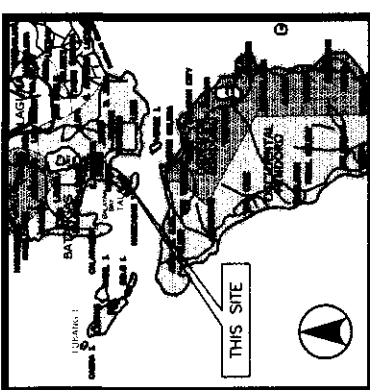

VICINITY MAP
NOT TO SCALE

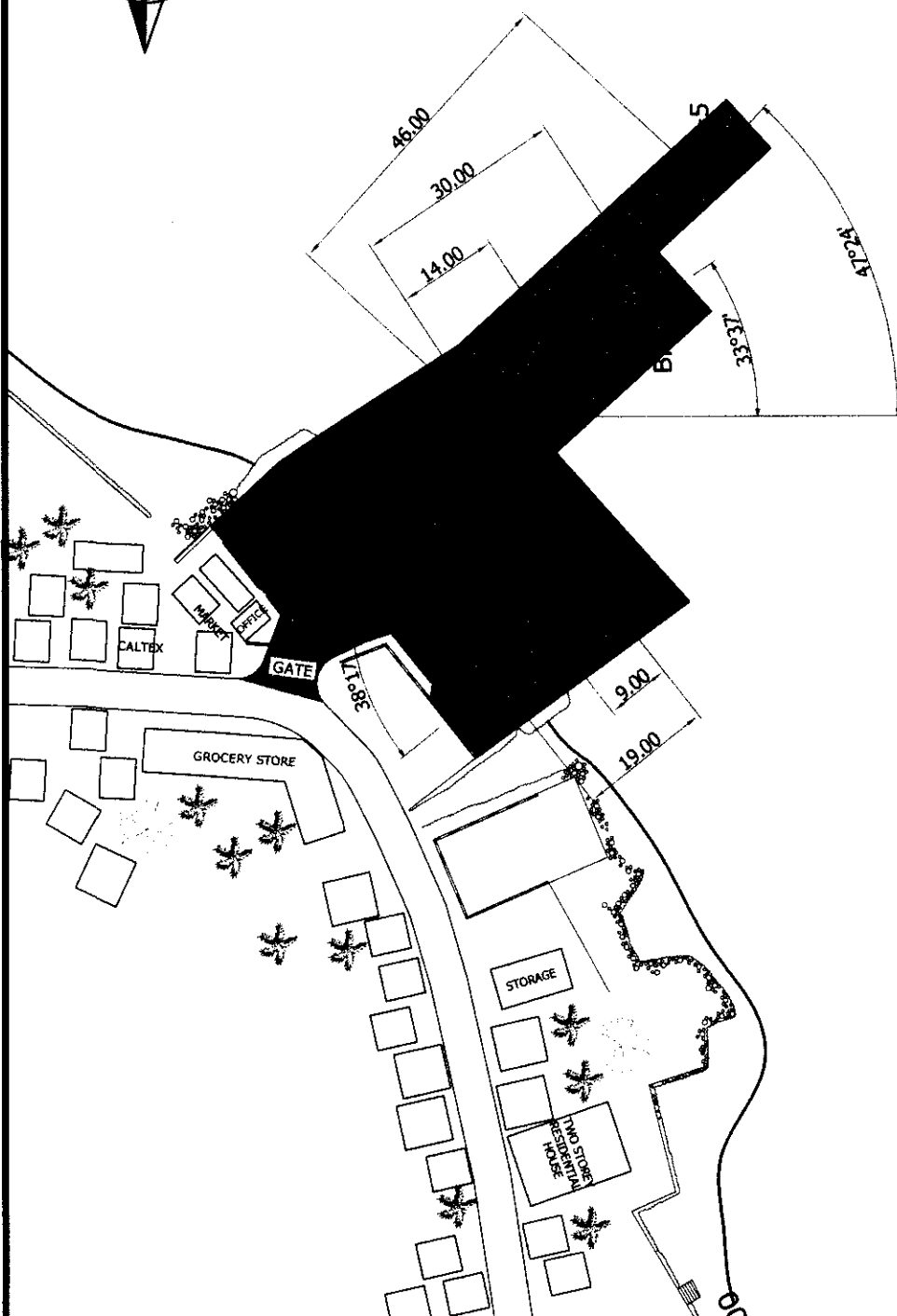
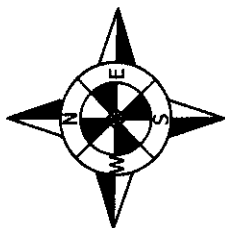

BOREHOLE LOCATIONS:

- REFERENCE POINT #1 (BM-1) LOCATED AT THE MID POINT OF COMMERCIAL BUILDING
- REFERENCE POINT #2 (BM-2) LOCATED AT THE CORNER OF COMMERCIAL BUILDING
- BOREHOLE LOCATION #1 (BH-1) LOCATED N 38°17' W AT A DISTANCE OF 19.0 METERS FROM RP-1
- BOREHOLE LOCATION #2 (BH-2) LOCATED N 38°17' W AT A DISTANCE OF 9.0 METERS FROM RP-1
- BOREHOLE LOCATION #3 (BH-3) LOCATED S 33°37' E AT A DISTANCE OF 14.0 METERS FROM RP-2
- BOREHOLE LOCATION #4 (BH-4) LOCATED S 33°37' E AT A DISTANCE OF 30.0 METERS FROM RP-2
- BOREHOLE LOCATION #5 (BH-5) LOCATED S 47°24' E AT A DISTANCE OF 46.0 METERS FROM RP-2

DATE SURVEYED: APRIL 19-23, 2007



PORT PLANNING AND DESIGN DEPARTMENT
BOREHOLE LOCATIONS

PORT OF TALAGA

BRGY. TALAGA, MABINI, BATANGAS

SCALE:

1:1000

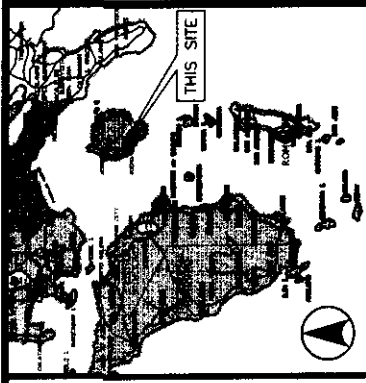

VICINITY MAP
NOT TO SCALE

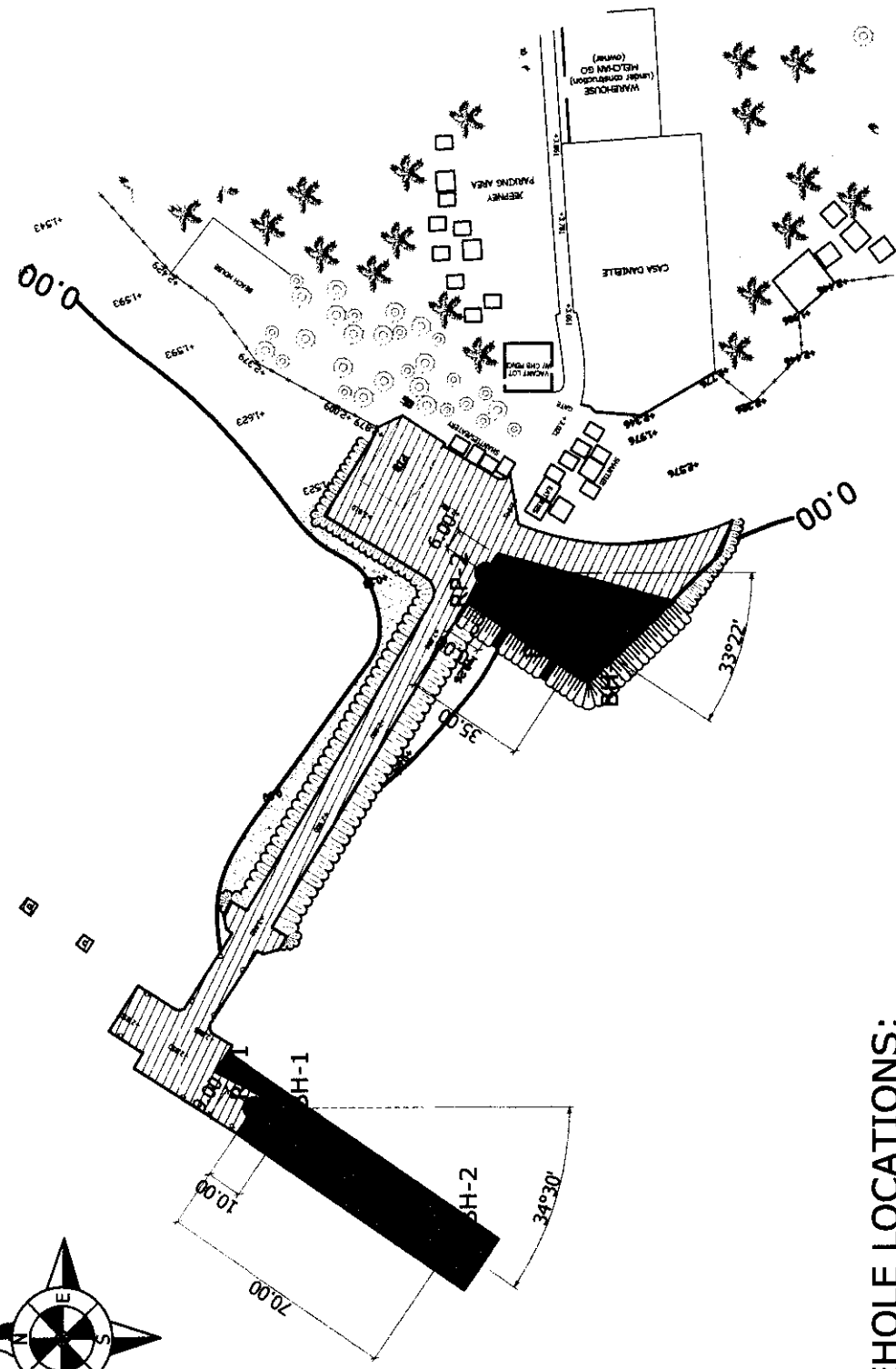

LEGEND:

- EXISTING STRUCTURE
- PROPOSED DEVELOPMENT
- REFERENCE POINT
- BOREHOLE LOCATIONS

DATE SURVEYED: MARCH 7-13, 2006

PHILIPPINE PORTS
AUTHORITY
PORT PLANNING AND DESIGN DEPARTMENT
BOREHOLE LOCATIONS

PORT OF CAWIT

BRGY. CAWIT, BOAC, MARINDUQUE

SCALE: 1:2000

BOREHOLE LOCATIONS:

- REFERENCE POINT #1 (BM-1) LOCATED 6.00 METERS FROM THE CORNER OF THE ROCK CAUSEWAY AND BACK UP AREA
- REFERENCE POINT #2 (BM-2) LOCATED 9.00 METERS FROM THE CORNER OF THE R.C. WHARF
- BOREHOLE LOCATION #1 (BH-1) LOCATED S 34°30' W AT A DISTANCE OF 10.0 METERS FROM RP-1
- BOREHOLE LOCATION #2 (BH-2) LOCATED S 34°30' W AT A DISTANCE OF 70.0 METERS FROM RP-1
- BOREHOLE LOCATION #3 (BH-3) LOCATED S 33°22' W AT A DISTANCE OF 10.0 METERS FROM RP-1
- BOREHOLE LOCATION #4 (BH-4) LOCATED S 33°22' W AT A DISTANCE OF 35.0 METERS FROM RP-1

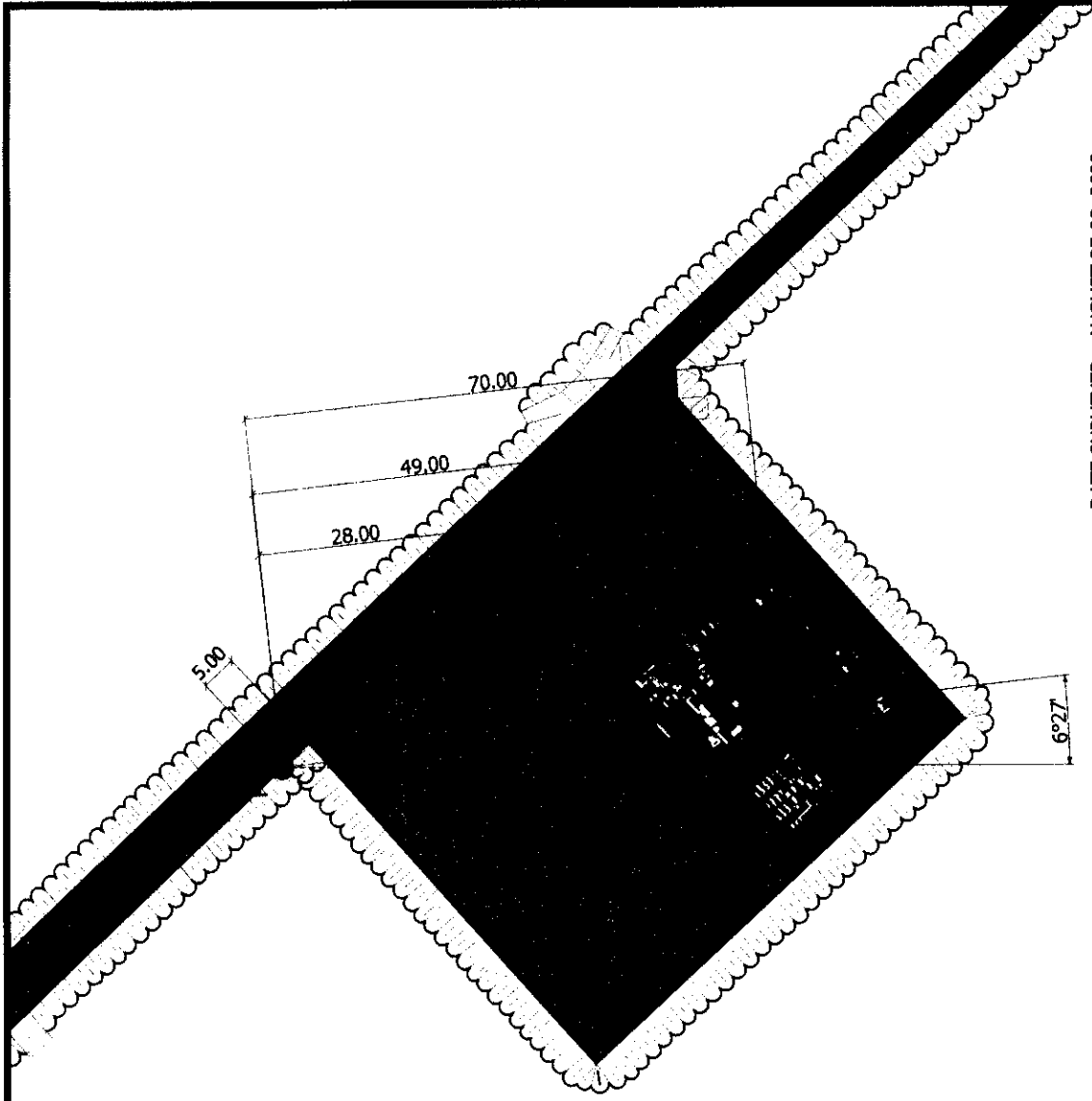
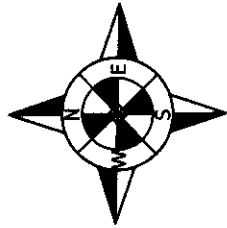
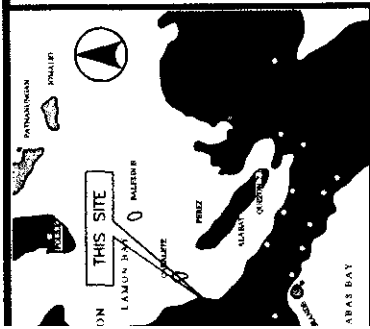
/ICINITY MAP
LOT TO SCALE

LEGEND:

- EXISTING STRUCTURE
PROPOSED DEVELOPMENT
REFERENCE POINT
BOREHOLE LOCATIONS

BOREHOLE LOCATIONS:

- REFERENCE POINT #1 (BM-1) LOCATED 5.00 METERS FROM THE CORNER OF STAIR LANDING AT THE ROCK CAUSEWAY
- BOREHOLE LOCATION #1 (BH-1) LOCATED S 6°27' E AT A DISTANCE OF 28.0 METERS FROM RP-1
- BOREHOLE LOCATION #2 (BH-2) LOCATED S 6°27' E AT A DISTANCE OF 49.0 METERS FROM RP-1
- BOREHOLE LOCATION #3 (BH-3) LOCATED S 6°27' E AT A DISTANCE OF 70.0 METERS FROM RP-1

DATE SURVEYED: AUGUST 25-29, 2009



PORT PLANNING AND DESIGN DEPARTMENT BOREHOLE LOCATIONS

PORT OF MAUBAN

BRGY. DAUNGAN, MAUBAN, QUEZON

SCALE: 1:1,000

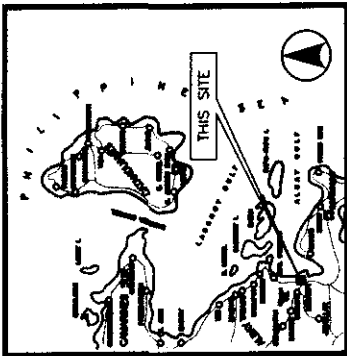

VICINITY MAP NOT TO SCALE

- LEGEND:
- EXISTING STRUCTURE
 - PROPOSED DEVELOPMENT
 - REFERENCE POINT
 - BOREHOLE LOCATIONS

BOREHOLE LOCATIONS:

- REFERENCE POINT #1 (BM-1) LOCATED AT THE CORNER OF THE BACK UP AREA
- BOREHOLE LOCATION #1 (BH-1) LOCATED N 3°3' E AT A DISTANCE OF 33.0 METERS FROM RP-1
- BOREHOLE LOCATION #2 (BH-2) LOCATED N 8°26' E AT A DISTANCE OF 72.0 METERS FROM RP-1
- BOREHOLE LOCATION #3 (BH-3) LOCATED N 29°40' E AT A DISTANCE OF 49.0 METERS FROM RP-1
- BOREHOLE LOCATION #4 (BH-4) LOCATED N 69°23' E AT A DISTANCE OF 41.0 METERS FROM RP-1

DATE SURVEYED: OCTOBER 09 - 13, 2013
DATE SURVEYED: JUNE 4-6, 2013

PHILIPPINE PORTS
AUTHORITY
PORT PLANNING AND DESIGN DEPARTMENT
BOREHOLE LOCATIONS
PORT OF LEGAZPI
LEGAZPI CITY, ALBAY
SCALE: 1:1,000

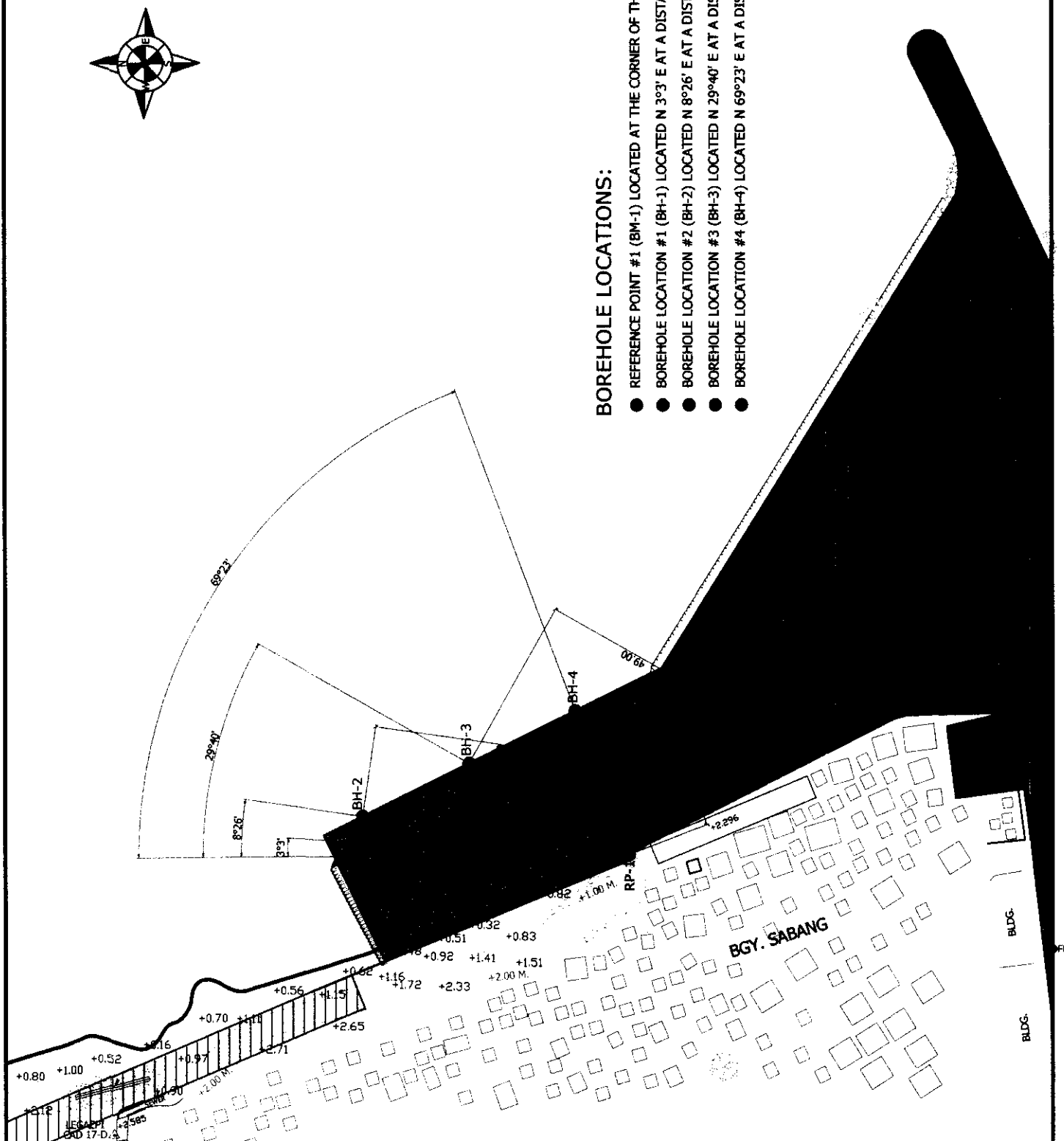



LEGEND:

- EXISTING STRUCTURE
- PROPOSED DEVELOPMENT
- REFERENCE POINT
- BOREHOLE LOCATIONS

BOREHOLE LOCATIONS:

- REFERENCE POINT #1 (BM-1) LOCATED 24.00 METERS FROM THE CORNER OF THE EXISTING CAUSEWAY
- BOREHOLE LOCATION #1 (BH-1) LOCATED N 55°14' W AT A DISTANCE OF 20.00 METERS FROM RP-1
- BOREHOLE LOCATION #2 (BH-2) LOCATED N 55°14' W AT A DISTANCE OF 27.00 METERS FROM RP-1
- BOREHOLE LOCATION #3 (BH-3) LOCATED N 55°14' W AT A DISTANCE OF 35.00 METERS FROM RP-1

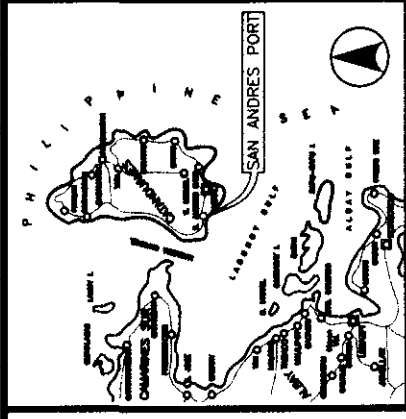

VICINITY MAP
NOT
TO
SCALE

DATE SURVEYED: OCTOBER 24-28, 2006



PHILIPPINE PORTS
AUTHORITY
PORT PLANNING AND DESIGN DEPARTMENT
BOREHOLE LOCATIONS

PORT OF SAN ANDRES

BRGY. SAN ROQUE, SAN ANDRES, CATANDUANES

SCALE: 1:1,000

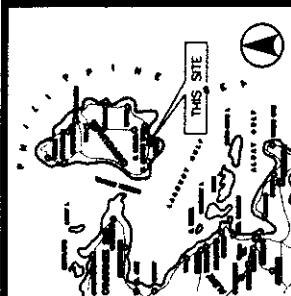

VICINITY MAP
NOT TO SCALE

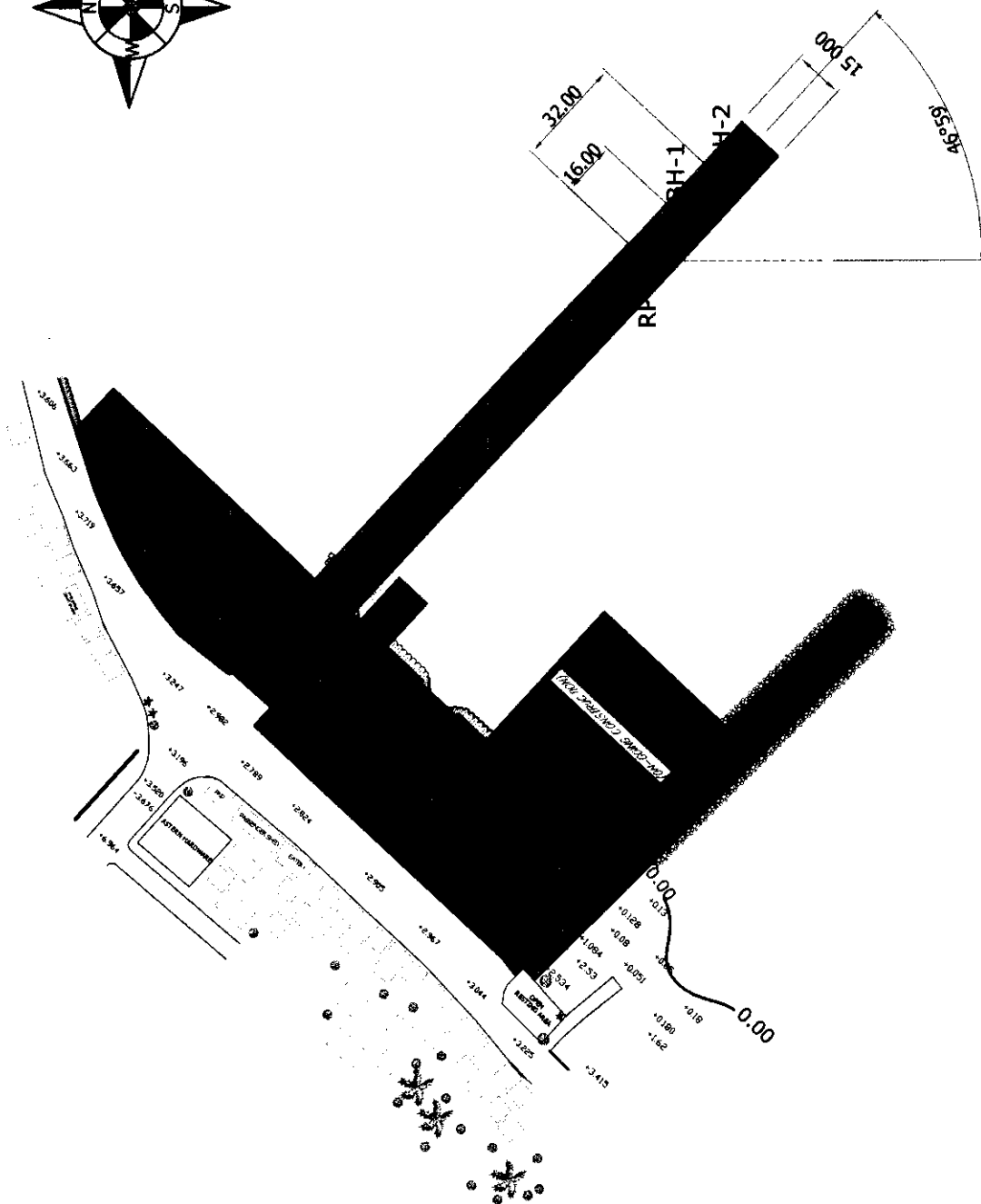
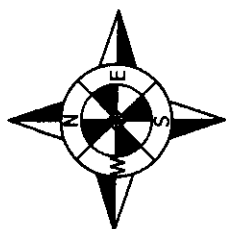

BOREHOLE LOCATIONS:

- REFERENCE POINT #1 (BM-1) LOCATED AT THE MID POINT OF THE R.C. PIER
- BOREHOLE LOCATION #1 (BH-1) LOCATED S 46°59' E AT A DISTANCE OF 16.0 METERS FROM RP-1
- BOREHOLE LOCATION #2 (BH-2) LOCATED S 46°59' E AT A DISTANCE OF 32.0 METERS FROM RP-1

DATE SURVEYED: JULY 04-06, 2017



PORT PLANNING AND DESIGN DEPARTMENT
BOREHOLE LOCATIONS

PORT OF VIRAC

RGY. STA. CRUZ, VIRAC, CATANDUANES

SCALE: 1:2,000

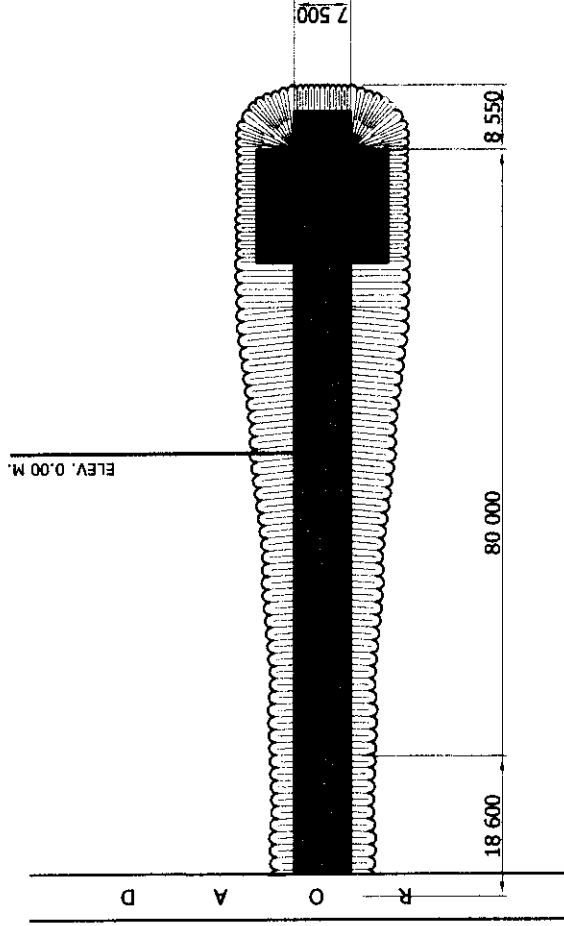

VICINITY MAP NOT TO SCALE

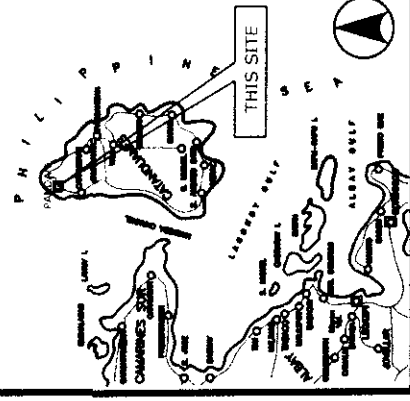

LEGEND :

- PROPOSED DEVELOPMENT
- REFERENCE POINT
- BOREHOLE LOCATIONS

BOREHOLE LOCATIONS:

- REFERENCE POINT #1 (BM-1) LOCATED 1.50 METERS FROM THE CORNER OF THE R.C. PIER
- BOREHOLE LOCATION #1 (BH-1) LOCATED N 72°51' E AT A DISTANCE OF 3.0 METERS FROM RP-1
- BOREHOLE LOCATION #2 (BH-2) LOCATED N 89°26' E AT A DISTANCE OF 52.17 METERS FROM RP-1
- BOREHOLE LOCATION #3 (BH-3) LOCATED N 72°51' E AT A DISTANCE OF 98.0 METERS FROM RP-1

DATE SURVEYED: MARCH 15 - 19, 2013

**PHILIPPINE PORTS
AUTHORITY**
PORT PLANNING AND DESIGN DEPARTMENT
DEVELOPMENT PLAN

PORT OF PANDAN

BRGY. COBO, PANDAN, CATANDUANES

SCALE:

1:1,000

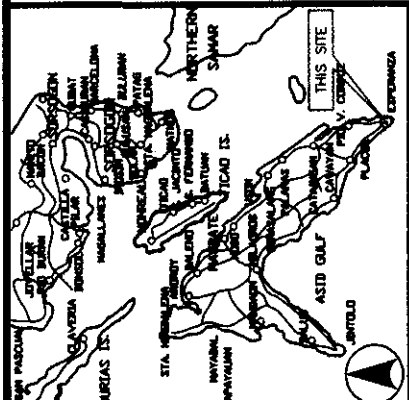

VICINITY MAP
NOT TO SCALE

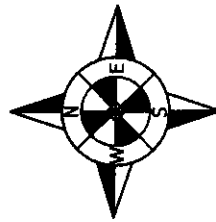

LEGEND:

- EXISTING STRUCTURE
- PROPOSED DEVELOPMENT
- REFERENCE POINT
- BOREHOLE LOCATIONS

DATE SURVEYED: JUNE 16-25, 2005

PHILIPPINE PORTS
AUTHORITY
PORT PLANNING AND DESIGN DEPARTMENT
BOREHOLE LOCATIONS

PORT OF ESPERANZA
MASBATE

SCALE: 1:1000

BOREHOLE LOCATIONS:

- REFERENCE POINT #1 (BM-1) LOCATED AT THE MID POINT OF RO RAMP
- BOREHOLE LOCATION #1 (BH-1) LOCATED N 37°12' W AT A DISTANCE OF 10.0 METERS FROM RP-1
- BOREHOLE LOCATION #2 (BH-2) LOCATED N 37°12' W AT A DISTANCE OF 40.0 METERS FROM RP-1
- BOREHOLE LOCATION #3 (BH-3) LOCATED N 14°35' E AT A DISTANCE OF 27.0 METERS FROM RP-1

BOREHOLE LOCATIONS:

- REFERENCE POINT #1 (BM-1) LOCATED 8.0 METERS FROM THE CORNER OF THE BACK
- BOREHOLE LOCATION #1 (BH-1) LOCATED S 15°47' W AT A DISTANCE OF 35.0 METERS
- BOREHOLE LOCATION #2 (BH-2) LOCATED S 23°38' W AT A DISTANCE OF 136.0 METERS
- BOREHOLE LOCATION #3 (BH-3) LOCATED S 27°34' W AT A DISTANCE OF 267.0 METERS
- BOREHOLE LOCATION #4 (BH-4) LOCATED S 28°19' W AT A DISTANCE OF 328.0 METERS FROM



VICINITY MAP
NOT TO SCALE



LEGEND:

- EXISTING STRUCTURE
- PROPOSED DEVELOPMENT
- REFERENCE POINT
- BOREHOLE LOCATIONS

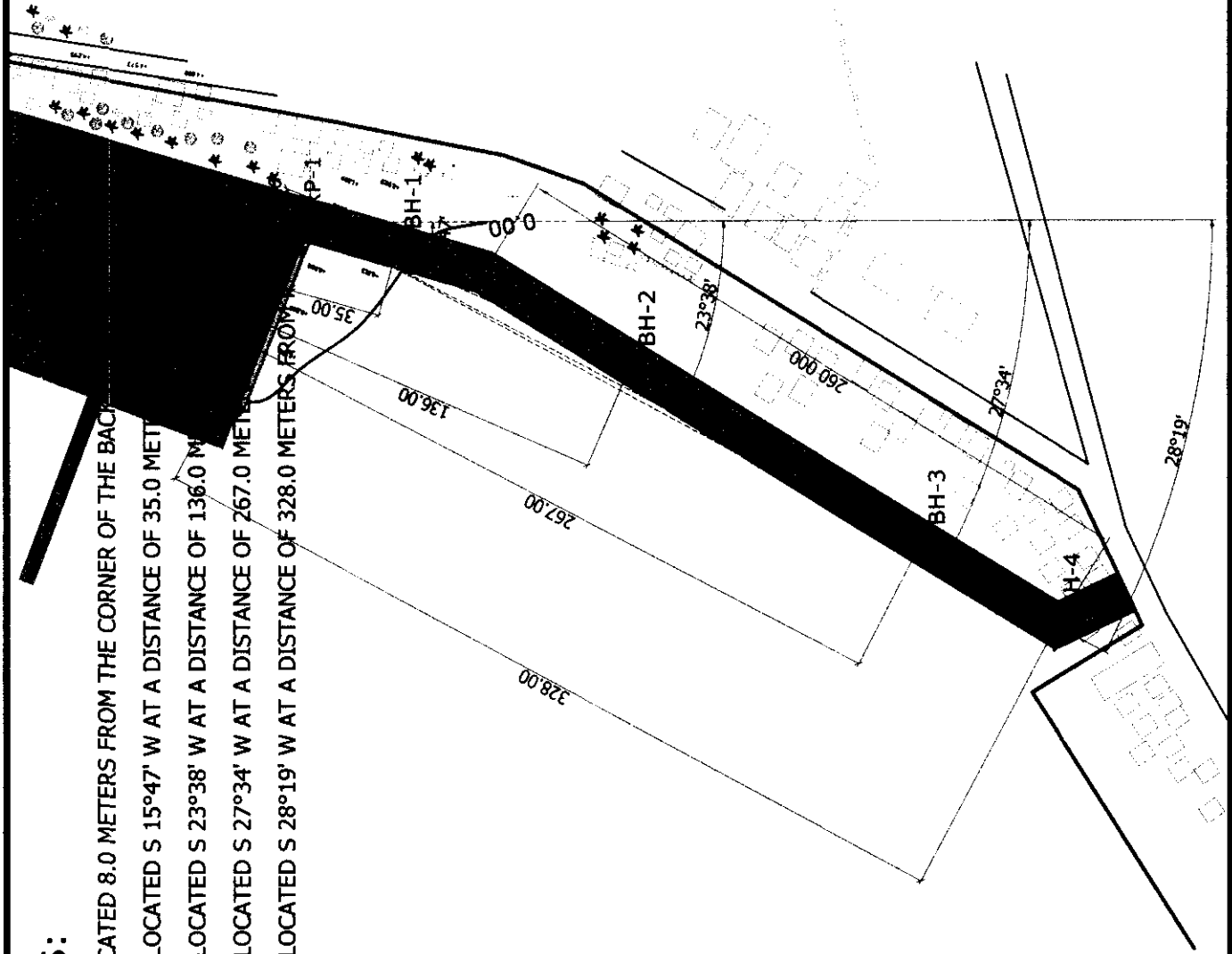

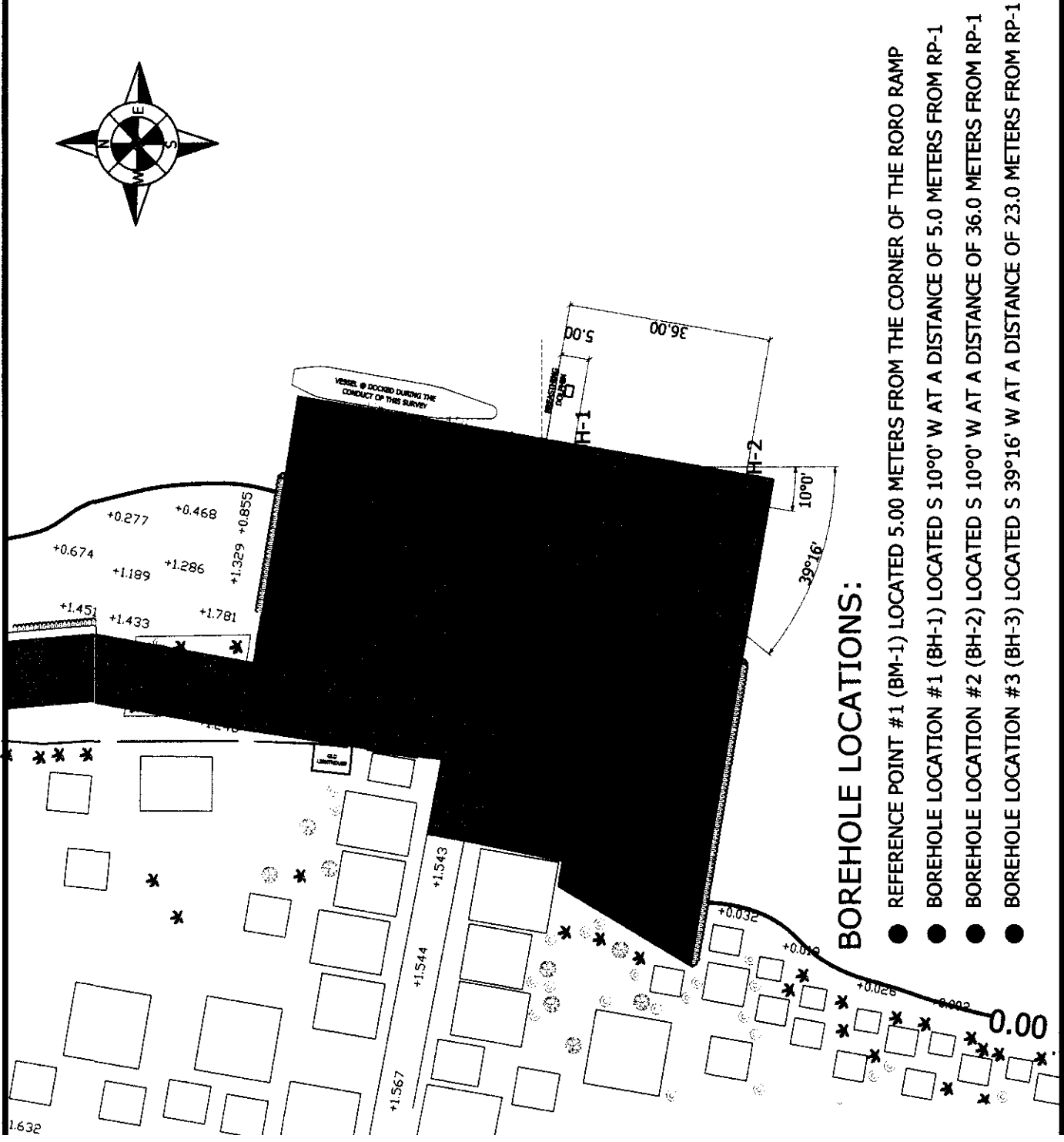

BOREHOLE LOCATIONS:

- REFERENCE POINT #1 (BM-1) LOCATED 5.00 METERS FROM THE CORNER OF THE RORO RAMP
- BOREHOLE LOCATION #1 (BH-1) LOCATED S 10°0' W AT A DISTANCE OF 5.0 METERS FROM RP-1
- BOREHOLE LOCATION #2 (BH-2) LOCATED S 10°0' W AT A DISTANCE OF 36.0 METERS FROM RP-1
- BOREHOLE LOCATION #3 (BH-3) LOCATED S 39°16' W AT A DISTANCE OF 23.0 METERS FROM RP-1

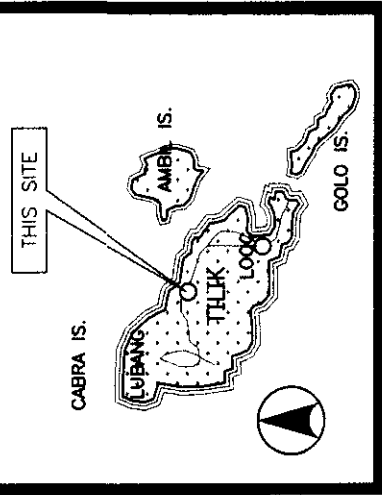

VICINITY MAP
NOT TO SCALE

LEGEND:

- EXISTING STRUCTURE
- PROPOSED DEVELOPMENT
- REFERENCE POINT
- BOREHOLE LOCATIONS

DATE SURVEYED: NOVEMBER 25 -30, 2014



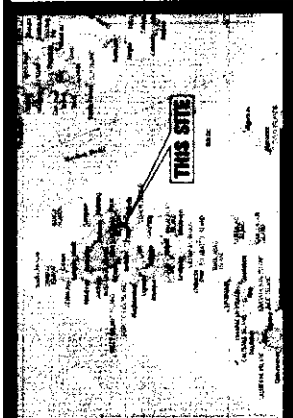

PHILIPPINE PORTS AUTHORITY
 PORT PLANNING AND DESIGN DEPARTMENT
 BOREHOLE LOCATIONS
PORT OF LUBANG
 TILIK, LUBANG ISLAND, OCC. MINDORO
 SCALE: 1:1,000

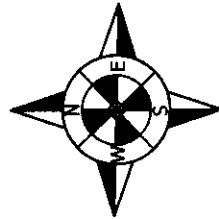

VICINITY MAP
NOT TO SCALE



LEGEND:

-  EXISTING STRUCTURE
-  PROPOSED DEVELOPMENT
-  REFERENCE POINT
-  BOREHOLE LOCATIONS



PORT PLANNING AND DESIGN DEPARTMENT
BOREHOLE LOCATIONS

PORT OF CORON

BRGY. TAGUMPAY, CORON, PALAWAN

SCALE: 1:1,000

BOREHOLE LOCATIONS:

- REFERENCE POINT #1 (BM-1) LOCATED 12.00 METERS FROM THE CORNER OF THE R.C. PIER
- BOREHOLE LOCATION #1 (BH-1) LOCATED N 41°44' E AT A DISTANCE OF 5.0 METERS FROM RP-1
- BOREHOLE LOCATION #2 (BH-2) LOCATED N 41°44' E AT A DISTANCE OF 25.0 METERS FROM RP-1
- BOREHOLE LOCATION #3 (BH-3) LOCATED N 39°0' W AT A DISTANCE OF 52.0 METERS FROM RP-1



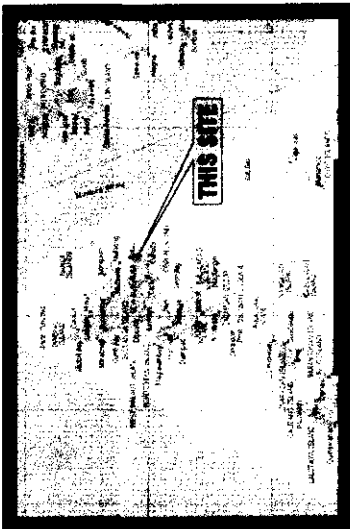

VICINITY MAP
NOT TO SCALE

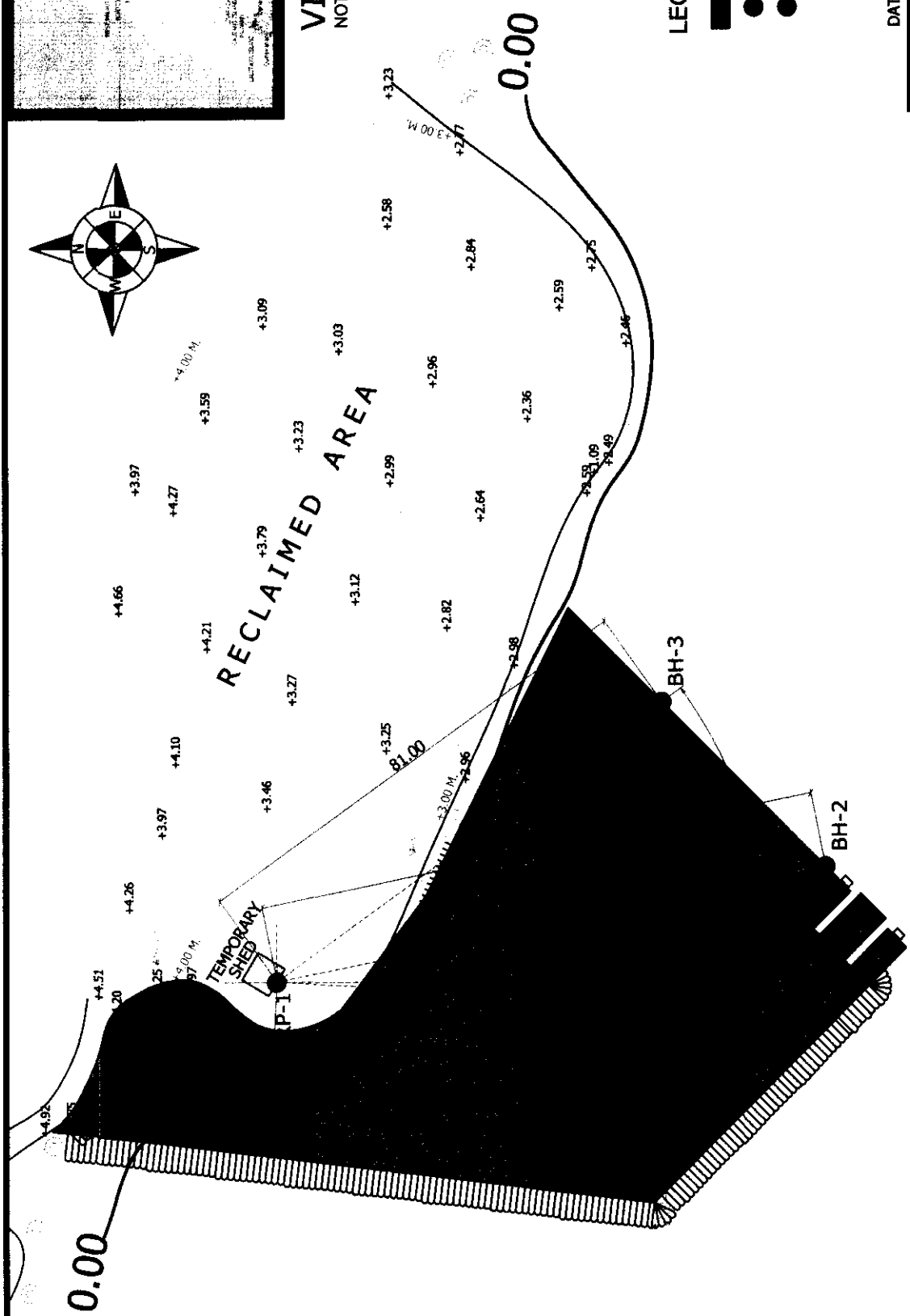

LEGEND:

- PROPOSED DEVELOPMENT
- REFERENCE POINT
- BOREHOLE LOCATIONS

DATE SURVEYED: DECEMBER 07, 2016

PHILIPPINE PORTS
AUTHORITY
PORT PLANNING AND DESIGN DEPARTMENT
BOREHOLE LOCATIONS

PORT OF BORAC

BRGY. BORAC, CORON, PALAWAN

SCALE: 1:1,000

BOREHOLE LOCATIONS:

- REFERENCE POINT #1 (BM-1) LOCATED 3.00 METERS FROM THE CORNER OF THE TEMPORARY SHED
- BOREHOLE LOCATION #1 (BH-1) LOCATED S 3°9' W AT A DISTANCE OF 52.0 METERS FROM RP-1
- BOREHOLE LOCATION #2 (BH-2) LOCATED S 11°32' E AT A DISTANCE OF 96.0 METERS FROM RP-1
- BOREHOLE LOCATION #3 (BH-3) LOCATED S 35°35' E AT A DISTANCE OF 81.0 METERS FROM RP-1

BOREHOLE LOCATIONS:

- REFERENCE POINT #1 (BM-1) LOCATED AT THE END OF DAMAGED ROCK CAUSEWAY
- BOREHOLE LOCATION #1 (BH-1) LOCATED N 84°20' W AT A DISTANCE OF 22.0 METERS FROM RP-1
- BOREHOLE LOCATION #2 (BH-2) LOCATED S 86°14' W AT A DISTANCE OF 93.00 METERS FROM RP-1
- BOREHOLE LOCATION #3 (BH-3) LOCATED S 89°16' W AT A DISTANCE OF 119.0 METERS FROM RP-1
- BOREHOLE LOCATION #4 (BH-4) LOCATED S 67°58' W AT A DISTANCE OF 134.0 METERS FROM RP-1

On-going Reclamation of LGU-Palawan
(Actual boundary to be verify)

LEGEND:

- EXISTING STRUCTURE
- PROPOSED DEVELOPMENT
- REFERENCE POINT
- BOREHOLE LOCATIONS

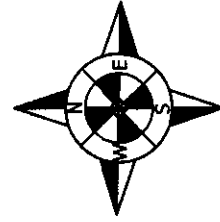

DATE SURVEYED: MAY 26 - 29, 2017



PORT PLANNING AND DESIGN DEPARTMENT
BOREHOLE LOCATIONS

PORT OF SAN FERNANDO

BGRY.SAN FERNANDO, EL NIDO, PALAWAN

SCALE: 1:1,000

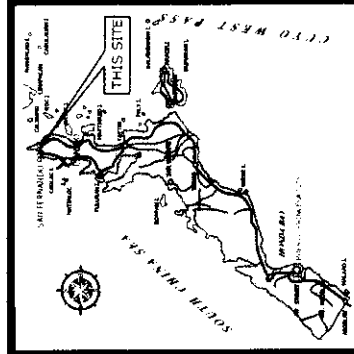

VICINITY MAP
NOT TO SCALE

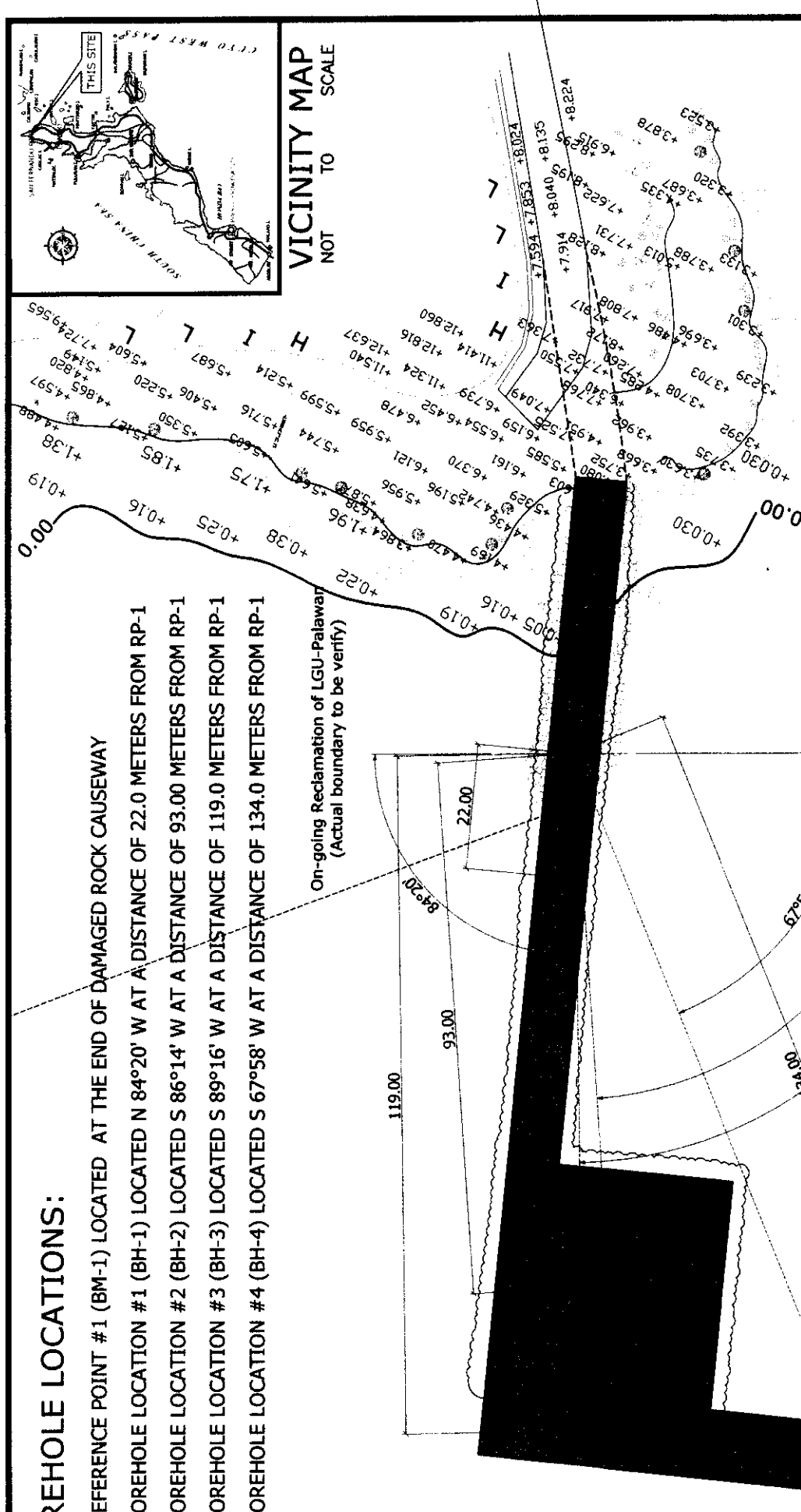

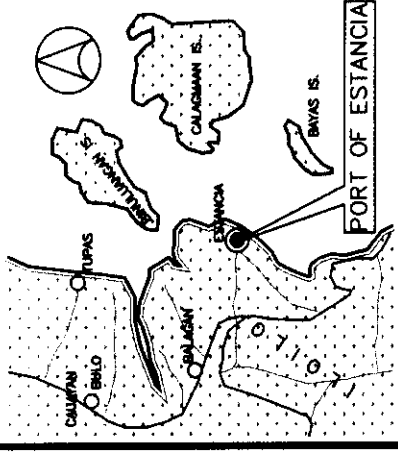
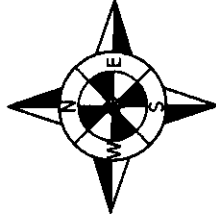
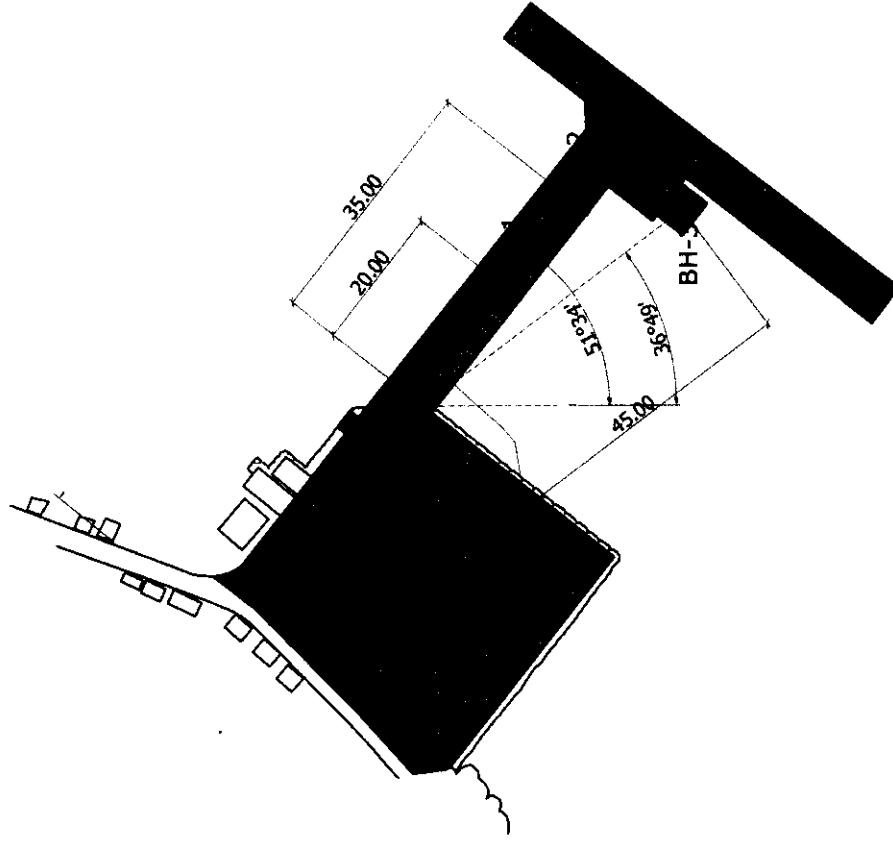

VICINITY MAP
NOT TO SCALE

LEGEND:

- EXISTING STRUCTURE
- PROPOSED DEVELOPMENT
- REFERENCE POINT
- BOREHOLE LOCATIONS

BOREHOLE LOCATIONS:

- REFERENCE POINT #1 (BM-1) LOCATED 1.50 METERS FROM THE CORNER OF THE R.C. PIER
- BOREHOLE LOCATION #1 (BH-1) LOCATED S 51°34' E AT A DISTANCE OF 20.0 METERS FROM RP-1
- BOREHOLE LOCATION #2 (BH-2) LOCATED S 51°34' E AT A DISTANCE OF 35.0 METERS FROM RP-1
- BOREHOLE LOCATION #3 (BH-3) LOCATED S 36°49' E AT A DISTANCE OF 45.0 METERS FROM RP-1

PHILIPPINE PORTS
AUTHORITY
PORT PLANNING AND DESIGN DEPARTMENT
BOREHOLE LOCATIONS

PORT OF ESTANCIA
ESTANCIA, ILOILO

SCALE:

1:2,000

BOREHOLE LOCATIONS:

- REFERENCE POINT #1 (BM-1) LOCATED 1.80 METERS FROM THE CORNER OF THE BACK AREA
- BOREHOLE LOCATION #1 (BH-1) LOCATED S 57°24' E AT A DISTANCE OF 13.0 METERS FROM RP-1
- BOREHOLE LOCATION #2 (BH-2) LOCATED S 87°05' E AT A DISTANCE OF 55.0 METERS FROM RP-1
- BOREHOLE LOCATION #3 (BH-3) LOCATED S 54°41' E AT A DISTANCE OF 42.0 METERS FROM RP-1

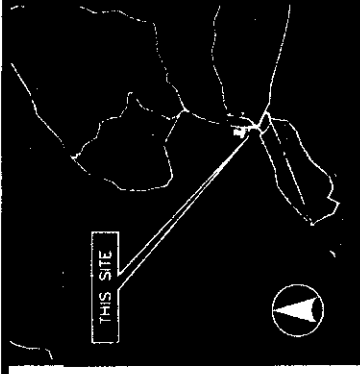
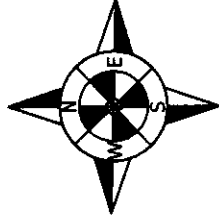

VICINITY MAP
NOT TO SCALE

LEGEND:

- EXISTING STRUCTURE
- PROPOSED DEVELOPMENT
- REFERENCE POINT
- BOREHOLE LOCATIONS

DATE SURVEYED : MAY 18-22, 2015

PHILIPPINE PORTS
AUTHORITY
PORT PLANNING AND DESIGN DEPARTMENT
BOREHOLE LOCATIONS

PORT OF TAGBILARAN
TAGBILARAN CITY, BOHOL

SCALE: 1: 1,000

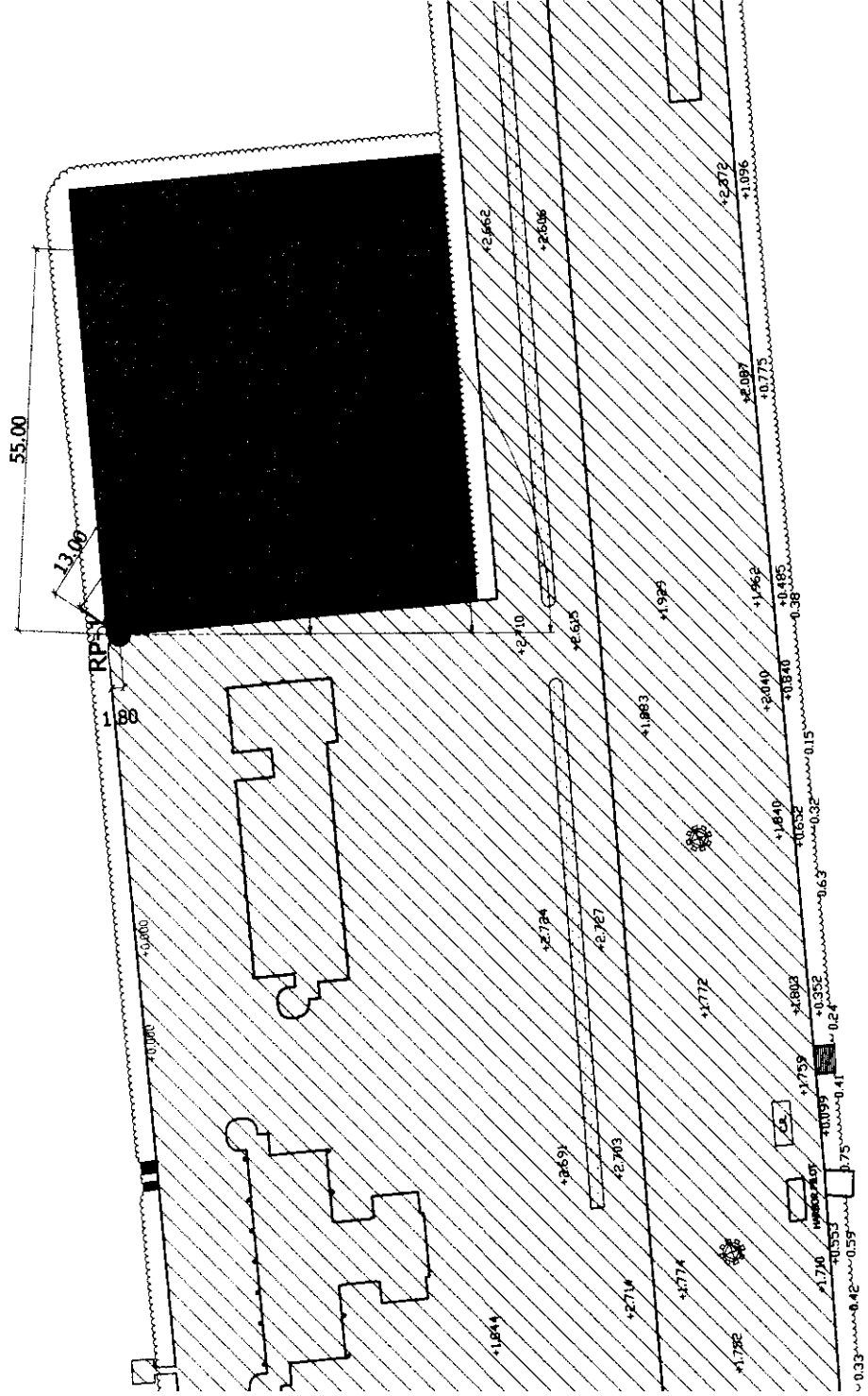

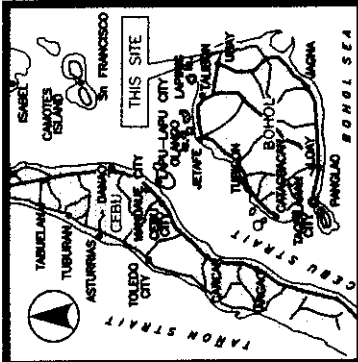
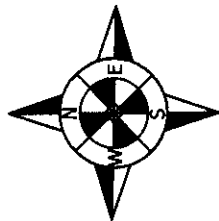

VICINITY MAP
NOT TO SCALE

BOREHOLE LOCATIONS:

- REFERENCE POINT #1 (BM-1) LOCATED 6.0 METERS FROM THE CORNER OF THE R.C. WHARF
- BOREHOLE LOCATION #1 (BH-1) LOCATED N 26° 06' E AT A DISTANCE OF 24.0 METERS FROM RP-1
- BOREHOLE LOCATION #2 (BH-2) LOCATED N 26° 06' E AT A DISTANCE OF 49.0 METERS FROM RP-1
- BOREHOLE LOCATION #3 (BH-3) LOCATED N 26° 06' E AT A DISTANCE OF 74.0 METERS FROM RP-1

LEGEND:

- EXISTING STRUCTURE
- PROPOSED DEVELOPMENT
- REFERENCE POINT
- BOREHOLE LOCATIONS

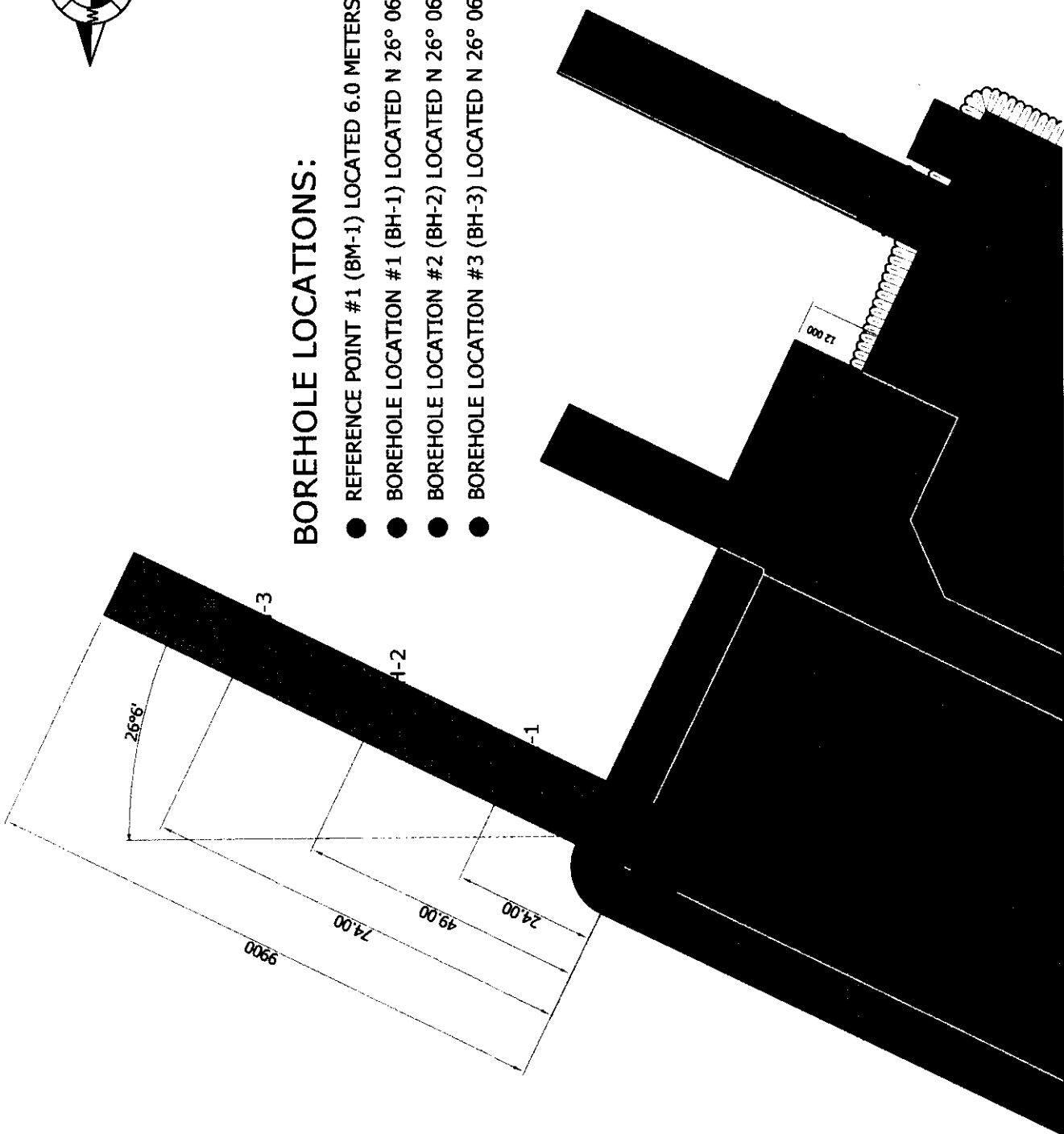

PHILIPPINE PORTS
AUTHORITY
PORT PLANNING AND DESIGN DEPARTMENT
BOREHOLE LOCATIONS

PORT OF UBAY

UBAY, BOHOL

SCALE:

1:1,000

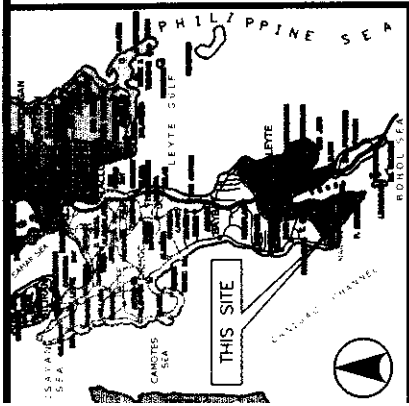

VICINITY MAP
NOT TO SCALE

LEGEND:

- EXISTING STRUCTURE
- PROPOSED DEVELOPMENT
- REFERENCE POINT
- BOREHOLE LOCATIONS

BOREHOLE LOCATIONS:

- REFERENCE POINT #1 (BM-1) LOCATED 3.00 METERS FROM THE CORNER OF THE EXISTING PTB - PPA OFFICE
- REFERENCE POINT #2 (BM-2) LOCATED AT THE CORNER OF THE EXISTING PTB - PPA OFFICE
- BOREHOLE LOCATION #1 (BH-1) LOCATED N 77°50' E AT A DISTANCE OF 13.0 METERS FROM RP-1
- BOREHOLE LOCATION #2 (BH-2) LOCATED N 77°50' E AT A DISTANCE OF 29.0 METERS FROM RP-2
- BOREHOLE LOCATION #3 (BH-3) LOCATED S 60°17' W AT A DISTANCE OF 22.0 METERS FROM RP-2
- BOREHOLE LOCATION #4 (BH-4) LOCATED S 2°25' W AT A DISTANCE OF 117.0 METERS FROM RP-2

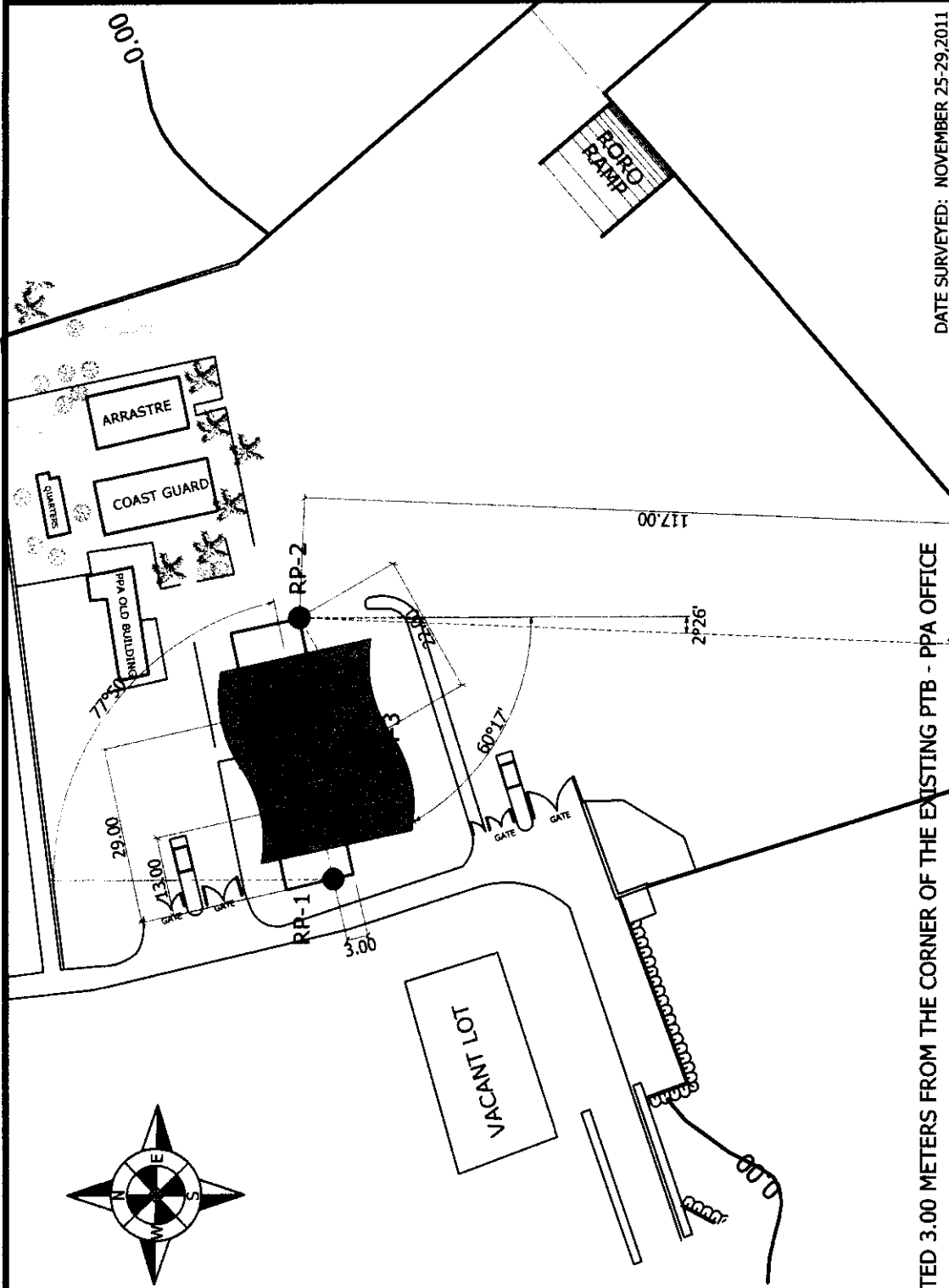

BOREHOLE LOCATIONS:

REFERENCE POINT #1 (BM-1) LOCATED AT THE CORNER OF EXISTING PTB

BOREHOLE LOCATION #1 (BH-1) LOCATED N 91°49' W AT A DISTANCE OF 37.0 METERS FROM RP-1

BOREHOLE LOCATION #2 (BH-2) LOCATED N 43°22' W AT A DISTANCE OF 30.0 METERS FROM RP-1

BOREHOLE LOCATION #3 (BH-3) LOCATED N 60°59' W AT A DISTANCE OF 55.0 METERS FROM RP-1

BOREHOLE LOCATION #4 (BH-4) LOCATED N 67°9' W AT A DISTANCE OF 78.0 METERS FROM RP-1

LEGEND:

- EXISTING STRUCTURE
- ONGOING CONSTRUCTION
- PROPOSED DEVELOPMENT
- REFERENCE POINT
- BOREHOLE LOCATIONS

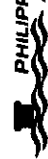

PHILIPPINE PORTS
AUTHORITY

PORT PLANNING AND DESIGN DEPARTMENT

BOREHOLE LOCATIONS

PORT OF SIKUIJOR

SIKUIJOR ISLAND

SCALE: 1:1,000

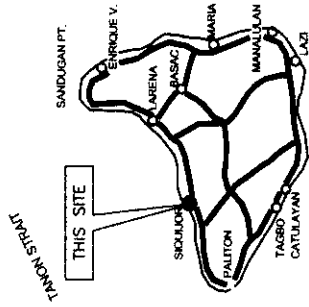
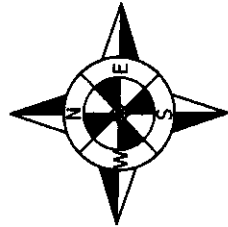

VICINITY MAP
NOT TO SCALE

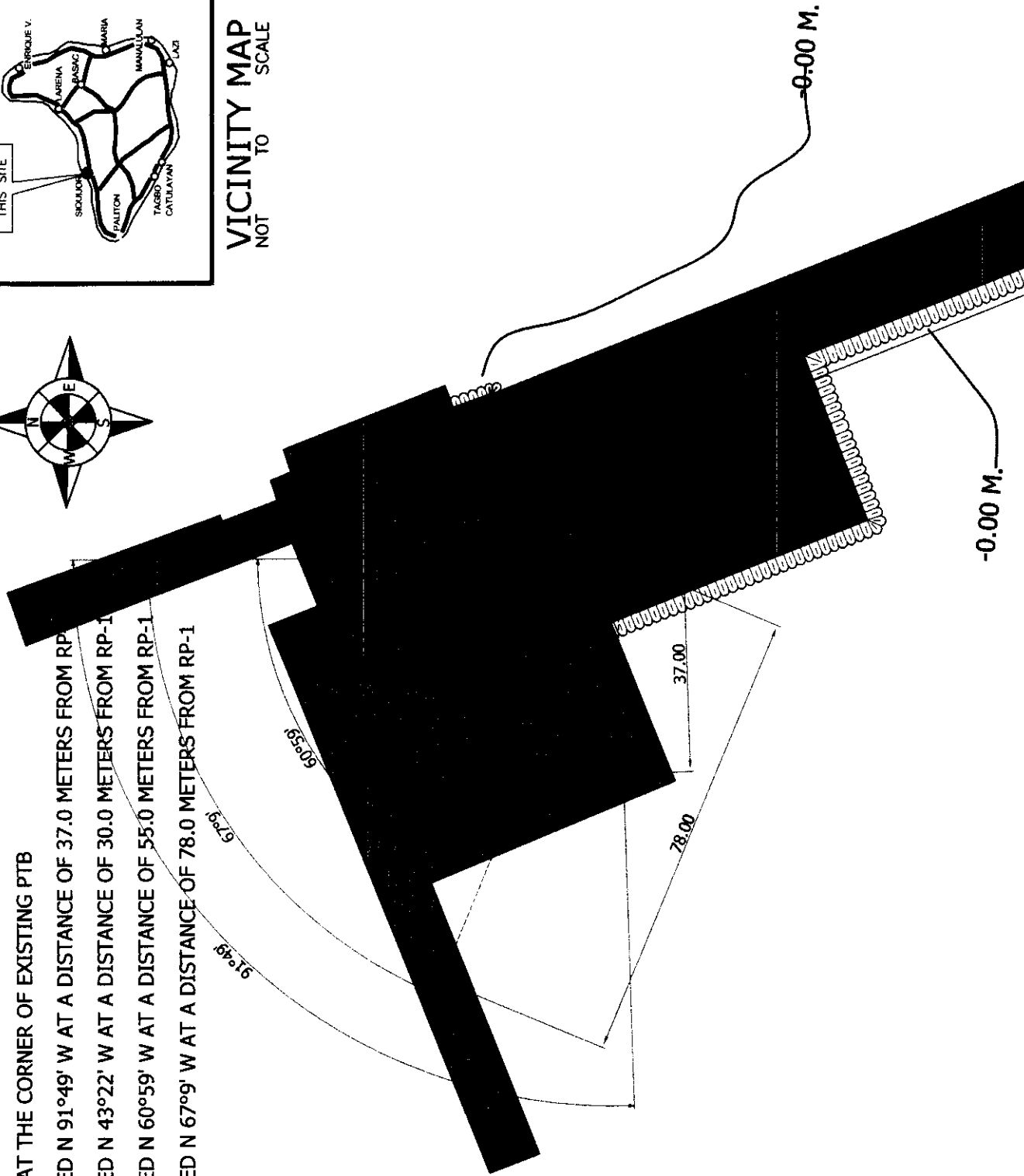

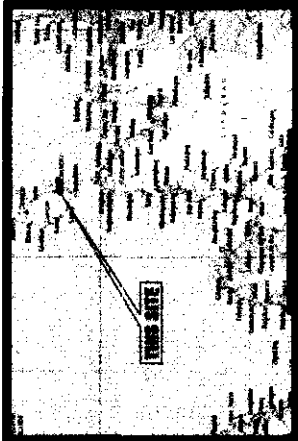
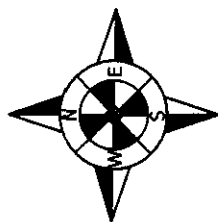

VICINITY MAP
NOT TO SCALE

BOREHOLE LOCATIONS:

- REFERENCE POINT #1 (BM-1) LOCATED 4.00 METERS FROM THE CORNER OF THE RORO RAMP
- BOREHOLE LOCATION #1 (BH-1) LOCATED S 37°53' W AT A DISTANCE OF 10.0 METERS FROM RP-1
- BOREHOLE LOCATION #2 (BH-2) LOCATED S 37°53' W AT A DISTANCE OF 31.0 METERS FROM RP-1
- BOREHOLE LOCATION #3 (BH-3) LOCATED S 37°53' W AT A DISTANCE OF 67.0 METERS FROM RP-1
- BOREHOLE LOCATION #4 (BH-4) LOCATED S 4°17' E AT A DISTANCE OF 90.0 METERS FROM RP-1

LEGEND:

- EXISTING STRUCTURE
- PROPOSED DEVELOPMENT
- REFERENCE POINT
- BOREHOLE LOCATIONS

DATE SURVEYED: MAY 18 - 22, 2013

PHILIPPINE PORTS
AUTHORITY
PORT PLANNING AND DESIGN DEPARTMENT
BOREHOLE LOCATIONS

PORT OF BENONI
BRGY. BENONI, MAHINOG, CAMIGUIN
SCALE: 1:1,000

BOREHOLE LOCATIONS:

- REFERENCE POINT #1 (BM-1) LOCATED AT THE MID POINT OF THE R.C. PIER
- BOREHOLE LOCATION #1 (BH-1) LOCATED N 58°33' E AT A DISTANCE OF 10.0 METERS FROM RP-1
- BOREHOLE LOCATION #2 (BH-2) LOCATED N 58°33' E AT A DISTANCE OF 23.0 METERS FROM RP-1
- BOREHOLE LOCATION #3 (BH-3) LOCATED N 58°33' E AT A DISTANCE OF 36.0 METERS FROM RP-1

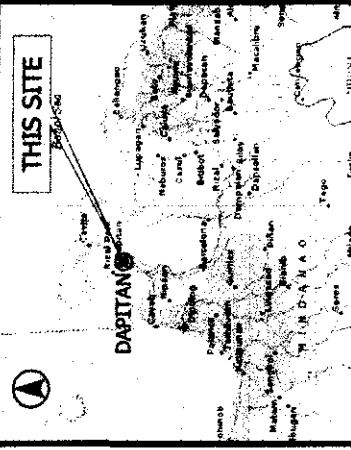
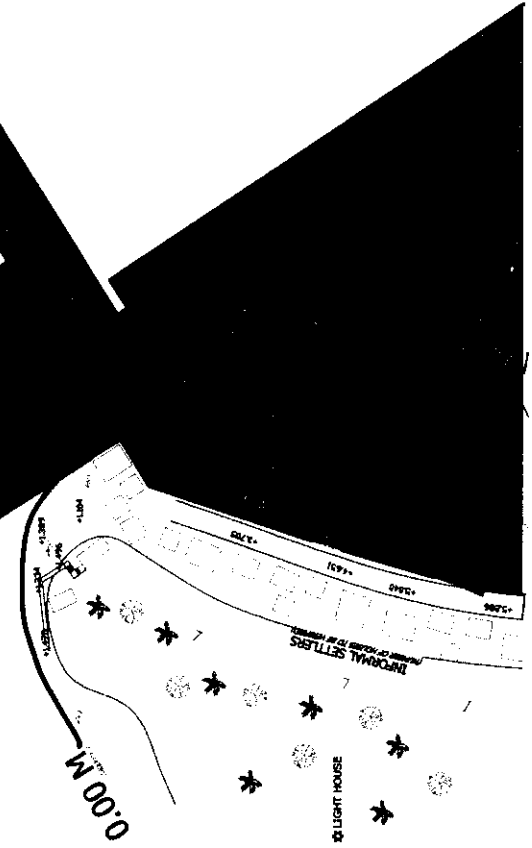
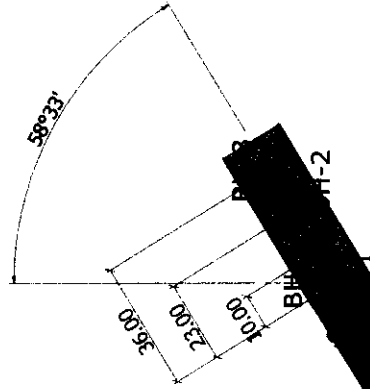

VICINITY MAP
NOT TO SCALE

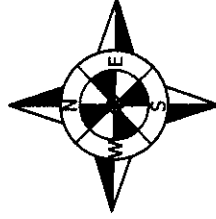

LEGEND:

- EXISTING STRUCTURE
- ONGOING CONSTRUCTION
- PROPOSED DEVELOPMENT
- REFERENCE POINT
- BOREHOLE LOCATIONS

DATE SURVEYED: MAY 08 - 12, 2014

PHILIPPINE PORTS
AUTHORITY
PORT PLANNING AND DESIGN DEPARTMENT
BOREHOLE LOCATIONS
PORT OF DAPITAN
PULAUAN, DAPITAN CITY, ZAMBOANGA DEL NORTE
SCALE: 1:2,000

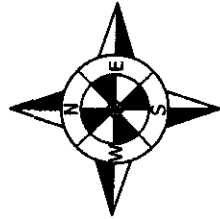
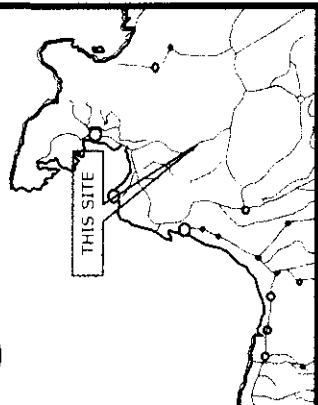

LEGEND:

- EXISTING STRUCTURE
- PROPOSED DEVELOPMENT
- REFERENCE POINT
- BOREHOLE LOCATIONS

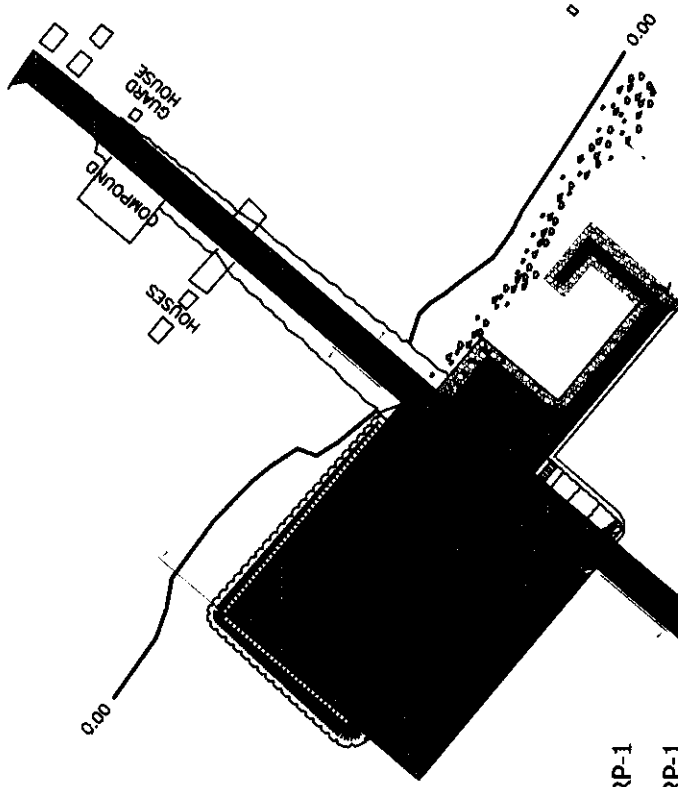

VICINITY MAP

NOT TO SCALE

BOREHOLE LOCATIONS:

- REFERENCE POINT #1 (BM-1) LOCATED AT THE MID POINT OF THE R.C. PIER
- BOREHOLE LOCATION #1 (BH-1) LOCATED S 40° 5' W AT A DISTANCE OF 19.0 METERS FROM RP-1
- BOREHOLE LOCATION #2 (BH-2) LOCATED S 40° 5' W AT A DISTANCE OF 37.0 METERS FROM RP-1
- BOREHOLE LOCATION #3 (BH-3) LOCATED S 40° 5' W AT A DISTANCE OF 56.0 METERS FROM RP-1

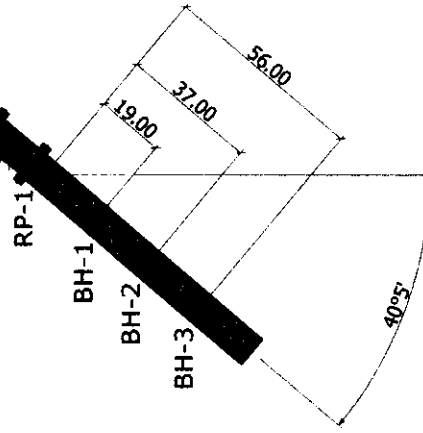

PORT PLANNING AND DESIGN DEPARTMENT
BOREHOLE LOCATIONS

PORT OF SINDANGAN
ZAMBOANGA DEL NORTE

SCALE:

1:2000

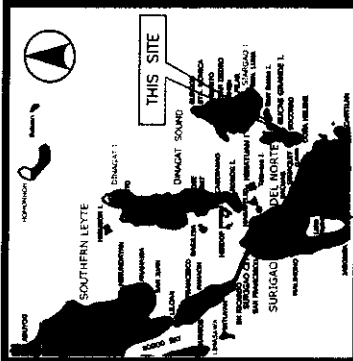

VICINITY MAP
NOT TO SCALE

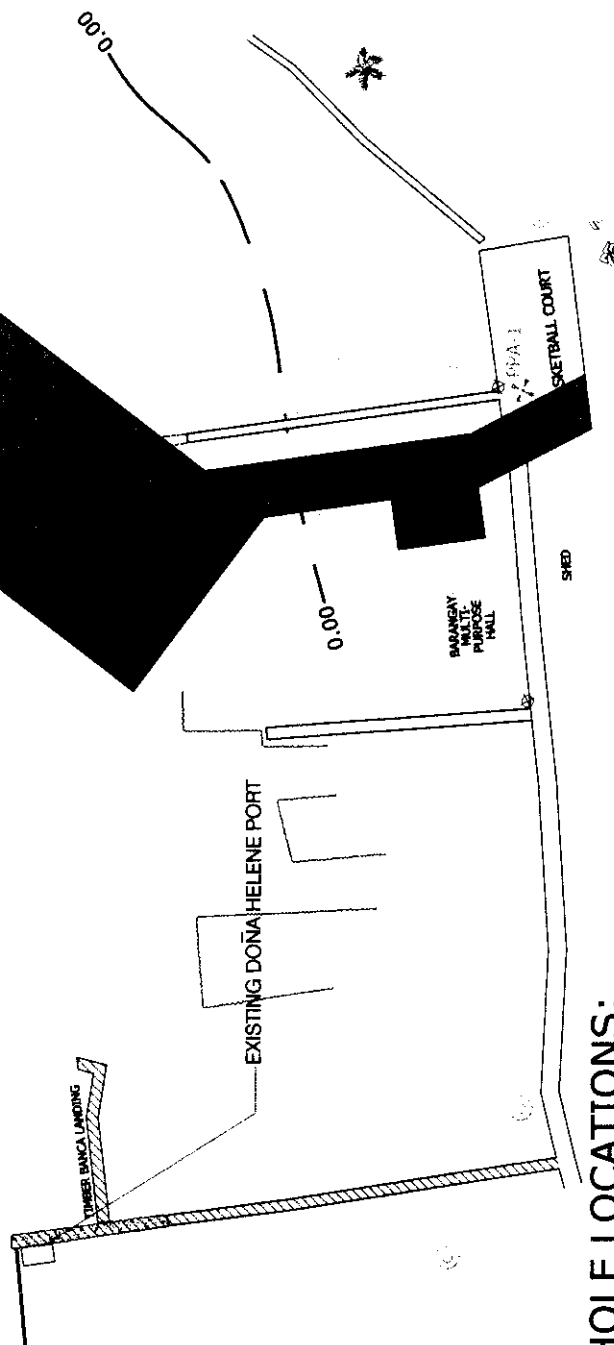
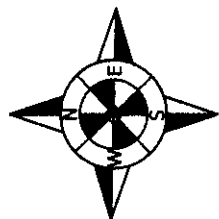

LEGEND:

- EXISTING STRUCTURE
- PROPOSED DEVELOPMENT
- REFERENCE POINT
- BOREHOLE LOCATIONS

BOREHOLE LOCATIONS:

- REFERENCE POINT #1 (BM-1) LOCATED 5.00 METERS FROM THE CORNER OF THE EXCESS AREA
- BOREHOLE LOCATION #1 (BH-1) LOCATED N 37° 6' E AT A DISTANCE OF 4.50 METERS FROM RP-1
- BOREHOLE LOCATION #2 (BH-2) LOCATED N 37° 6' E AT A DISTANCE OF 18.50 METERS FROM RP-1
- BOREHOLE LOCATION #3 (BH-3) LOCATED N 78° 6' E AT A DISTANCE OF 15.0 METERS FROM RP-1
- BOREHOLE LOCATION #4 (BH-4) LOCATED N 36° 1' W AT A DISTANCE OF 29.0 METERS FROM RP-1

DATE SURVEYED: SEPTEMBER 30 - OCTOBER 4, 2009

PHILIPPINE PORTS
AUTHORITY
PORT PLANNING AND DESIGN DEPARTMENT
BOREHOLE LOCATIONS

PORT OF DOÑA HELENE
BRGY. DOÑA HELENE, SOCORRO

SCALE: 1:1000

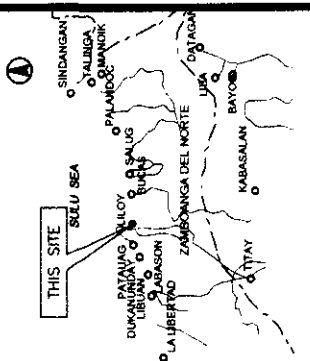

VICINITY MAP
NOT TO SCALE



LEGEND:

- EXISTING STRUCTURE
- PROPOSED DEVELOPMENT
- REFERENCE POINT
- BOREHOLE LOCATIONS

DATE SURVEYED:

PHILIPPINE PORTS AUTHORITY
PORT PLANNING AND DESIGN DEPARTMENT
BOREHOLE LOCATIONS

PORT OF LAMAO (LILOY)
LAMAO, LILOY, ZAMBOANGA DEL NORTE

SCALE: 1:1000

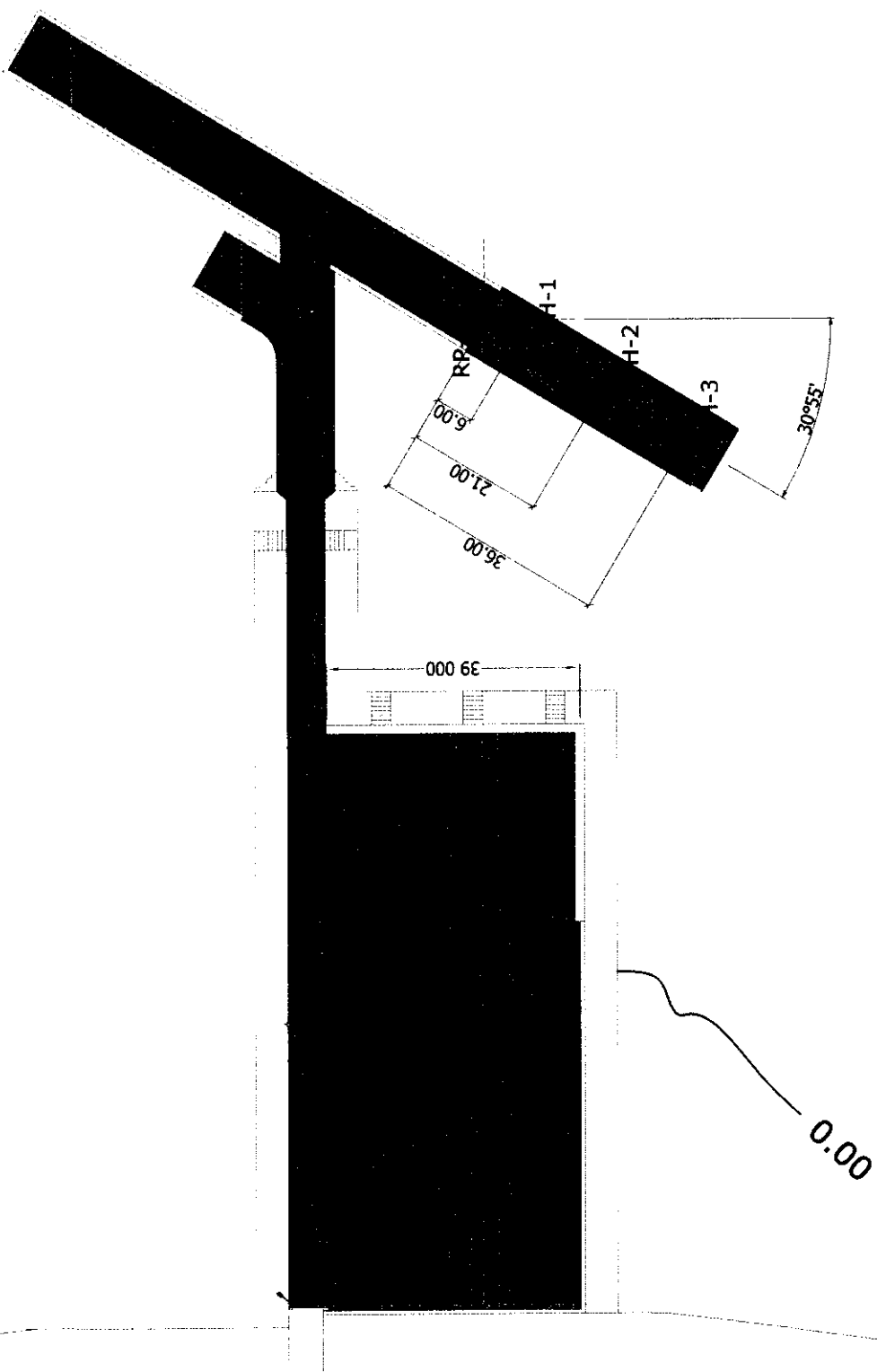

BOREHOLE LOCATIONS:

- REFERENCE POINT #1 (BM-1) LOCATED AT THE MID POINT OF THE R.C. PIER
- BOREHOLE LOCATION #1 (BH-1) LOCATED S 30°55' W AT A DISTANCE OF 6.0 METERS FROM RP-1
- BOREHOLE LOCATION #2 (BH-2) LOCATED S 30°55' W AT A DISTANCE OF 21.00 METERS FROM RP-1
- BOREHOLE LOCATION #3 (BH-3) LOCATED S 30°55' W AT A DISTANCE OF 36.0 METERS FROM RP-1

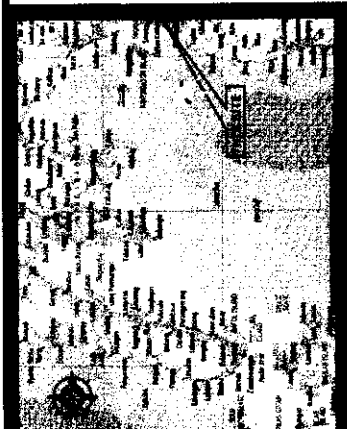

VICINITY MAP
NOT TO SCALE

BOREHOLE LOCATIONS:

- REFERENCE POINT #1 (BM-1) LOCATED 89.00 METERS FROM THE CORNER OF THE R.C. PIER
- REFERENCE POINT #2 (BM-2) LOCATED AT THE MID POINT OF THE R.C. PIER
- BOREHOLE LOCATION #1 (BH-1) LOCATED S 55°44' E AT A DISTANCE OF 13.0 METERS FROM RP-1
- BOREHOLE LOCATION #2 (BH-2) LOCATED S 17°15' W AT A DISTANCE OF 16.0 METERS FROM RP-1
- BOREHOLE LOCATION #3 (BH-3) LOCATED S 29°32' W AT A DISTANCE OF 7.0 METERS FROM RP-2
- BOREHOLE LOCATION #4 (BH-4) LOCATED S 29°32' W AT A DISTANCE OF 22.0 METERS FROM RP-2

DATE SURVEYED:

LEGEND:

- EXISTING STRUCTURE
- PROPOSED DEVELOPMENT
- REFERENCE POINT
- BOREHOLE LOCATIONS



PORT PLANNING AND DESIGN DEPARTMENT
BOREHOLE LOCATIONS

PORT OF SULTAN NAGA DIMAPORO

BRGY. POBLACION, SULTAN NAGA DIMAPORO, LANAO DEL NORTE

SCALE:

1:1000

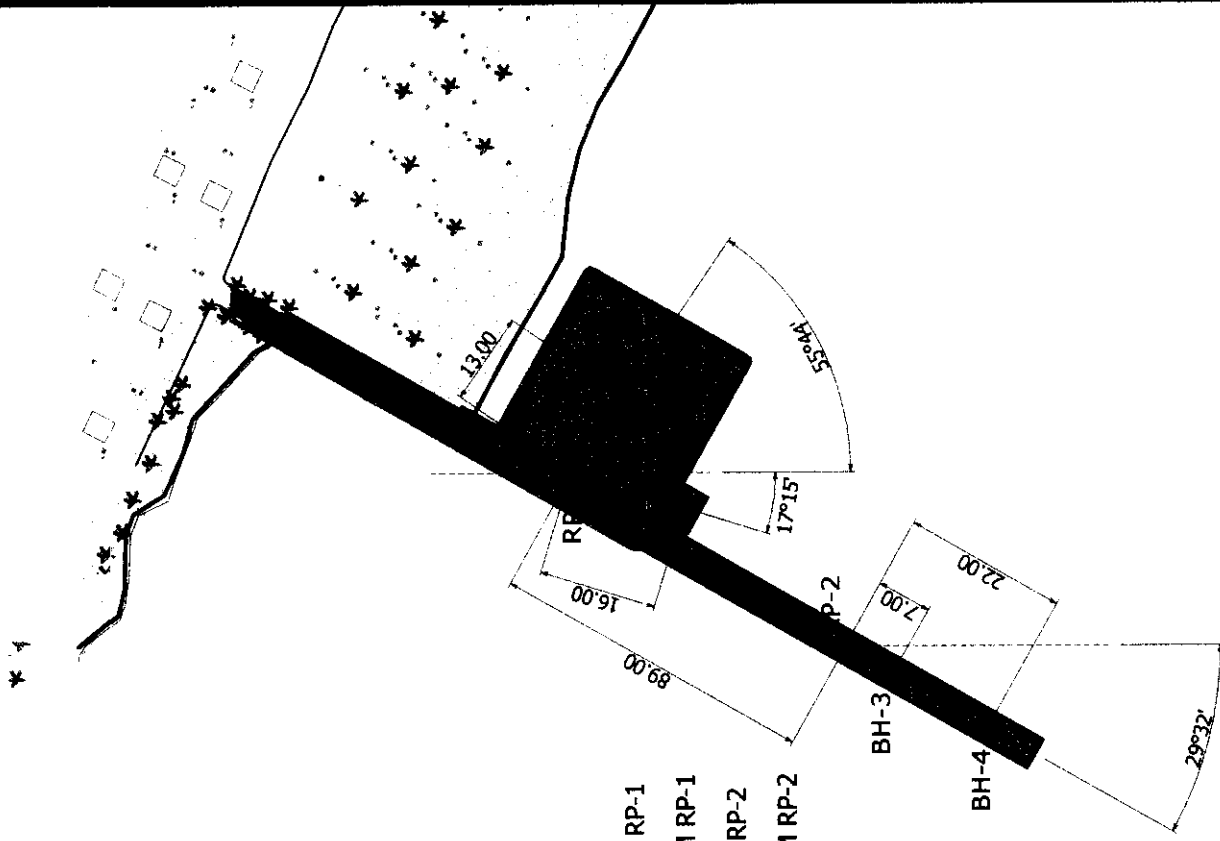

Section VIII. APPENDICES

Section VIII. Appendices

1. Description of Services

Give detailed descriptions of the Services to be provided, dates for completion of various tasks, place of performance for different tasks, specific tasks to be approved by Client, etc.

2. Reporting Requirements

List format, frequency, and contents of reports; persons to receive them; dates of submission; etc. If no reports are to be submitted, state here "Not applicable."

3. Key Personnel and Subconsultants

List under:

1. Titles [and names, if already available], detailed job descriptions and minimum qualifications, and staff-months of service, and estimated periods of engagement for each, including a copy of a satisfactory medical certificate.
2. Same information as in no. 1 for Key foreign Personnel to be assigned to work outside the Government's country.
3. Same information as in no.1 for Key Local Personnel.
4. List of approved Subconsultants (if already available) and Counterpart personnel (if allowed); same information with respect to their Personnel as in no.'s 1 and 2.

4. Breakdown of Contract Price

List here the elements of cost, including expenditures in foreign currency(ies) denominated and payable in Philippine Peso, used to arrive at the itemized breakdown of the contract price:

1. Monthly rates for Personnel (Key Personnel and other Personnel)
2. Reimbursable expenditures
3. Applicable taxes

5. Services and Facilities Provided by the Client

Give detailed description of the services and facilities made available to the Consultant, and the time and manner of its availment.

6. Consultant's Representations Regarding Costs and Charges

Breakdown of Remuneration Rates, WB funded projects using Quality Based Selection, Selection Based on the Consultant's Qualifications and Single Source Selection.

1. Review of Remuneration Rates

1.1 The remuneration rates for staff are made up of salary, social costs, overheads, fee that is profit, and any premium or allowance paid for projects away from headquarters. To assist the Consultant in preparing for financial negotiations, a sample form giving a breakdown of rates is attached (no financial information should be included in the Technical Proposal). Agreed breakdown sheets shall form part of the negotiated contract.

1.2 The Procuring Entity is charged with the custody of Government funds and is expected to exercise prudence in the expenditure of these funds. The Procuring Entity is, therefore, concerned with the reasonableness of the firm's Financial Proposal, and, during negotiations, it expects to be able to review audited financial statements backing up the Consultant's remuneration rates, certified by an independent auditor. The Consultant shall be prepared to disclose such audited financial statements for the last three years, to substantiate its rates, and accept that its proposed rates and other financial matters are subject to scrutiny. Rate details are discussed below.

(i) Salary

This is the gross regular cash salary paid to the individual in the Consultant's home office. It shall not contain any premium for work away from headquarters or bonus (except where these are included by law or government regulations).

(ii) Bonus

Bonuses are normally paid out of profits. Because the Procuring Entity does not wish to make double payments for the same item, staff bonuses shall not normally be included in the rates. Where the Consultant's accounting system is such that the percentages of social costs and overheads are based on total revenue, including bonuses, those percentages shall be adjusted downward accordingly. Where national policy requires that thirteen (13) months' pay be given for twelve (12) months' work, the profit element need not be adjusted downward. Any discussions on bonuses shall be supported by audited documentation, which shall be treated as confidential.

(iii) Social Costs

Social costs are the costs to the Consultant of staff's non-monetary benefits. These items include, *inter alia*, pension, medical and life insurance costs, and the cost of a staff member being sick or on vacation. In this regard, the cost of leave for public holidays is not an acceptable social cost nor is the cost of leave taken during the Contract if no additional staff replacement has been provided. Additional leave taken at the end of the Contract in accordance with the Consultant's leave policy is acceptable as a social cost.

(iv) Cost of Leave

The principles of calculating the cost of total days leave per annum as a percentage of basic salary shall normally be as follows:

$$\text{Leave cost as percentage of salary}^{11} = \frac{\text{total days leave} \times 100}{[365 - w - ph - v - s]}$$

It is important to note that leave can be considered a social cost only if the Procuring Entity is not charged for the leave taken.

(v) Overheads

Overhead expenses are the firm's business costs that are not directly related to the execution of the project and shall not be reimbursed as separate items under the Contract. Typical items are home office costs (partner's time, non-billable time, time of senior staff monitoring the project, rent, support staff, research, staff training, marketing, etc.), the cost of staff not currently employed on revenue-earning projects, and business promotion costs. During negotiations, audited financial statements, certified as correct by an independent auditor and supporting the last three years' overheads, shall be available for discussion, together with detailed lists of items making up the overheads and the percentage by which each relates to basic salary. The Procuring Entity does not accept an add-on margin for social charges, overhead expenses, etc., for staff who are not permanent employees of the firm. In such case, the firm shall be entitled only to administrative costs and fee on the monthly payments charged for subcontracted staff.

(vi) Fee or Profit

The fee or profit shall be based on the sum of the salary, social costs, and overhead. If any bonuses paid on a regular basis are listed, a corresponding reduction in the profit element shall be expected. Fee or profit shall not be allowed on travel or other reimbursable expenses, unless in the latter case an unusually large amount of procurement of equipment is required. The Consultant shall note that payments shall be made against an agreed estimated payment schedule as described in the draft form of the Contract.

¹¹ Where w = weekends, ph = public holidays, v = vacation, and s = sick leave.

(vii) Away from Headquarters Allowance or Premium

Some consultants pay allowances to staff working away from headquarters. Such allowances are calculated as a percentage of salary and shall not draw overheads or profit. Sometimes, by law, such allowances may draw social costs. In this case, the amount of this social cost shall still be shown under social costs, with the net allowance shown separately. For concerned staff, this allowance, where paid, shall cover home education, etc.; these and similar items shall not be considered as reimbursable costs.

(viii) Subsistence Allowances

Subsistence allowances are not included in the rates, but are paid separately and in local currency. No additional subsistence is payable for dependents --- the subsistence rate shall be the same for married and single team members.

UNDP standard rates for the particular country may be used as reference to determine subsistence allowances.

2. Reimbursables

2.1 The financial negotiations shall further focus on such items as out-of-pocket expenses and other reimbursables. These costs may include, but are not restricted to, cost of surveys, equipment, office rent, supplies, international and local travel, computer rental, mobilization and demobilization, insurance, and printing. These costs may be either fixed or reimbursable in foreign or local currency.

3. Bank Guarantee

3.1 Payments to the Consultant, including payment of any advance based on cash flow projections covered by a bank guarantee, shall be made according to an agreed estimated schedule ensuring the firm regular payments in local and foreign currency, as long as the services proceed as planned.

7. BREAKDOWN OF AGREED FIXED RATES¹²

[Currencies: _____¹³]

Consultants		1	2	3	4	5	6	7	8
Name	Position	Basic Rate ¹⁴	Social Charge (__% of 1)	Overhead (__% of 1)	Subtotal	Fee (__% of 4)	Away from Headquarters Allowance (__% of 1)	Total Agreed Fixed Rate	Agreed Fixed Rate (__% of 1)
Philippines									
Home Office									
Signature of Consultant:									

Authorized Representative: _____ Date: _____
Title: _____ Name: _____

¹² This model form is given for negotiation purposes only. It is not part of the proposals (technical or financial).
¹³ If different currencies, a different table for each currency should be used.
¹⁴ Per month, day, or hour as appropriate.

OFFICE EQUIPMENT SPECIFICATIONS

1. **Laptop Computer (2 unit)** – Internationally branded laptop computer – 6th Generation Intel Core i7-6700HQ Processor (6M Cache, up to 3.50GHz); 15.6-inch IPS Full HD 1080P Display; 16GB DDR4; GeForce GTX970M 6GB GDDR5; 2TB HDD; AC 802.11a/b/g/n/ac wireless LAN; Four USB 3.0 ports with HDCP support Headphone and speaker jacks, Ethernet (RJ-45) port and SDTM Card reader; Super Multi DVD; HD Web Camera; 8-cell Li-ion battery pack.

Including software: Microsoft Windows 10 Professional (64-bit), Microsoft Office Home & Business 2016 and Antivirus.

2. **Computer Printer (2 units)** – Internationally branded printer – Multi-function A3 inkjet colour printer; 128MB memory; 2.7" Touchscreen Colour LCD with Touch Sensitive Control; USB 2.0 Hi-Speed, Ethernet 10/100 Base-TX and Wireless LAN (IEEE 802.11b/g/n) Interfaces; Print resolution up to 1200 x 6000 dpi; Print Speed, Black at 22PPM and Colour at 20 PPM; Paper Sizes (A3, A4, Letter, Legal, etc..) A3 Automatic Double-sided printing; Multi-copy (Stack) up to 99 copies; Enlargement/Reduction (25% to 400%); 250-Sheets paper input tray with single sheet rear bypass tray; Automatic Document Feed (ADF) up to 35-sheets.