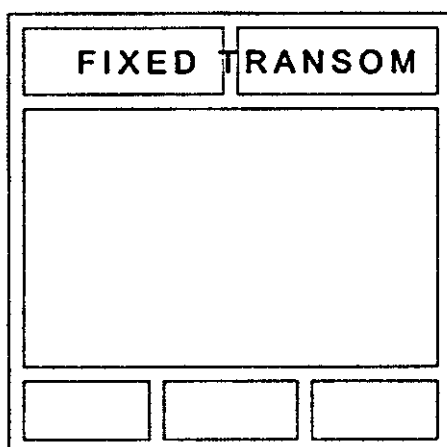
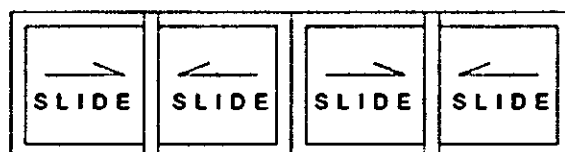
**W4**

TYPE:	ALUM WINDOW POWDER COATED FIN W/ 6.35mm REFLECTIVE GLASS
LOCATION:	SNACK COUNTER
SET:	4

**W5**

TYPE:	ALUM WINDOW POWDER COATED FIN W/ 6.35mm REFLECTIVE GLASS
LOCATION:	TICKETING OFFICE
SET:	2

**W6**

TYPE:	ALUM WINDOW POWDER COATED FIN W/ 6.35mm REFLECTIVE GLASS
LOCATION:	TOILET
SET:	2

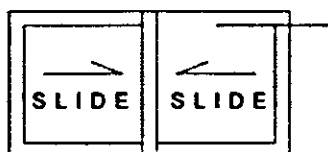
**W7**

TYPE:	ALUM WINDOW POWDER COATED FIN W/ 6.35mm REFLECTIVE GLASS
LOCATION:	TOILET
SET:	2

ITEM 8 : Replacement of Damaged Plumbing Fixtures**DESCRIPTION**

The work includes replacement of damaged plumbing fixtures and installation.

SPECIFICATION

The Water Closet, and Lavatory with accessories shall be installed as designated by the Engineer.

ITEM 9 : ELECTRICAL WORKS

SCOPE OF WORK

The work to be done shall consist of furnishing, delivering, and installing electrical materials/fixtures completed in accordance with all the details of the electrical works as shown on the drawings including materials, labor, tools and equipment and all incidental works as found necessary.

Refer to electrical plans/drawings for location and extent of work involved.

GENERAL REQUIREMENTS

- a) All works shall be done in accordance with the requirements of the publications and agencies having jurisdiction, as well as the requirements of the approved standards.
 1. National Fire Protection Association - (NFPA)
 2. National Electrical Manufacturer Association - (NEMA)
 3. Underwriter Laboratories, Inc. - (UL)
 4. Philippine Electrical Code - (PEC)
Philippine National Standard - (PNS)
 5. Federation Specification:
Circuit Breaker, Molded Case, Branch
Circuit and Service
 6. American National Standard Institute - (ANSI)
 7. American Society for Testing and Materials - (ASTM)
 8. Illuminating Engineering Society - (IES)
 9. Light Emitting Diode - (LED)
- b) The Contractor shall employ a licensed Registered Electrical Engineer or Master electrician to perform or to supervise and to conduct the continuous inspection of all electrical work.
- c) The Contractor shall first obtain approval from the Authority before procurement, fabrication or delivery of electrical materials to the site. Partial submittals will not be acceptable and will be returned without review. Submittals shall include the Manufacturer's Name, Trade Name, Place of Manufacture, Catalog Model or Number, Nameplate Data, Size, Layout Dimensions, Capacity, Project Specification and Paragraph Reference, Technical Society Publication References and other information necessary to establish contract compliance of each item to be furnished.
- d) The materials and equipment to be furnished shall be standard products of reputable manufacturer engaged in the reproduction of such materials and equipment.
- e) All permits and electrical fees required for this work shall be obtained at the expense of the Contractor. The Contractor shall furnish the Engineer-in-Charge, the final Certificates of Inspections and approval from the proper government authorities after the completion

of work. The Contractor shall prepare all as-built plans and all other paper works as required by the enforcing authorities.

- f) The Contractor shall furnish and install electrical materials as shown in the drawings. A licensed Electrical Engineer or Master Electrician is required to implement the installation of the electrical system.
- g) Electrical installation shall conform to the requirements of Philippine Electrical Code (PEC) and the other approved standards.
- h) The contractor shall install all electrical works with the supervision of the qualified Registered Electrical Engineer (REE) or Master Electrician. All electrical installation applications regardless of capacity and voltage whether new, addition or revision shall be accompanied by electrical plans signed and sealed by a duly licensed Professional Electrical Engineer (PEE).

MATERIAL REQUIREMENTS

Fluorescent Lamp 2 X 40W with luminaire Surface type
Fluorescent Lamp 1 X 40W with luminaire Surface type
Low Bay Light
Panel Board 16 Branches, 30A
Weatherproof Switch
Weatherproof Outlet

EXECUTION

INSTALLATION

The work throughout shall be executed in the best and most thorough manner under the direction of and at the satisfaction of the Registered Electrical Engineer or Master Electrician, who will interpret the intent meaning of the drawings and specification and shall have the power to reject any work and materials which in his judgment, are not in full accordance therewith.

TESTING OPERATIONS

When the electrical installation is completed, the Contractor shall test the installed electrical materials and equipment in the presence of Registered Electrical Engineer or Master Electrician. The system shall be free from any defects, shorts or grounds. The Contractor at no extra cost shall furnish all necessary instruments and personnel required for the testing.

ITEM 10 : REPAINTING WORKS**SCOPE OF WORK**

This specification covers the requirements for repainting works on masonry, concrete structures, steel, and roofing.

MATERIAL REQUIREMENTS**STEEL OR IRON**

(a) Coatings, such as inorganic silicate cementitious products, sulphur concrete, polysulfides, and others offer protection to concrete exposed to atmospheric and aggressive environments such as secondary containment structures

(b) Cementitious coatings Protective coatings that are in the form of decorative products which are usually modified with latex for use in mild chemical exposure conditions. Certain inorganic silicate cements may be used to waterproof concrete from the positive or negative side.

(c) Thin film urethanes Protective coatings (up to 0.13 mm (5 mils) per coat) that are used to seal concrete for nondusting, cleanability, graffiti resistance, and resistance to mild chemicals. They are used for dry interior exposures on walls and floors that have moderate physical abuse and for exterior weathering. Urethanes are available in two (2) forms: aliphatic urethanes for color and gloss retention in exterior sunlight exposure and aromatic urethanes for exposures other than sunlight and Ultraviolet (UV) light, or where ambering and chalking are acceptable.

(d) Epoxy polyesters Protective coatings that are composed of thin film coatings (up to 0.08 mm (3 mils) per coat) designed for color, non-dusting, cleanability, and resistance to water for a brief period. They are used primarily for interior and exterior exposures on walls that experienced little physical abuse.

(e) Latexes Protective coatings that are used for color, appearance, and cleanability. For exterior use, acrylic latexes provide improved color and gloss retention (vinyl latexes are not normally recommended because they tend to hydrolyze under high pH situations). Elastomeric formulations (e.g., acrylic, silicone), which provide waterproofing and crack bridging properties, are also available.

(f) Chlorinated rubbers Protective coatings that are thin film coatings designed for color, no dusting, cleanability and resistance to water and mild chemicals. Chlorinated rubbers may chalk on exterior weathering exposures unless modified.

(g) Epoxies Protective coating consisting of two component products that are available in thin film (less than 0.25 mm (10 mils) and thick film (0.25 mm to 1.27 mm (10 mils to 50 mils) coatings. Epoxies have excellent adhesion to dry concrete and epoxies have the ability to seal porous concrete and bug holes. Epoxies also exhibit good chemical resistance, hardness, and abrasion resistance. Epoxies are typically used for interior chemically and physically abused conditions because they tend to chalk and fade in atmospheric and sunlight exposures. Epoxy formulations that develop good adhesion to wet surfaces are also available.

(h) Epoxy phenolics Protective coatings consisting of two component products similar to epoxies. They are phenolic modified to improve their chemical resistance. They are normally used for severe chemical environments and as floor coatings.

- (i) Aggregate-filled epoxies Protective coatings that are thick film coatings (3.18 mm (125 mils) or more thickness) that are usually applied by spray, trowel, or aggregate broadcast methods. They are normally used in areas of severe physical abuse. These epoxies are also resistant to mild and severe chemicals and are excellent floor coatings for areas of severe physical abuse. Floor toppings can be made aesthetically pleasing through selection of the appropriate color and type of aggregates.
- (j) Thick film elastomers Protective coatings (up to 3.18 mm (125 mils)), such as urethane (ASTM 016 Type V) and polysulfide which are normally applied by spray, trowel, or self-leveling methods. They are normally used in areas of severe physical abuse that require a flexible coating, the rubber-like film displays excellent resistance to impact damage and the ability to bridge hairline cracks in concrete.
- (k) Epoxy- or urethane-coal tars Protective coatings that are moderately thick coatings (0.38 mm to 0.76 mm (15 mils to 30 mils)) with excellent water and good chemical resistance that are normally applied with a sprayer. The black color may restrict their usage for aesthetic reasons.
- (l) Vinylesters and polyesters Protective coatings that are moderately thick coatings (0.76 mm to 1.27 mm (30 mils to 50 mils)) with excellent resistance to acids and strong oxidizers that are applied by spray or trowel. Thicker films may be obtained with silica floor fillers and reinforcing fabric or mat.

EXECUTION

All concrete surfaces shall be sound, clean, and dry before protective coating is applied. Surface contaminants such as oils, dirt, curing compounds, and efflorescence which would prevent protective coating penetration, adhesion, or drying shall be removed. The use of membrane forming curing compound is not allowed wherever this treatment is to be applied. The contractor shall apply the protective coating as soon as possible after completion of a structure or portions thereof.

The manufacturer's recommended application rate and method of application shall be followed when a protective coating is applied to concrete. The surface profile and porosity will have an effect on the application rate. A test patch is useful in determining the surface preparation, application rate, and appearance of a particular concrete coating. Before the beginning of application, the Contractor shall submit to the Engineer the documentation of the procedures to be used which shall include, but not limited to, the identification of the product to be used by brand name and name of the manufacturer and copy of the manufacturer's authorized applicator certificate for the personnel approved to perform the work.

The temperature of the concrete shall be constant or dropping when some protective coatings are applied to avoid blisters or pin holes caused by the expansion of gases inside of the concrete. The temperature of the concrete shall be above the dew point while the coating is curing to prevent water condensation on the coating.

In bridge superstructure, the protective coating shall be applied after concrete in the bridge deck has cured and has completed an initial drying period of a minimum of 14 days, unless otherwise directed by the Engineer. Also, protective coating shall be applied to exposed concrete roadway surfaces of bridge decks such as curbs, sidewalks, divisors and concrete median barriers; and to inside and top surfaces of parapets.

Coating thicknesses shall range from a few mils to 3 mm (125 mils) or more, depending on the purpose of the coating. Thin coatings «1 mm (40 mils)» are normally used for dampproofing, mild chemical attack, and for decorative coatings. Thick coatings (>1mm (40 mils)» are used for waterproofing, as protection against severe chemical attack, and as protection from physical damage.

If excessive cracking of bridge deck(s) occurs, additional protective coating shall be applied (two coats) to the deck as specified and as directed by the Engineer.

Delivery, Storage and Handling

- (a) All materials shall be kept dry, protected from weather and stored under cover.
- (b) Protective coating materials shall be stored according to manufacturer's recommendations. Do not store them near flame, heat or strong oxidants.
- (c) Repair and protective coating materials shall be handled according to their material safety data sheets

ITEM 11 : SAFETY SIGNAGES AND BARRICADES

DESCRIPTION

This work includes the furnishing and installing of safety signages and barricades in accordance with the specifications and to the details shown below in the drawings, or as directed by the Engineer.

SPECIFICATION

The Signage's and Barricades shall be installed at location(s) designated by the Engineer.

The sizes of the standard signages shall be 2-2/3ft x 4ft (800mm X 1,200mm) for fixed type and 2ft x 2-2/3ft (600mm x 800mm) for mobile type. For barricade standard 2ft x 2-2/3ft (600mm x 800mm) shall be provided.

The materials to be used for signages and barricades are ½ inch (12mm) marine plywood or tarpaulin poster on 2" x 2" (50mm x 50mm) good lumber frame (see drawing below).

The printing or painting shall be the discretion of the Engineer.

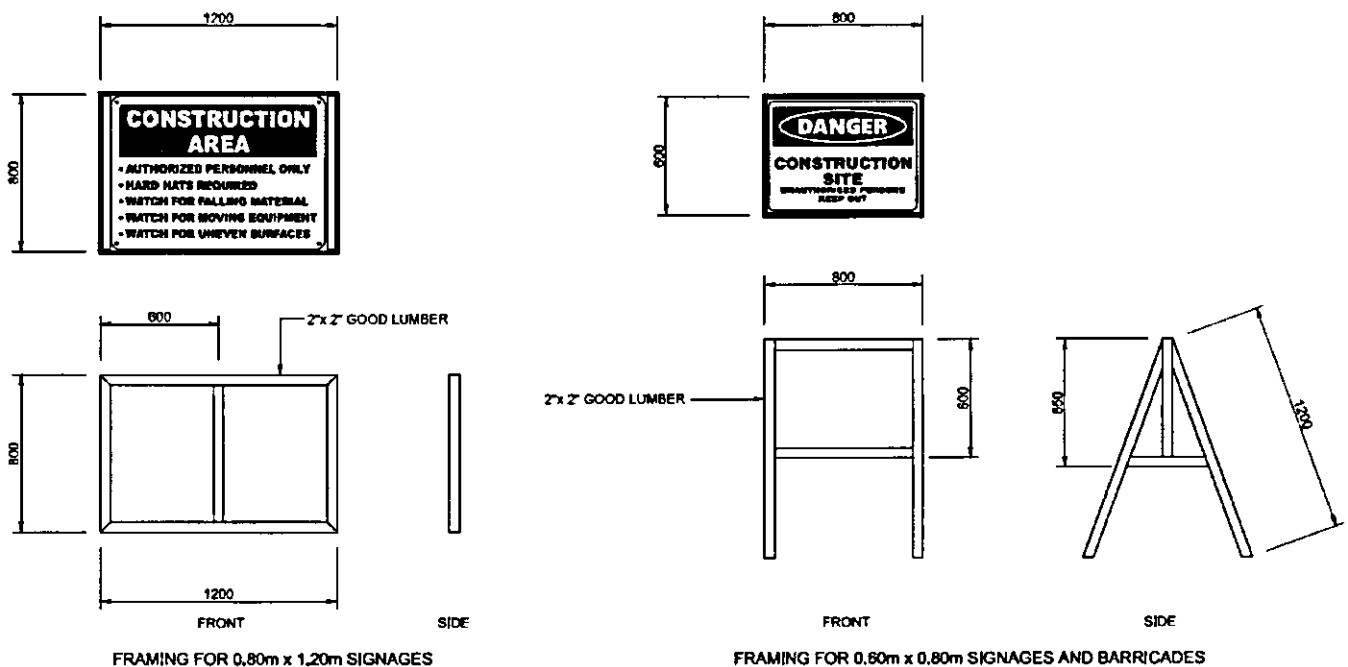

STANDARD PLAN FOR SIGNAGES AND BARRICADES

ITEM 12 : PROJECT BILLBOARD**SPECIFICATION**

The Project Billboard shall be installed at location(s) designated by the Engineer.

The size and specifications of materials for the standard billboard shall be 4ft. x 8ft. (1,200mm x 2,400mm) using ½ inch (12mm) marine plywood or tarpaulin poster on 3/16 inch (5mm) marine plywood.

Project billboards shall not contain Name(s) and/or picture(s) of any personages.

See attached drawings for further details of the standard billboard.

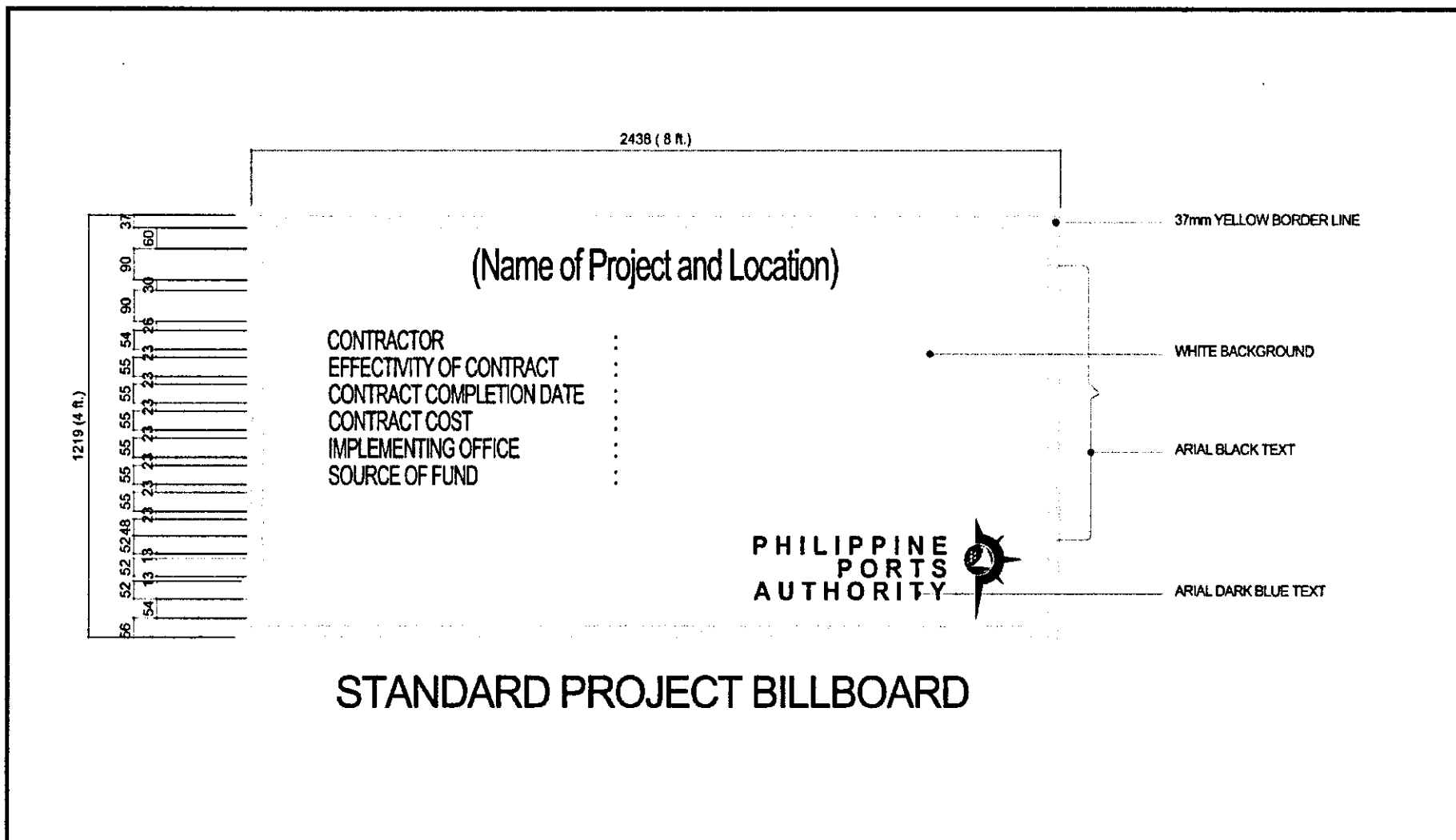

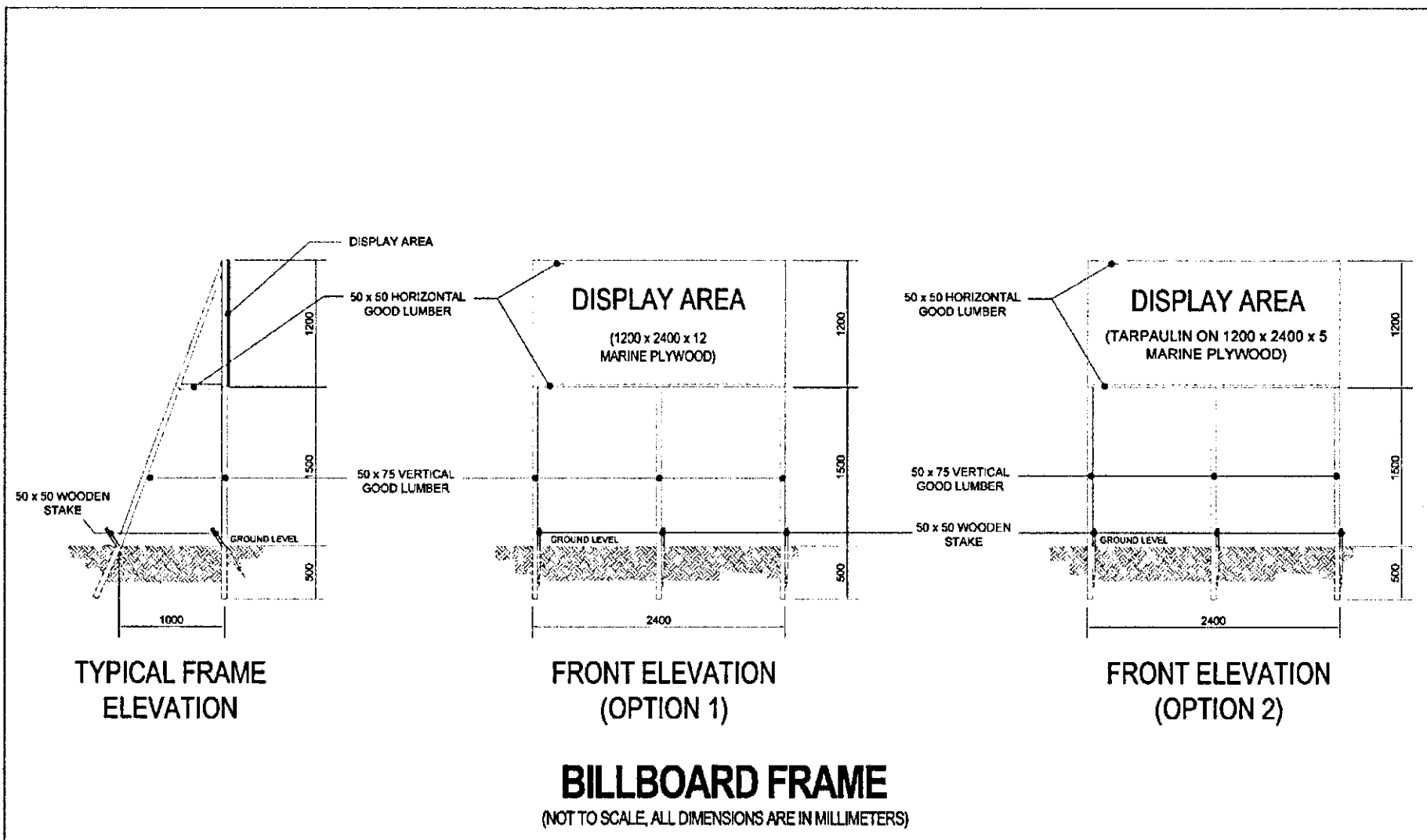

SECTION VII

*DRAWINGS
(APPROVED PLANS)*

SECTION VII

DRAWINGS AND APPROVED PLANS (SEE ISSUED APPROVED PLANS)

LIST OF DRAWINGS:

- 1 of 6 - Port Layout Plan. Section 1, Section 2, Section 3
- 2 of 6 - Section 4, Section 5, Section 6, Spot Detail, Longitudinal Construction Section Joint, Transverse Construction Joint, typical Pavement Joint
- 3 of 6 - Floor Plan of Port Terminal Building
- 4 of 6 - Lighting Layout Plan
- 5 of 6 - Schedule of Doors, Detail of Skylight
- 6 of 6 - Schedule of Windows

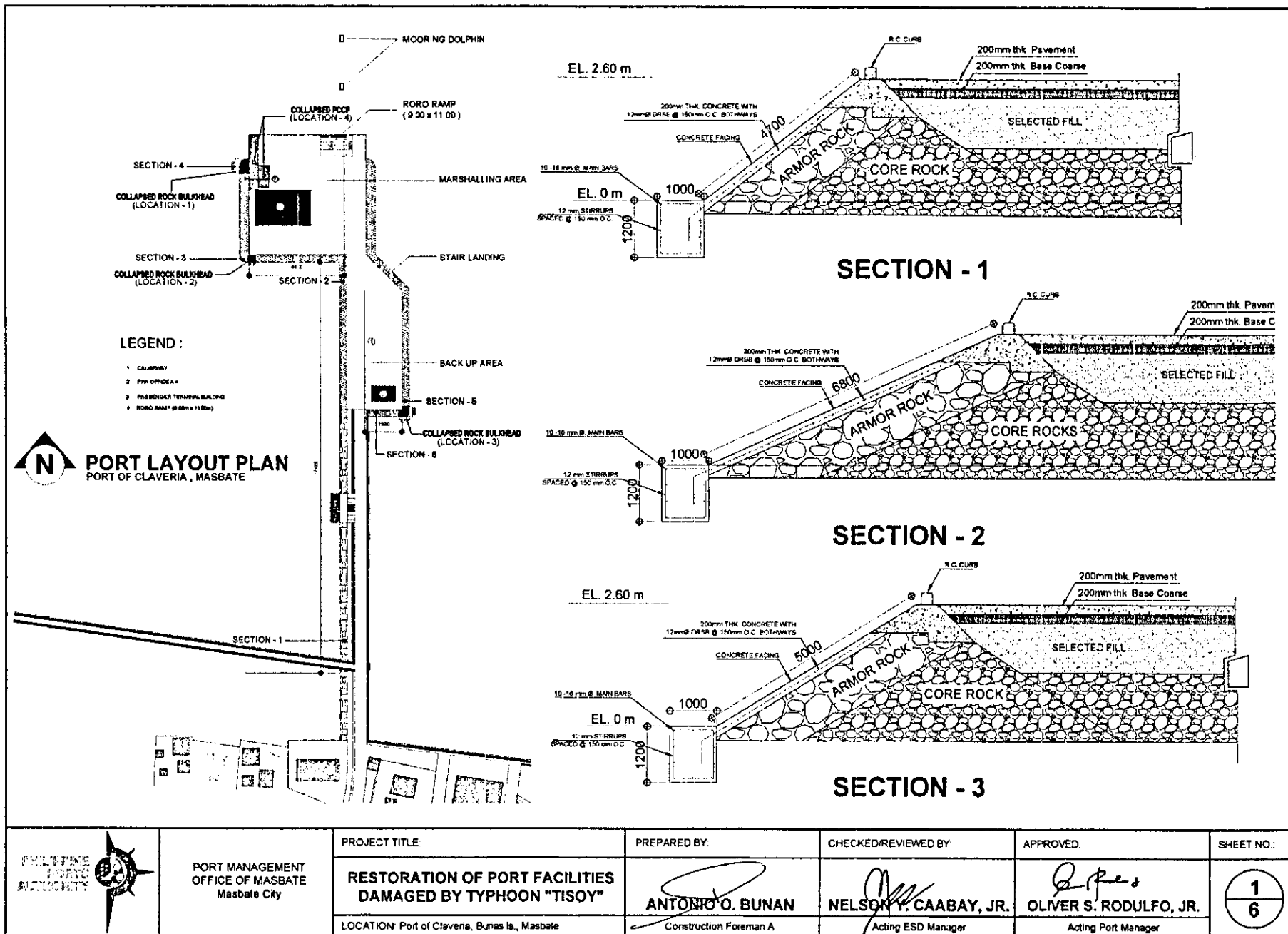

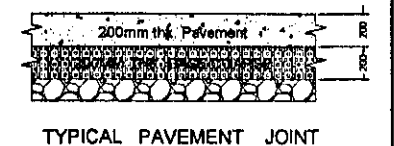
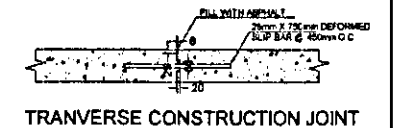
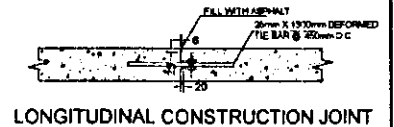
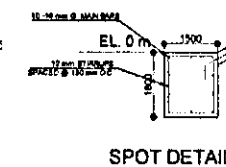
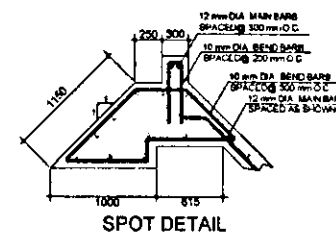
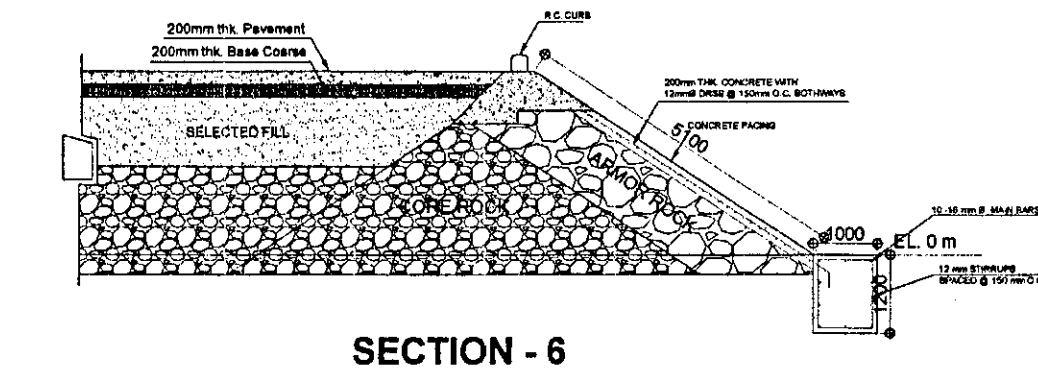
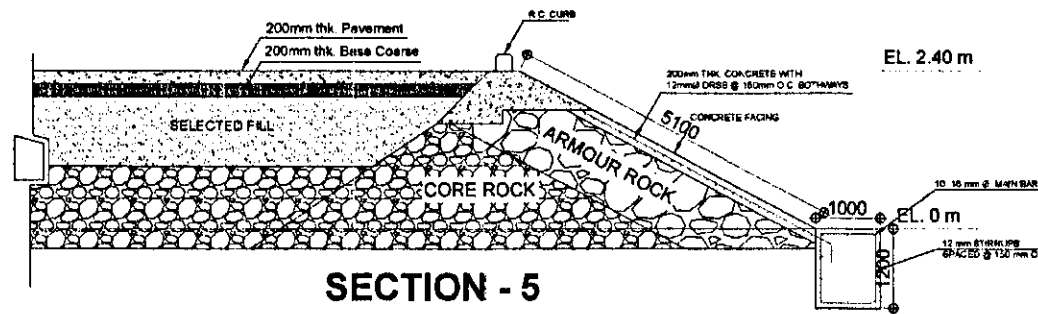
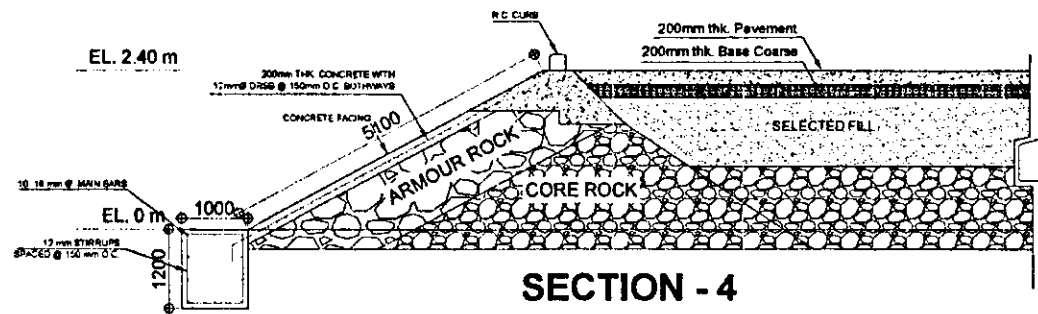

	PORT MANAGEMENT OFFICE OF MASBATE Masbate City	PROJECT TITLE: RESTORATION OF PORT FACILITIES DAMAGED BY TYPHOON "TISOY" LOCATION: Port of Claveria, Burias Is., Masbate	PREPARED BY: ANTONIO O. BUNAN Construction Foreman A	CHECKED/REVIEWED BY: NELSON Y. CAABAY, JR. Acting ESD Manager	APPROVED: OLIVER S. RODULFO, JR. Acting Port Manager	SHEET NO.: 2 6
--	---	---	---	--	---	---------------------------------

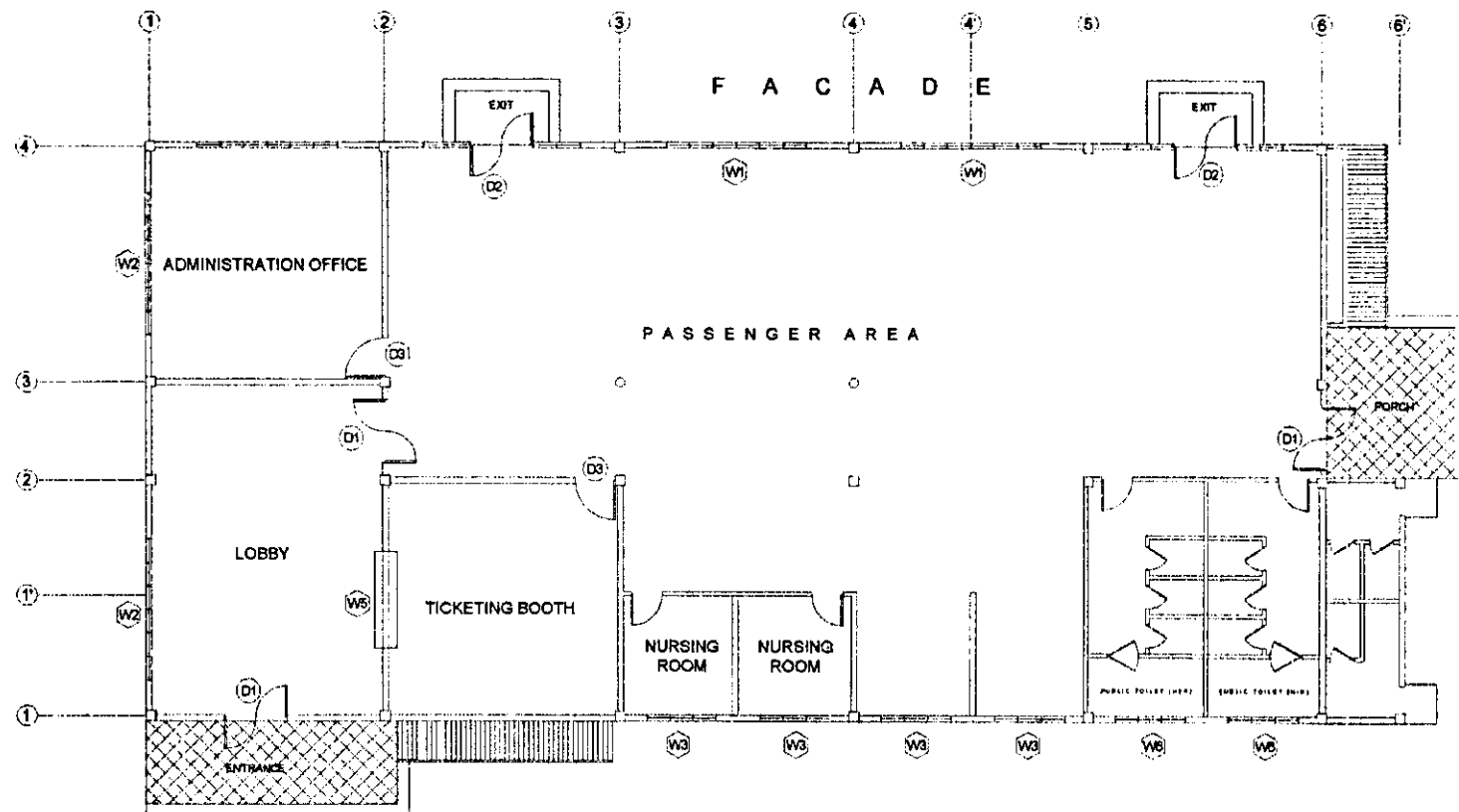

FLOOR PLAN OF PORT TERMINAL BUILDING

 <p>PHILIPPINE PORTS AUTHORITY</p>	<p>PORT MANAGEMENT OFFICE OF MASBATE Masbate City</p>	PROJECT TITLE:	PREPARED BY:	CHECKED/REVIEWED BY:	APPROVED:	SHEET NO.:
		<p>RESTORATION OF PORT FACILITIES DAMAGED BY TYPHOON "TISOY"</p>	<p><i>[Signature]</i> ANTONIO O. BUNAN</p>	<p><i>[Signature]</i> NELSON Y. CAABAY, JR.</p>	<p><i>[Signature]</i> OLIVER S. RODULFO, JR.</p>	<div style="border: 1px solid black; border-radius: 50%; width: 40px; height: 40px; display: flex; align-items: center; justify-content: center; margin: 0 auto;"> <div style="text-align: center;">3 6</div> </div>
		LOCATION: Port of Claveria, Bunas Is., Masbate	Construction Foreman A	Acting ESD Manager	Acting Port Manager	

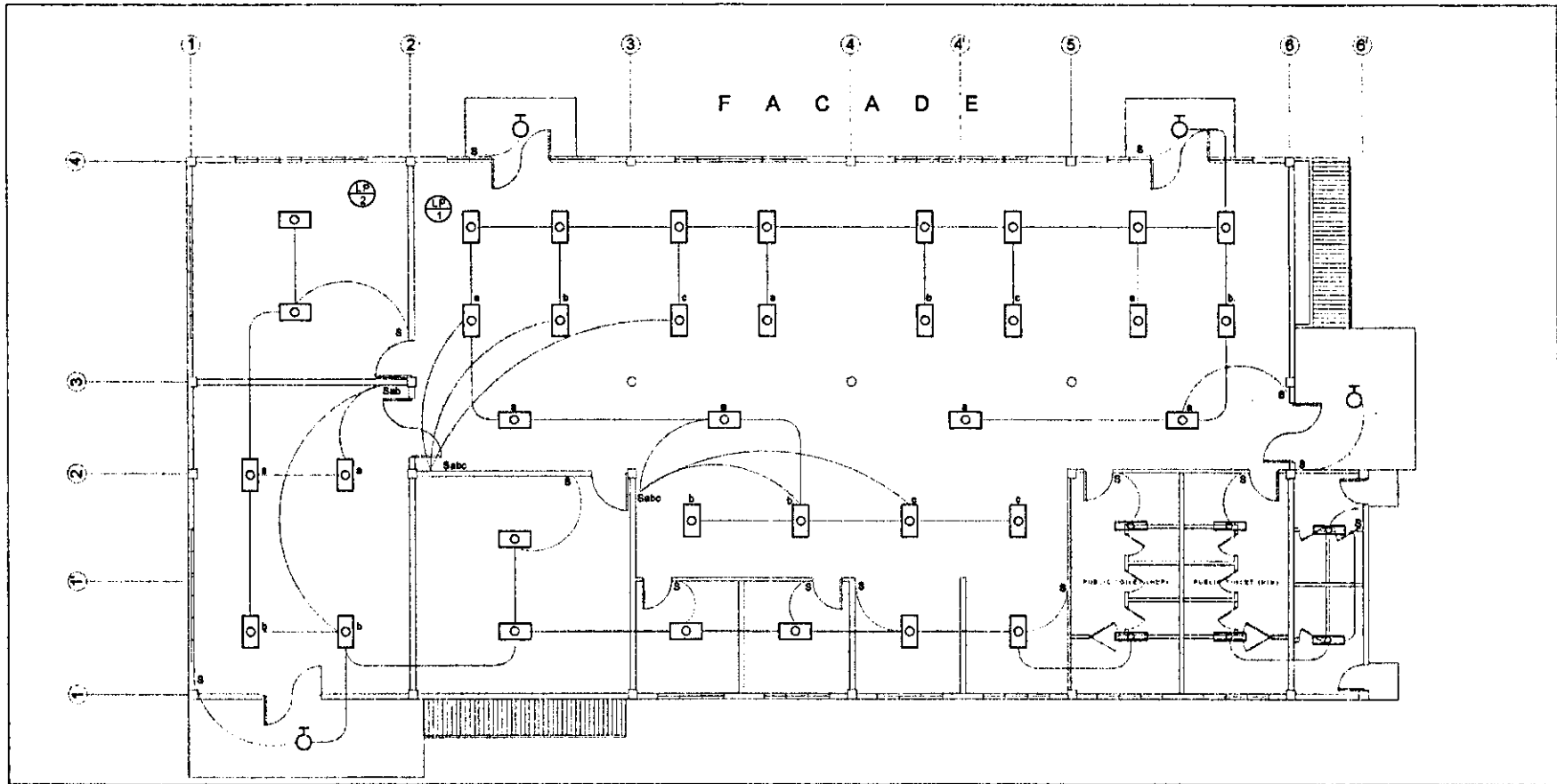

LIGHTING LAYOUT PLAN



PORT MANAGEMENT
OFFICE OF MASBATE
Masbate City

PROJECT TITLE:

**RESTORATION OF PORT FACILITIES
DAMAGED BY TYPHOON "TISOY"**

LOCATION: Port of Claveria, Buriat Is., Masbate

PREPARED BY:

ANTONIO O. BUNAN

Construction Foreman A

CHECKED/REVIEWED BY:

NELSON Y. CAABAY, JR.

Acting ESD Manager

APPROVED:

OLIVER S. RODULFO, JR.

Acting Port Manager

SHEET NO.:

**4
6**

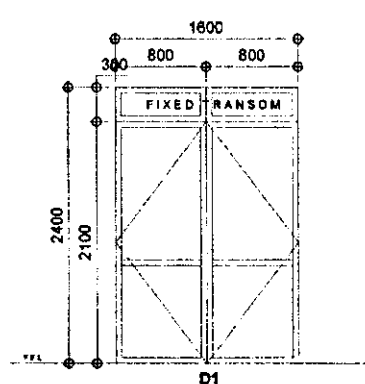

TYPE: ALUMINUM DOOR POWDER COATED FIN W/ 6.35mm THK REFLECTIVE GLASS
 LOCATION: ENTRY PORCH, SANITIZING AREA & SIDE EXIT
 SET: 3

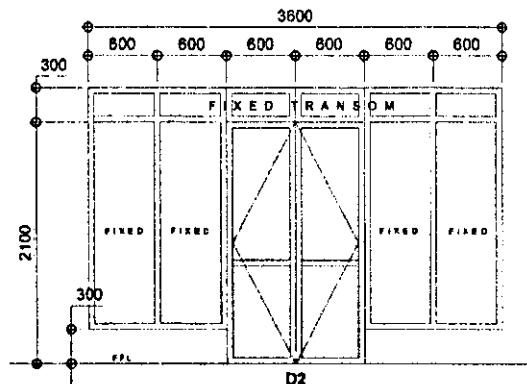

TYPE: DOOR WINDOW - ALUM POWDER COATED FIN W/ 6.35mm REFLECTIVE GLASS
 LOCATION: EXIT
 SET: 2

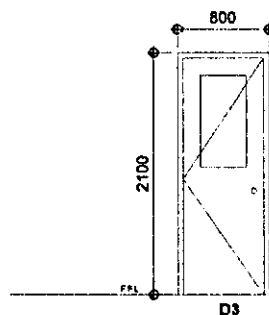

TYPE: MAR. PLYWD. FIN. FLUSH DOOR W/ 3mm THK CLEAR GLASS
 LOCATION: TICKETING, ADMIN & NURSING RM
 SET: 4

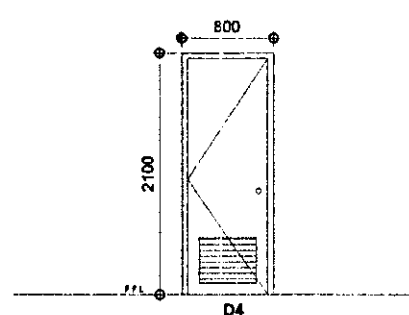

TYPE: PVC DOOR W VENT LOUVER
 LOCATION: PUBLIC TOILET
 SET: 4

SCHEDULE OF DOORS

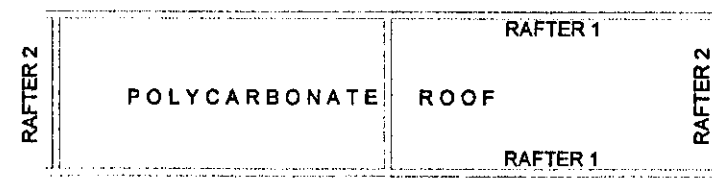
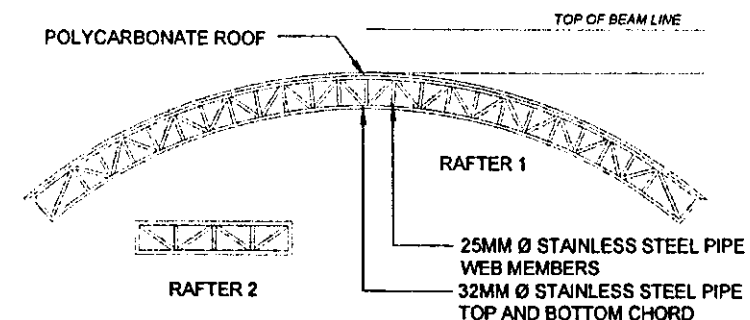

DETAIL OF SKYLIGHT



PORT MANAGEMENT
 OFFICE OF MASBATE
 Masbate City

PROJECT TITLE:

**RESTORATION OF PORT FACILITIES
 DAMAGED BY TYPHOON "TISOY"**

LOCATION: Port of Claveria, Buriis Is., Masbate

PREPARED BY:

ANTONIO O. BUNAN

Construction Foreman A

CHECKED/REVIEWED BY:

NELSON Y. CAABAY, JR.

Acting ESD Manager

APPROVED:

OLIVER S. RODULFO, JR.

Acting Port Manager

SHEET NO:

**5
6**

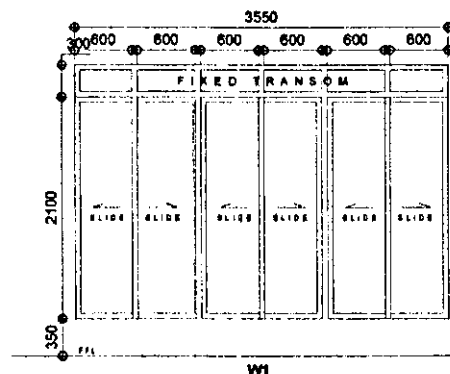

W1
TYPE: ALUM WINDOW POWDER COATED FIN W/
6.35mm REFLECTIVE GLASS
LOCATION: PASSENGER AREA
SET: 2

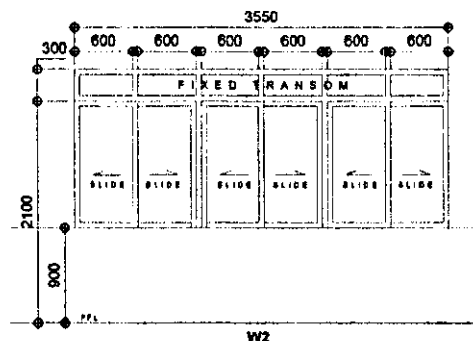

W2
TYPE: ALUM WINDOW POWDER COATED FIN W/
6.35mm REFLECTIVE GLASS
LOCATION: LOBBY
SET: 2

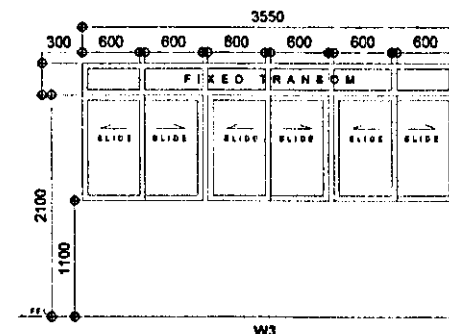

W3
TYPE: ALUM WINDOW POWDER COATED FIN W/
6.35mm REFLECTIVE GLASS
LOCATION: NURSING MOTHER'S RM.
SET: 1

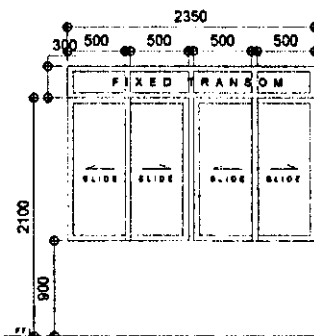

W4
TYPE: ALUM WINDOW POWDER COATED FIN W/
6.35mm REFLECTIVE GLASS
LOCATION: SNACK COUNTER
SET: 4

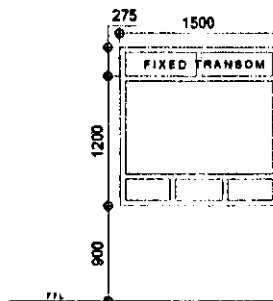

W5
TYPE: ALUM WINDOW POWDER COATED FIN W/
6.35mm REFLECTIVE GLASS
LOCATION: TICKETING OFFICE
SET: 2

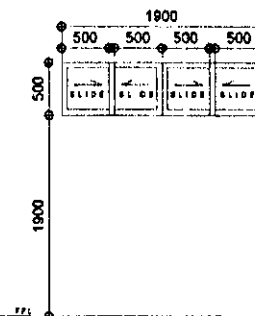

W6
TYPE: ALUM WINDOW POWDER COATED FIN W/
6.35mm REFLECTIVE GLASS
LOCATION: TOILET
SET: 2

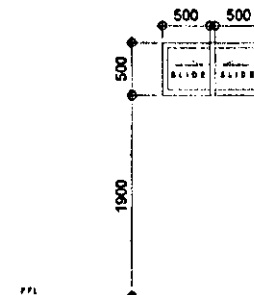

W7
TYPE: ALUM WINDOW POWDER COATED FIN W/
6.35mm REFLECTIVE GLASS
LOCATION: TOILET
SET: 2

SCHEDULE OF WINDOWS



PORT MANAGEMENT
OFFICE OF MASBATE
Masbate City

PROJECT TITLE:

**RESTORATION OF PORT FACILITIES
DAMAGED BY TYPHOON "TISOY"**

LOCATION: Port of Claveria, Buriac Is., Masbate

PREPARED BY:

ANTONIO O. BUNAN

Construction Foreman A

CHECKED/REVIEWED BY:

NELSON T. CAABAY, JR.

Acting ESD Manager

APPROVED:

OLIVER S. RODULFO, JR.

Acting Port Manager

SHEET NO.:

6
6

SECTION VIII

BILL OF QUANTITIES
and
ATTACHMENTS

RESTORATION OF PORT FACILITIES DAMAGED BY TYPHOON "TISOY"
Port of Claveria, Burias Island, Masbate

BID SUMMARY

BILL NO.	DESCRIPTION OF WORK	AMOUNT (PHP)
I.	GENERAL EXPENSES	
II.	RESTORATION OF DAMAGE ROCK CAUSEWAY/SLOPE PROTECTION	
III.	RESTORATION OF DAMAGED PASSENGER TERMINAL	
BID PRICE		

Name of Firm

Name of Bidder/Authorized Representative
(Signatory's Legal Capacity)

Date

RESTORATION OF PORT FACILITIES DAMAGED BY TYPHOON "TISOY"

Port of Claveria, Burias Island, Masbate

Bill of Quantities

ITEM/BILL NO. (1)	DESCRIPTION OF WORK (2)	UNIT (3)	QTY. (4)	UNIT PRICE (PHP) (5)	AMOUNT (PHP) (4) X (5)
I.	GENERAL EXPENSES				
1.01	Mobilization and Demobilization	lot	1.00		
1.02	Pre-construction Survey and Rental of Temporary Facilities	lot	1.00		
1.03	Provide Construction Safety and Health Program in the Execution of the Project	mos.	4.00		
II.	RESTORATION OF DAMAGE ROCK CAUSEWAY/SLOPE PROTECTION				
2.01	Demolition and Disposal Works	lot	1.0		
2.02	Supply and Place 50-100kg Core Rocks	cu.m.	285.00		
2.03	Supply and Place Armour Rocks (1-2 tons/pc)	cu.m.	97.00		
2.04	Supply, Spread and Compact Selected Fill Materials	cu.m.	133.00		
2.05	Supply, Spread and Compact Aggregate Base Course	cu.m.	28.00		
2.06	Concrete Paving Works	cu.m.	40.18		
2.07	Restoration of Concrete Toe	cu.m.	299.36		
2.08	Restoration of Concrete Facing	cu.m.	285.72		
III.	RESTORATION OF DAMAGED PASSENGER TERMINAL				
3.01	Removal and Replacement of Canopy/Roofing	sq.m.	16.00		
3.02	Replacement of Doors and Windows	lot	1.00		
3.03	Replacement of Damaged Plumbing Fixtures	lot	1.00		
3.04	Replacement of Damaged Electrical Wirings and Fixtures	lot	1.00		
3.05	Repainting Works	sq.m.	355.00		

	TOTAL	
AMOUNT IN WORDS:		

Submitted by:

Name and Signature of Authorized Representative

Position

Name of Bidder

Date

: _____
: _____
: _____
: _____

BASIS OF PAYMENT FOR WORK ITEMS INCLUDED IN THE PROPOSAL

The work items included in the proposal and the basis of payments are as follows:

BILL NO. 1

GENERAL EXPENSES

Item 1.01 Mobilization and Demobilization

The quantity to be paid for shall be the minimum equipment requirement enumerated in the bid documents mobilized, demobilized and cleaning of the site and accepted by the Engineer. The contract lump sum price shall be full compensation for furnishing all materials, labor, equipment, tools, and incidentals necessary to mobilize and demobilize all the minimum equipment requirement enumerated in the bid documents including cleaning of the site. Fifty percent (50%) of the total amount shall be payable after the mobilization activity while the remaining (50%) payable after demobilization and cleaning.

Item 1.02 Pre-construction Survey and Rental of Temporary Facilities

The quantity to be paid for shall be the actual services rendered in maintaining the site office and accepted by the Engineer. The contract unit price shall be full compensation for furnishing all materials, labor, equipment, tools, and incidentals necessary to complete the maintenance of the temporary site office and residence as well as other expenses such as provision for electric power, telephone bill, potable water supply, janitorial and security services.

Item 1.03 Provide Construction Safety and Health Program in the Execution of the Project

The quantity to be paid shall be the actual implementation of construction safety and health program and accepted by the Engineer. The contract unit price shall be full compensation for furnishing all materials, labor, equipment, tools, and incidentals necessary to complete the implementation of the Construction Safety and Health Program, as required and approved by the Department of Labor and Employment (DOLE).

BILL NO. 2

RESTORATION OF DAMAGE ROCK CAUSEWAY/SLOPE PROTECTION

Item 2.01 Demolition and Disposal Works

The quantity to be paid for shall be in actual lot of demolished and disposed collapsed PCCP in accordance with the plans and specifications and accepted by the Engineer. The contract unit price shall be full compensation for furnishing all materials, labor, equipment, tools, and incidentals necessary to complete the work.

Item 2.02 Supply and Place 50-100kg Core Rocks

The quantity to be paid for shall be the actual volume in cubic meter of core rock, supplied and set-in-place in accordance with the plans and specifications and accepted by the Engineer. The contract unit price shall be full compensation for furnishing all materials, labor, equipment, tools, and incidentals necessary to complete the work.

Item 2.03 Supply and Place Armour Rocks (1-2 tons/pc)

The quantity to be paid for shall be the actual volume in cubic meter of armour rock, supplied and set-in-place in accordance with the plans and specifications and accepted by the Engineer. The contract unit price shall be full compensation for furnishing all materials, labor, equipment, tools, and incidentals necessary to complete the work.

Item 2.04 Supply, Spread and Compact Selected Fill Materials

The quantity to be paid for shall be the actual volume in cubic meter of selected fill materials to be supplied, spread, and compacted in accordance with the plans and specifications and accepted by the Engineer. The contract unit price shall be full compensation for furnishing all materials, labor, equipment, tools, and incidentals necessary to complete the work.

Item 2.05 Supply, Spread and Compact Aggregate Base Course

The quantity to be paid for shall be the actual volume in cubic meter of aggregate base course to be supplied, spread, and compacted in accordance with the plans and specifications and accepted by the Engineer. The contract unit price shall be full compensation for furnishing all materials, labor, equipment, tools, and incidentals necessary to complete the work.

Item 2.06 Concrete Paving Works

The quantity to be paid for shall be the actual volume in cubic meter of concrete paving works, to be constructed in accordance with the plans and specifications and accepted by the Engineer. The contract unit price shall be full compensation for furnishing all materials, labor, equipment, tools, and incidentals necessary to complete the work.

Item 2.07 Restoration of Concrete Toe

The quantity to be paid for shall be the actual volume in cubic meter of restoration of concrete toe, to be constructed in accordance with the plans and specifications and accepted by the Engineer. The contract unit price shall be full compensation for furnishing all materials, labor, equipment, tools, and incidentals necessary to complete the work.

Item 2.08 Restoration of Concrete Facing

The quantity to be paid for shall be the actual volume in cubic meter of restoration of concrete facing, to be constructed in accordance with the plans and specifications and accepted by the Engineer. The contract unit price shall be full compensation for furnishing all materials, labor, equipment, tools, and incidentals necessary to complete the work.

BILL NO. 3

RESTORATION OF DAMAGED PASSENGER TERMINAL

Item 3.01 Removal and Replacement of Canopy/Roofing

The quantity to be paid for shall be the actual area in square meter of removed and replaced canopy/roofing to be constructed in accordance with the plans and specifications and accepted by the Engineer. The contract unit price shall be full compensation for furnishing all materials, labor, equipment, tools, and incidentals necessary to complete the work.

Item 3.02 Replacement of Doors and Windows

The quantity to be paid for shall be in actual lot of replaced doors and windows to be installed in accordance with the plans and specifications and accepted by the Engineer. The contract unit price shall be full compensation for furnishing all materials, labor, equipment, tools, and incidentals necessary to complete the work.

Item 3.03 Replacement of Damaged Plumbing Fixtures

The quantity to be paid for shall be in actual lot of replaced damaged plumbing fixtures to be installed in accordance with the plans and specifications and accepted by the Engineer. The contract unit price shall be full compensation for furnishing all materials, labor, equipment, tools, and incidentals necessary to complete the work.

Item 3.04 Replacement of Damaged Electrical and Lighting

The quantity to be paid for shall be in actual lot of replaced damaged electrical and lighting fixtures to be installed in accordance with the plans and specifications and accepted by the Engineer. The contract unit price shall be full compensation for furnishing all materials, labor, equipment, tools, and incidentals necessary to complete the work.

Item 3.05 Repainting Works

The quantity to be paid for shall be the actual area in square meter of painted surface in accordance with the plans and specifications and accepted by the Engineer. The contract unit price shall be full compensation for furnishing all materials, labor, equipment, tools, and incidentals necessary to complete the work.

FACILITIES TO BE PROVIDED FOR THE ENGINEER & HIS STAFF

RENTAL OF SITE OFFICE AND RESIDENCE FOR THE ENGINEER & STAFF

The Contractor shall provide a temporary site office and residence (rental) with an area of at least 48 square meters for use of the Engineer and his staff for the whole duration of the project.

MINIMUM MAJOR EQUIPMENT REQUIREMENTS

1	unit	Jackhammer with Air Compressor (250 cfm minimum), owned
1	unit	Boom Truck (3T cap. minimum), owned/leased
1	unit	Crawler Crane (30T cap. minimum), owned/leased
1	unit	Dump Truck (9 cu. yards minimum), owned
1	unit	Road Roller (10T Vibratory minimum), owned
1	unit	Concrete Mixer (1 bagger minimum), owned
1	unit	Concrete Vibrator (3.5 hp, minimum), owned
1	unit	Concrete Cutter (sawing Blade dia. 350-500mm), owned
1	unit	Bar Cutter (25mm dia. minimum), owned
1	unit	Bar Bender (25mm dia. minimum), owned
1	unit	Water Truck (1000 gals minimum), owned
1	unit	Backhoe (2 cu.m. minimum), owned
1	unit	Payloader (1.7 cu.m., 125 hp, minimum), owned

CONSTRUCTION SAFETY AND HEALTH REQUIREMENT

The Contractor shall implement the construction safety and health program in accordance with the applicable provisions of the Occupational Safety and Health Standards (OSHS) of the Department of Labor and Employment (DOLE).

The Contractor, subject to the approval of the Engineer shall provide and maintain throughout the duration of the contract a medical room with at least 15 square meters together with all necessary supplies to be sited in the Contractor's main area.

The Contractor shall provide the following minimum requirements:

LABOR

1 no. Safety Engineer / Officer

EQUIPMENT / MATERIALS

Personnel Protective Equipment

1	lot	Hard Hats
1	lot	Gloves (rubberized)
1	lot	Safety Glasses/Goggles (clear)
1	lot	Long sleeve T-shirt
1	lot	Aprons
1	lot	Safety Belts
1	lot	Safety Shoes
1	lot	Life Lines

Safety Devices

1	lot	Barricades
1	lot	Warning signs

Medical and First Aid System	-	Four (4) mos.
Temporary shelter for workers	-	1 lot

NOTE:

The Contractor shall provide the above-cited minimum construction safety and health requirements or as required by the Engineer.

PPA MEMORANDUM CIRCULAR
No. 02
Series of 2018
Attachment

Page 1 of 10

REVISED SCHEDULE OF MINIMUM TEST REQUIREMENTS OF CONSTRUCTION MATERIALS FOR PPA INFRASTRUCTURE PROJECTS

<i>Materials/Items of Work</i>	<i>Required Tests</i>	<i>Minimum Incremental Frequency of Tests</i>
I. Construction of Pier/Wharf, Platform and Ramp		
Structural Concrete (SC)		
A Portland Cement	Quality Test	For every 2,000 bags (40kg) or fraction thereof
B Fine Aggregate	Quality Test for Grading, Elutriation (wash), Bulk Specific Gravity, Absorption, Mortar Strength, Soundness, Organic Impurities, Unit Weight, % Clay Lumps and Shale	For every 1,500 cubic meter or fraction thereof
C Coarse Aggregate	Quality Test for Grading, Bulk Specific Gravity, Absorption and Abrasion	For every 1,500 cubic meter or fraction thereof
D Water	Certificate from the Engineer or Quality Test for Density and Chloride Content	One per source
E Steel Bars	Mill Certificate and Quality Test for Chemical Composition and Mechanical Properties	For every 10,000 kg or fraction thereof
F Concrete	Compressive Strength on cylinder samples	1 set consisting of 3 concrete cylinder samples shall be taken from each day's pouring and to represent not more than 75 cu m of concrete or fraction thereof
	Slump Test	For every mix
G Admixture and Concrete Curing Materials	Quality Test	One per shipment
Piling (P)		
A Concrete Piles	Fabrication Report	One per fabrication
1 Concrete	Same test as for SC (F)	Same frequency as SC (F)
2 Steel Bars	Same test as for SC (E)	Same frequency as SC (E)
3 High Tension Strand	Test for Chemical Composition and Mechanical Properties	For every 20000kg or fraction thereof

PPA MEMORANDUM CIRCULAR
No. 02
Series of 2016
Attachment

Page 2 of 10

Materials/Items of Work	Required Tests	Minimum Incremental Frequency of Tests
4 Coarse Aggregates	Same Test as for SC (C)	Same frequency as SC (C)
5 Fine Aggregates	Same Test as for SC (B)	Same frequency as SC (B)
B Steel Pipe Piles	Fabrication Report, Mill Certificate and Quality Test for Chemical and Mechanical properties	One per fabrication
1 Steel	Chemical Composition (refer below) <ul style="list-style-type: none"> Under 14" (355 60mm) Outside Diameter 14" to 36" (355 6 to 914mm) Outside Dia Over 36" (914mm) Outside Diameter Mechanical/Tensile	2 from 200 pipe or fraction thereof 2 from 100 pipe or fraction thereof 2 from 3000ft (914m) or fraction thereof One (1) tension test shall be made on one length or fraction thereof of each size, or one piece of skelp representing each lot of 200 lengths or fraction thereof of each size
2 Polyurethane Coating	Mill Certificate and Quality Test	One per fabrication
3 Concrete	Same test as for SC (F)	Same frequency as SC (F)
4 Fine Aggregate	Same test as for SC (B)	Same frequency as SC (B)
5 Coarse Aggregate	Same test as for SC (C)	Same frequency as SC (C)
6 Steel Bars	Same Test as SC (E)	Same frequency as SC (E)
7 Water	Same Test as SC (D)	Same frequency as SC (D)
Rubber Dock Fenders (RDF)	Physical Test Performance Test for Energy Absorption and Reaction Force	All units All units
Accessories Washer and Fixing Bolt, Anchor Bolt	Physical Test Quality Test for Chemical Composition and Mechanical Properties	All units One per fabrication

PPA MEMORANDUM CIRCULAR
No. 02
Series of 2016
Attachment
Page 3 of 10

Materials/Items of Work	Required Tests	Minimum Incremental Frequency of Tests
Mooring Bollard (MB) and Accessories (Hexagon Nuts, Plain Washer, Anchor Ring and Anchor Bolt)	Physical Test Quality Test for Chemical Composition and Mechanical Properties	All Units One per fabrication
II. Construction of Back-Up Area, Causeway and Pavement Sheet Piling (SP)		
A Concrete Sheet Piles		
1 Concrete	Same test as for SC (F)	Same frequency as SC (F)
2 Steel Bars	Same test as for SC (E)	Same frequency as SC (E)
3 High Tension Strands	Same test as for P (A 3)	Same frequency as P (A 3)
4 Fine Aggregates	Same test as for SC (B)	Same frequency as SC (B)
5 Coarse Aggregates	Same Test as for SC (C)	Same frequency as SC (C)
B Steel Pipe Piles		
1 Steel	Same test as for P (B1)	Same frequency as P (B1)
2 Concrete	Same test as for SC (F)	Same frequency as SC (F)
3 Fine Aggregate	Same test as for SC (B)	Same frequency as SC (B)
4 Steel Bars	Same test as for SC (E)	Same frequency as SC (E)

PPA MEMORANDUM CIRCULAR
No. 02
Series of 2016
Attachment
Page 4 of 10

Materials/Items of Work	Required Tests	Minimum Incremental Frequency of Tests
Rocks	Test for Apparent Specific Gravity and Abrasion	For every 1,500 cubic meter or fraction thereof
Geotextile Filter	Physical and Mechanical Test Mill Certificate	One per batch One per batch
Sand and Gravel Fill	Quality Test for Organic Impurities and Grading	For every 1,500 cubic meter or fraction thereof
Selected Fill	Quality Test for Grading, Plasticity and Laboratory Compaction Test Laboratory California Bearing Ratio (CBR) Field Density Test	For every 1,500 cubic meter or fraction thereof For every 2,500 cubic meter or fraction thereof For every layer of 150mm of compacted depth at least one group of three In-situ density test for every 500 sq m or fraction thereof
Aggregate Base Course	Quality Test for Grading and Plasticity Quality Test for Grading, Plasticity, Abrasion and Laboratory Compaction Test Laboratory California Bearing Ratio (CBR) Field Density Test	For every 300 cubic meter or fraction thereof For every 1,500 cubic meter or fraction thereof Same frequency as Selected Fill Same frequency as Selected Fill
Portland Cement Concrete Pavement (PCCP)		
A Portland Cement	Same test as for SC (A)	Same frequency as SC (A)
B Fine Aggregate	Same test as for SC (B)	Same frequency as SC (B)
C Coarse Aggregate	Same test as for SC (C)	Same frequency as SC (C)
D Water	Same test as for SC (D)	Same frequency as SC (D)
E Steel Bars (Dowels)	Same test as for SC (E)	Same frequency as SC (E)
F Joint Filler	Quality Test	One (1) per shipment

PPA MEMORANDUM CIRCULAR
No. 02
Series of 2016
Attachment
Page 5 of 10

Materials/Items of Work	Required Tests	Minimum Incremental Frequency of Tests
G Admixture and Concrete Curing Material	Same test as for SC (G)	Same frequency as SC (G)
H Concrete	Same test as for SC (F) Flexural Test	Same frequency as SC (F) 3 beam samples for every 330 sq m or fraction thereof
I Completed Pavement	Core Test	1 set (3 specimen) for every 2,500 sq m and fraction thereof
Interlocking Concrete Blocks		
A Cement	Same test as for SC (A)	Same frequency as SC (A)
B Fine Aggregate	Same test as for SC (B)	Same frequency as SC (B)
C Coarse Aggregate	Same test as for SC (C)	Same frequency as SC (C)
D Water	Same test as for SC (D)	Same frequency as SC (D)
E Admixture & Concrete Curing Materials	Same test as for SC (G)	Same frequency as SC (G)
F Completed Blocks	Physical Test and Compressive Strength	6 blocks per day of fabrication
Cement Treated Base Course (CTB)		
A Portland Cement	Same test as for SC (A)	Same frequency as SC (A)
B Fine & Coarse Aggregates	Quality Test for Grading, Abrasion and Soundness	For every 1,500 cubic meter or fraction thereof
C Water	Same test as for SC (D)	Same frequency as SC (D)
D Completed CTB	Field Density Test	For every layer of 150mm of compacted depth at least one group of three in-situ density test every 500 sq m or fraction thereof
Retaining Wall/Coping Wall/RC Curb/RC Ditch/Shear Key/Concrete Blocks/Lean Concrete		
A Portland Cement	Same test as for SC (A)	Same frequency as SC (A)
B Fine Aggregate	Same test as for SC (B)	Same frequency as SC (B)

PPA MEMORANDUM CIRCULAR
No. 02
Series of 2016
Attachment

Page 6 of 10

Materials/Items of Work	Required Tests	Minimum Incremental Frequency of Tests
C Coarse Aggregates	Same test as for SC (C)	Same frequency as SC (C)
D Water	Same test as for SC (D)	Same frequency as SC (D)
E Steel Bars	Same test as for SC (E)	Same frequency as SC (E)
F Admixture and Concrete Curing	Same test as for SC (G)	Same frequency as SC (G)
G Concrete	Same test as for SC (F)	Same frequency as SC (F)
Tie Rod		
A Steel	Same test as for SC (E)	One per batch
B Assembly	Performance Test (Tension)	One per batch
Tie Bars and Dowels	Same test as for SC (E)	For every 10,000 kg or fraction thereof per Tie bars and Dowels
Pipe Culverts and Storm Drains		
A Pipes	Test for Strength, Absorption and Physical	For every 50 pieces
B Mortar or Joint	Same Test as for SC (A,B and D) Alternative Test Same test as for SC (F) and Inspection Report	For every 25 pieces
Concrete Hollow Blocks		
A Portland Cement	Same test as for SC (A)	Same frequency as SC (A)
B Fine Aggregates	Same test as for SC (B)	Same frequency as SC (B)
C Water	Same test as for SC (D)	Same frequency as SC (C)
D Concrete	Same test as for SC (F)	Same frequency as SC (F)
E Completed CHB	Quality Test	One for every 500 pieces or fraction thereof
Construction Joints (CJ)		
A Angle Bars	Test for Physical and Mechanical Properties	One per batch
B Steel Bars	Same test as for SC (E)	One per batch
C Zinc (Hot Dip Galvanizing) Coatings	Physical Test for Appearance, Stripping, Weighing, Adherence and Adhesion Coating Thickness Magnetic Thickness Measurement	All units 1 set (3 specimen) for every 100,000 sq mm or fraction thereof

PPA MEMORANDUM CIRCULAR
No. 02
Series of 2016
Attachment

Page 7 of 10

Materials/Items of Work	Required Tests	Minimum Incremental Frequency of Tests
Sacked Concrete		
A Cement	Same test as for SC (A)	Same frequency as SC (A)
B Fine Aggregates	Same test as for SC (B)	Same frequency as SC (B)
C Coarse Aggregates	Same test as for SC (C)	Same frequency as SC (C)
D Water	Same test as for SC (D)	Same frequency as SC (D)
E Concrete	Same test as for SC (F)	Same frequency as SC (F)
F Sack (jute)	Physical Test	One for every 50 pieces
Rubble Concrete		
A Cement	Same test as for SC (A)	Same frequency as SC (A)
B Fine Aggregates	Same test as for SC (B)	Same frequency as SC (B)
C Coarse Aggregates	Same test as for SC (C)	Same frequency as SC (C)
D Water	Same test as for SC (D)	Same frequency as SC (D)
E Concrete	Same test as for SC (F)	Same frequency as SC (F)
F Rocks	Same test as for ROCKS	Same frequency as ROCKS
Earthworks		
A Sub-grade preparation	Grading Test Plasticity Test (LL, PL, PI) Laboratory Compaction Test Density Test	For every 1,500 cubic meter or fraction thereof For every layer of 150mm of compacted depth at least one group of three in-situ density test every 500 sq m. or fraction thereof
B Structure Excavation	If excavated materials shall be used as Backfill Grading Test Plasticity Test (LL, PL, PI) Laboratory Compaction Test Density Test	For every 1,500 cubic meter or fraction thereof For every layer of 150mm of compacted depth at least one group of three in-situ density test every 500 sq m. or fraction thereof

ENC

PPA MEMORANDUM CIRCULAR
No. 02
Series of 2016
Attachment
Page 8 of 10

Materials/Items of Work	Required Tests	Minimum Incremental Frequency of Tests
III Port Operations Building/Passenger Terminal Building/Transit Shed/Warehouse		
STRUCTURAL WORKS		
Refer to Structural Concrete (SC) and Piling Works (P)		
ARCHITECTURAL WORKS		
Ceramic – Filled Liquid Membrane / Water Proofing, Hydrophobic Poreblocking Ingredients with Superplasticizer	Physical Property, Mechanical and Chemical Property, Leak Test / Flood Test	One per shipment
Paint	Quality Test	One 4-L can for every 100 cans or fraction thereof
Ceramic Tile	Inspection and Evaluation Report from the Engineer	One per shipment
Stainless Steel	Inspection and Evaluation Report from the Engineer	One per shipment
Roofing Materials	Inspection and Evaluation Report from the Engineer	One per shipment
Ceiling Materials	Inspection and Evaluation Report from the Engineer	One per shipment
ELECTRICAL AND MECHANICAL WORKS		
Wires / Cables	Inspection and Evaluation Report from the Engineer Testing and Commissioning	One per shipment
Electrical Devices	Inspection and Evaluation Report from the Engineer Testing and Commissioning	One per shipment
Fire Alarm System	Inspection and Evaluation Report from the Engineer Testing and Commissioning	One per item
Wiring Devices	Inspection and Evaluation Report from the Engineer Testing and Commissioning	One per shipment

PPA MEMORANDUM CIRCULAR
No. 02
Series of 2018
Attachment

Page 9 of 10

Materials/Items of Work	Required Tests	Minimum Incremental Frequency of Tests
Protective Devices	Inspection and Evaluation Report from the Engineer Testing and Commissioning	One per shipment
Telephone System	Inspection and Evaluation Report from the Engineer Testing and Commissioning	One per item
CCTV System	Inspection and Evaluation Report from the Engineer Testing and Commissioning	One per item
CATV System	Inspection and Evaluation Report from the Engineer Testing and Commissioning	One per item
Background Music and Paging System	Inspection and Evaluation Report from the Engineer, Testing and Commissioning	One per item
Air Conditioning Units & Ventilation	Inspection and Evaluation Report from the Engineer Testing and Commissioning	One per item
Conduit Pipes	Inspection and Evaluation Report from the Engineer Testing and Commissioning	One per item
Lighting Fixtures	Inspection and Evaluation Report from the Engineer Testing and Commissioning	One per item
PLUMBING WORKS		
Pipes	Inspection and Evaluation Report from the Engineer Testing and Commissioning	One per item

PPA MEMORANDUM CIRCULAR
No. 02
Series of 2016
Attachment

Page 10 of 10

Materials/Items of Work	Required Tests	Minimum Incremental Frequency of Tests
Fixtures	Inspection and Evaluation Report from the Engineer Testing and Commissioning	One per item
Pipe Culverts	Compression Strength Inspection and Evaluation Report from the Engineer	For every size not more than 25 pipes cast in the field
IV Miscellaneous Materials Fencing A Barbed Wire, Cyclone Wire Mesh, Chain Link B Concrete Post	Physical Test (Dimensions and Coatings) Refer to Superstructure (SC)	One per Batch Refer to Superstructure (SC)
Lamp Post A Structural Steel B Zinc (Hot Dip Galvanizing) Coatings	Physical Test (Dimensions) Same test as for SC (E) Same test as for CJ (C)	All units One per batch
Drainage Steel Grating	Same test as for SC (E) Inspection Report	One (1) batch
Metal Pipe (Cast Iron Galvanized, etc)	Physical Test (Dimensions and Coatings)	1 per delivery
Welding Works	Destructive and Non Destructive Test	One (1) per lot

- NOTES**
1. Testing of RDF shall be performed only by an independent Testing Laboratory duly accredited by BRS, DOST and PPA
 2. Testing of other materials shall be performed only by an independent Testing Laboratory duly accredited by BRS and PPA.
 3. All other issuances which are otherwise inconsistent herewith are hereby revoked or otherwise amended.

Approved

RAUL T. SANTOS
Officer-In-Charge,
Office of the General Manager

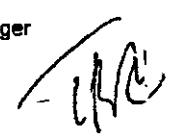

SECTION IX

CHECKLIST OF TECHNICAL AND FINANCIAL DOCUMENTS

Checklist of Technical and Financial Documents

I. TECHNICAL COMPONENT ENVELOPE

Class "A" Documents

Legal Documents

- ☐ (a) Valid PhilGEPS Registration Certificate (Platinum Membership) (all pages)

Technical Documents

- ☐ (b) Statement of the prospective bidder of all its ongoing government and private contracts, including contracts awarded but not yet started, if any, whether similar or not similar in nature and complexity to the contract to be bid; **and**
- ☐ (c) Statement of the bidder's Single Largest Completed Contract (SLCC) similar to the contract to be bid, except under conditions provided under the rules; **and**
- ☐ (d) Special PCAB License in case of Joint Ventures; **and** registration for the type and cost of the contract to be bid; **and**
- ☐ (e) Original copy of Bid Security. If in the form of a Surety Bond, submit also a certification issued by the Insurance Commission;
or
Original copy of Notarized Bid Securing Declaration; **and**
- ☐ (f) Project Requirements, which shall include the following:
 - ☐ a. Organizational chart for the contract to be bid;
 - ☐ b. List of contractor's key personnel (e.g., Project Manager, Project Engineers, Materials Engineers, and Foremen), to be assigned to the contract to be bid, with their complete qualification and experience data;
 - ☐ c. List of contractor's major equipment units, which are owned, leased, and/or under purchase agreements, supported by proof of ownership or certification of availability of equipment from the equipment lessor/vendor for the duration of the project, as the case may be; **and**
- ☐ (g) Original duly signed Omnibus Sworn Statement (OSS); **and** if applicable, Original Notarized Secretary's Certificate in case of a corporation, partnership, or cooperative; or Original Special Power of Attorney of all members of the joint venture giving full power and authority to its officer to sign the OSS and do acts to represent the Bidder.

Financial Documents

- ☐ (h) The prospective bidder's computation of Net Financial Contracting Capacity (NFCC).

Class "B" Documents

- ☐ (i) If applicable, duly signed joint venture agreement (JVA) in accordance with RA No. 4566 and its IRR in case the joint venture is already in existence;
or
duly notarized statements from all the potential joint venture partners stating that they will enter into and abide by the provisions of the JVA in the instance that the bid is successful.

II. FINANCIAL COMPONENT ENVELOPE

- ☐ (j) Original of duly signed and accomplished Financial Bid Form; **and**

Other documentary requirements under RA No. 9184

- ☐ (k) Original of duly signed Bid Prices in the Bill of Quantities; **and**
- ☐ (l) Duly accomplished Detailed Estimates Form, including a summary sheet indicating the unit prices of construction materials, labor rates, and equipment rentals used in coming up with the Bid; **and**
- ☐ (m) Cash Flow by Quarter.

SECTION X
BIDDING FORM

Bid Form for the Procurement of Infrastructure Projects

[shall be submitted with the Bid]

BID FORM

Date : _____
Project Identification No. : _____

To: **Philippine Ports Authority**
PPA Building, Bonifacio Drive,
South Harbor, Port Area, Manila

Having examined the Philippine Bidding Documents (PBDs) including the Supplemental or Bid Bulletin Numbers _____, the receipt of which is hereby duly acknowledged, we, the undersigned, declare that:

- a. We have no reservation to the PBDs, including the Supplemental or Bid Bulletins, for the Procurement Project: ***Restoration of Port Facilities Damaged by Typhoon "Tisoy", Port of Claveria, Burias Island, Masbate***
- b. We offer to execute the Works for this Contract in accordance with the PBDs;
- c. The total price of our Bid in words and figures, excluding any discounts offered below is: _____;
- d. The discounts offered and the methodology for their application are: _____;
- e. The total bid price includes the cost of all taxes, such as, but not limited to: *[specify the applicable taxes, e.g. (i) value added tax (VAT), (ii) income tax, (iii) local taxes, and (iv) other fiscal levies and duties]*, which are itemized herein and reflected in the detailed estimates,
- f. Our Bid shall be valid within the period stated in the PBDs, and it shall remain binding upon us at any time before the expiration of that period;
- g. If our Bid is accepted, we commit to obtain a Performance Security in the amount of _____ percent of the Contract Price for the due performance of the Contract, or a Performance Securing Declaration in lieu of the the allowable forms of Performance Security, subject to the terms and conditions of issued GPPB guidelines¹ for this purpose;
- h. We are not participating, as Bidders, in more than one Bid in this bidding process, other than alternative offers in accordance with the Bidding Documents;
- i. We understand that this Bid, together with your written acceptance thereof

¹ currently based on GPPB Resolution No. 09-2020

included in your notification of award, shall constitute a binding contract between us, until a formal Contract is prepared and executed; and

- j. We understand that you are not bound to accept the Lowest Calculated Bid or any other Bid that you may receive.
- k. We likewise certify/confirm that the undersigned, is the duly authorized representative of the bidder, and granted full power and authority to do, execute and perform any and all acts necessary to participate, submit the bid, and to sign and execute the ensuing contract for the **Restoration of Port Facilities Damage by Typhoon "Tisoy", Port of Claveria, Burias Island, Masbate of the Philippine Ports Authority.**
- l. We acknowledge that failure to sign each and every page of this Bid Form, including the Bill of Quantities, shall be a ground for the rejection of our bid.

Name: _____

Legal Capacity: _____

Signature: _____

Duly authorized to sign the Bid for and behalf of: _____

Date: _____

STATEMENT OF THE BIDDER'S ALL ONGOING GOVERNMENT AND PRIVATE CONTRACTS, INCLUDING CONTRACTS AWARDED BUT NOT YET STARTED

I hereby declare that all ongoing contracts, including awarded contracts yet to be started coinciding with the contract to be bid are listed below:

Name of outstanding Contracts 1]	Owner's Name and Address	Scope of Work 2]	Contractor's Role and Percentage of Participation 3]	Total Contract Amount or Value 4]	Date of Contract and NOA 5]	Value of Outstanding Works 6]	Accomplishment (in percentage, %) 7]		Contract Duration 8]	
							Planned	Actual	Start of Project	Estimated Completion Date
A) Government Contracts i. On-going ii. Awarded but not yet started B) Private Contracts i. On-going ii. Awarded but not yet started										

NOTE:

- 1] As appearing in the contract executed by the parties.
- 2] With special reference to the Scope of Works of the Project as described/enumerated in the Contract.
- 3] Indicate the percentage of participation and whether as Sole Contractor, Sub-Contractor or Member in a Joint Venture / Consortium.
- 4] Indicate the FOREX used if Contract Value is expressed in a currency other than the Philippine Peso.
- 5] As appearing in the Contract and Notice of Award (NOA).
- 6] Amount or value of all outstanding or uncompleted portions of the projects under ongoing contracts, including awarded contracts yet to be started coinciding with the contract to be bid.
- 7] Percentage of Accomplishment as of the preceding month which should not be earlier than two (2) months from the date of bid submission.
- 8] As appearing in the Notice to Proceed and Contract.

This Statement shall be supported by:

- a) Notice of Award
- b) Notice to Proceed and Contract

Name of Firm

Name of Bidder/Authorized Representative
(Signatory's Legal Capacity)

Date

Revised: September 2021

STATEMENT OF THE BIDDER'S SINGLE LARGEST COMPLETED CONTRACT (SLCC) SIMILAR TO THE CONTRACT TO BE BID

Name of the completed Contract 1]	Owner's Name and Address	Scope of Work 2]	Contractor's Role and Percentage of Participation 3]	Total Contract Value At 4]			Date of Award 5]	Contract Duration 6]	
				Award	Completion	Escalated Value to Present Prices		Start	Completed

NOTE :

- 1] As appearing in the contract executed by the parties.
 - 2] With special reference to the Scope of Works of the Project as described/enumerated in the Contract.
 - 3] Indicate the percentage of participation and whether as Sole Contractor, Sub-Contractor or Member in a Joint Venture / Consortium.
 - 4] Indicate the FOREX used if Contract Value is expressed in a currency other than the Philippine Peso. Attached the computation for the escalated contract value.
 - 5] As appearing in the Notice of Award.
 - 6] As appearing in the Notice to proceed and Certificate of Completion.
- A. The bidder must have an experience of having completed a SLCC that is similar to the contract to be bid equivalent to at least fifty percent (50%) of the ABC, adjusted if necessary, by the Bidder to current prices using the PSA consumer price indices. A contract is considered to be "similar" to the contract to be bid if it has the same Major Categories of Work as stated in the Bid Data Sheet (BDS).
- B. This Statement shall be supported by:
- a. Notice of Award, Notice to Proceed and Contract.
 - b. Project Owner's Certificate of Final Acceptance issued by the owner and/ or Constructors Performance Evaluation System (CPES) Final Rating, which must be at least Satisfactory. The said Certificate of Acceptance shall contain the following: 1) Name of project owner that issued the certificate, 2) Name of Contractor/ Constructor, 3) Name of Contract, and 4) Contract Duration.
 - c. Recapitulation or Final Bill of Quantities.

Name of Firm_____
Name of Bidder/Authorized Representative
(Signatory's Legal Capacity)_____
Date

Revised: September 2021

**STATEMENT OF THE BIDDER'S EXPERIENCE ON MAJOR CATEGORIES OF WORK OF THE SLCC INCLUDING OTHER COMPLETED CONTRACTS
SIMILAR TO THE CONTRACT TO BE BID**

Major Categories of Work 1]	Unit of Measure 1]	Quantity 1]	SLCC similar to the contract to be bid 2]	Other completed contracts similar to the contract to be bid 2]				Unit of Measure 2]	Quantity 2]
			Name of the contract	Name of the contract	Name of the contract	Name of the contract			
1. Reinforced Concrete Works	cu.m.	312.63							
2. Rockworks (50 to 2,000 kg/pc.)	cu.m.	191.00							
3. Placing of Fill Materials / Base Course	cu.m.	80.50							
4. Construction of Building	sq.m.	355.00							

NOTE:

1] As stated in the Bid Data Sheet.

2] As appearing in the Recapitulation and/or Final Bill of Quantities.

This statement shall be supported by:

a. Notice of Award, Notice to Proceed and Contract.

b. Project Owner's Certificate of Final Acceptance issued by the owner and/ or Constructors Performance Evaluation System (CPES) Final Rating, of at least satisfactory. The said Certificate of Acceptance shall contain the following: 1) Name of project owner that issued the certificate, 2) Name of Contractor/Constructor, 3) Name of Contract, and 4) Contract Duration.

c. Recapitulation and/ or Final Bill of Quantities.

Name of Firm

Name of Bidder/Authorized Representative
Signatory's Legal Capacity

Date

Revised: September 2021

FINANCIAL DATA

- A. The prospective bidder's audited Financial Statements, showing, among others, the prospective bidder's total and current assets and liabilities, stamped "RECEIVED" by the Bureau of Internal Revenue (BIR), or its duly accredited and authorized institutions, for the preceding calendar year which should not be earlier than two (2) years from the date of bid submission.

	Year
1. Total Assets	
2. Current Assets	
3. Total Liabilities	
4. Current Liabilities	
5. Net worth (1-3)	
6. Net Working Capital (2-4)	

- B. The computation of the bidders Net Financial Contracting Capacity (NFCC) must be at least equal to the ABC to be bid, as follows:

NFCC = [(Current assets minus current liabilities) (15)] minus the value of all outstanding or uncompleted portions of the projects under ongoing contracts, including awarded contracts yet to be started coinciding with the contract to be bid.

NFCC = _____

Attached herewith are certified true copies of the audited financial statements stamped received by the BIR or BIR authorized collecting agent for the latest/immediately preceding calendar year.

Name of Firm/Applicant

Authorized Signing Official

Date: _____

NOTES:

If Partnership or Joint Venture, each Partner or Member Firm of Joint venture shall submit separate financial statements.

STATEMENT OF THE BIDDER'S KEY PERSONNEL PLEDGED FOR THE CONTRACT TO BE BID

I hereby declare that the following key personnel are qualified and available for the duration of the contract to be bid:

Position of Key Personnel 1]	Name	No. of Key Personnel	Similar Experience in the Position (Years) 2]	Total Experience in the Position (Years)	Attachment(s)	Annex(es)
Project Manager					PRC License (CE Preferred) Complete Qualification and Experience Data Certificate of Commitment	Annex " _ "
Project Engineer					PRC License (CE Preferred) Complete Qualification and Experience Data Certificate of Commitment	Annex " _ "
Materials Engineer I					PRC License (CE Preferred) Submit Valid and Renewed DPWH Certificate of Accreditation Submit Accreditation Identification Card as Materials Engineer Complete Qualification and Experience Data Certificate of Commitment	Annex " _ "
Construction Safety and Health Officer					Certificate of Safety and Health Construction Related Course issued by DOLE Accredited Trainings Complete Qualification and Experience Data Certificate of Commitment	Annex " _ "
Foreman					Complete Qualification and Experience Data Certificate of Commitment	Annex " _ "
Other Position(s)					Complete Qualification and Experience Data Certificate of Commitment	Annex " _ "

NOTE: 1] As stated in the Bid Data Sheet

2] The number of years of experience of the key personnel shall be as indicated in the qualification and experience data or curriculum vitae.

Minimum qualification requirements: The key personnel must have a work experience that is similar in nature and complexity to the contract to be bid.

Project Manager - Five (5) years

Project Engineer - Three (3) years

Foreman - Five (5) years

Construction Safety and Health Officer – One (1) year

Materials Engineer – One (1) year

Materials Engineer I – for projects costing up to 100M

Materials Engineer II – for projects costing more than 100M

Name of Firm

Name of Bidder/Authorized Representative
(Signatory's Legal Capacity)

Date

Revised: September 2021

STATEMENT OF THE BIDDER'S EQUIPMENT PLEDGED FOR THE CONTRACT TO BE BID

I hereby declare that the following equipment are in good operating condition and available for the duration of the contract to be bid:

DESCRIPTION (Type, Model, Make)	No. of Unit(s)	Capacity/ Output 1]	Owned, Leased, and/or under purchased agreement 2]	Proof of Ownership/ Leased/ Under Purchase Agreement (Mark as Annex "A.....Z") 3]	OTHER INFORMATION (As Applicable)				
					Manufacturer	Engine Serial No.	Chassis No./ Name of Vessel	Location	Status

NOTE:

- 1] The unit of capacity of the pledged equipment shall be as indicated in the Proof of Ownership, i.e. GW (for crane barge), DWT (for deck barge and hopper barge), Ton (for crane, road roller and drop hammer), kg.-m/blow (for diesel hammer), cu.m. (for dump truck), hp (for tugboat, road grader, bulldozer and concrete vibrator), cfm (for compressor), gal (for water truck with pump), amp (for welding machine), bagger (for concrete mixer). If the capacity of the pledged equipment is not indicated in the Proof of Ownership/Leased Contract/Purchased Agreement, submit other proof of capacity such as specifications, brochures or other verifiable printouts indicating the model name, model number and other details of the equipment.
- 2] Indicate if the pledged equipment are owned, leased or under purchase agreement.
- 3] If the pledged equipment is owned, It should be in the name of the bidder. Submit proof of ownership, i.e. deed of sale, sales invoice, official receipt; For owned Water Truck, Dump Truck and Transit Mixer submit LTO Certificate of Registration and valid Official Receipt; For owned barge/tugboat, submit Marina Certificate of Ownership and valid Cargo Ship Safety Certificate.

If the pledged equipment is leased/under purchased agreement, submit certification of availability of equipment from the equipment lessor/vendor for the duration of the project, and duly Notarized copy of leased contract/purchased agreement.

If the pledged barge/tugboat is leased/under purchase agreement, submit certification of availability of barge/tugboat from the equipment lessor/vendor for the duration of the project, and duly Notarized copy of leased contract/purchased agreement together with a copy of the Marina Certificate of Ownership and valid Cargo Ship Safety Certificate.

The Minimum Major Equipment Requirements are listed in Section 8, Annex 3.

Name of Firm

Name of Bidder/Authorized Representative
(Signatory's Legal Capacity)

Date

Revised: September 2021

Omnibus Sworn Statement for Sole Proprietorship
[shall be submitted with the Bid]

REPUBLIC OF THE PHILIPPINES)
CITY/MUNICIPALITY OF _____) S.S.

AFFIDAVIT

I, _____, of legal age, [Civil Status], [Nationality], and residing at _____, after having been duly sworn in accordance with law, do hereby depose and state that:

1. I am the sole proprietor or authorized representative of _____ with office address at _____;
2. As the owner and sole proprietor, or authorized representative of _____, I have full power and authority to do, execute and perform any and all acts necessary to participate, submit the bid, and to sign and execute the ensuing contract for **Restoration of Port Facilities Damaged by Typhoon "Tisoy", Port of Claveria, Burias Island, Masbate of the Philippine Ports Authority**, as shown in the attached duly notarized Special Power of Attorney;
3. [Name of Bidder] is not "blacklisted" or barred from bidding by the Government of the Philippines or any of its agencies, offices, corporations, or Local Government Units, foreign government/foreign or international financing institution whose blacklisting rules have been recognized by the Government Procurement Policy Board, by itself or by relation, membership, association, affiliation, or controlling interest with another blacklisted person or entity as defined and provided for in the Uniform Guidelines on Blacklisting;
4. Each of the documents submitted in satisfaction of the bidding requirements is an authentic copy of the original, complete, and all statements and information provided therein are true and correct;
5. [Name of Bidder] is authorizing the Head of the Procuring Entity or its duly authorized representative(s) to verify all the documents submitted;
6. The owner or sole proprietor is not related to the Head of the Procuring Entity, members of the Bids and Awards Committee (BAC), the Technical Working Group, and the BAC Secretariat, the head of the Project Management Office or the end-user unit, and the project consultants by consanguinity or affinity up to the third civil degree;
7. [Name of Bidder] complies with existing labor laws and standards; and
8. [Name of Bidder] is aware of and has undertaken the responsibilities as a Bidder in compliance with the Philippine Bidding Documents, which includes:
 - a. Carefully examining all of the Bidding Documents;
 - b. Acknowledging all conditions, local or otherwise, affecting the implementation of the Contract;
 - c. Making an estimate of the facilities available and needed for the contract to be bid, if any; and
 - d. Inquiring or securing Supplemental/Bid Bulletin(s) issued for the [Name of the Project].

9. *[Name of Bidder]* did not give or pay directly or indirectly, any commission, amount, fee, or any form of consideration, pecuniary or otherwise, to any person or official, personnel or representative of the government in relation to any procurement project or activity.
10. **In case advance payment was made or given, failure to perform or deliver any of the obligations and undertakings in the contract shall be sufficient grounds to constitute criminal liability for Swindling (Estafa) or the commission of fraud with unfaithfulness or abuse of confidence through misappropriating or converting any payment received by a person or entity under an obligation involving the duty to deliver certain goods or services, to the prejudice of the public and the government of the Philippines pursuant to Article 315 of Act No. 3815 s. 1930, as amended, or the Revised Penal Code.**

IN WITNESS WHEREOF, I have hereunto set my hand this ___ day of ___, 20__ at _____, Philippines.

Name of Bidder/ Authorized Representative
(Signatory's Legal Capacity)
AFFIANT

[Jurat]
[Format shall be based on the latest Rules on Notarial Practice]

Omnibus Sworn Statement for Partnership or Cooperative
[shall be submitted with the Bid]

REPUBLIC OF THE PHILIPPINES)
CITY/MUNICIPALITY OF _____) S.S.

AFFIDAVIT

I, _____, of legal age, [Civil Status], [Nationality], and residing at _____, after having been duly sworn in accordance with law, do hereby depose and state that:

1. I am the duly authorized and designated representative of _____ with office address at _____;
2. I am granted full power and authority to do, execute and perform any and all acts necessary to participate, submit the bid, and to sign and execute the ensuing contract for **Restoration of Port Facilities Damaged by Typhoon “Tisoy”, Port of Claveria, Burias Island, Masbate** of the **Philippine Ports Authority**, as shown in the attached [state title of attached document showing proof of authorization (e.g., duly notarized Secretary’s Certificate, Board/Partnership Resolution, or Special Power of Attorney, whichever is applicable);];
3. [Name of Bidder] is not “blacklisted” or barred from bidding by the Government of the Philippines or any of its agencies, offices, corporations, or Local Government Units, foreign government/foreign or international financing institution whose blacklisting rules have been recognized by the Government Procurement Policy Board, by itself or by relation, membership, association, affiliation, or controlling interest with another blacklisted person or entity as defined and provided for in the Uniform Guidelines on Blacklisting;
4. Each of the documents submitted in satisfaction of the bidding requirements is an authentic copy of the original, complete, and all statements and information provided therein are true and correct;
5. [Name of Bidder] is authorizing the Head of the Procuring Entity or its duly authorized representative(s) to verify all the documents submitted;
6. None of the officers and members of [Name of Bidder] is related to the Head of the Procuring Entity, members of the Bids and Awards Committee (BAC), the Technical Working Group, and the BAC Secretariat, the head of the Project Management Office or the end-user unit, and the project consultants by consanguinity or affinity up to the third civil degree;
7. [Name of Bidder] complies with existing labor laws and standards; and
8. [Name of Bidder] is aware of and has undertaken the responsibilities as a Bidder in compliance with the Philippine Bidding Documents, which includes:
 - a. Carefully examining all of the Bidding Documents;
 - b. Acknowledging all conditions, local or otherwise, affecting the implementation of the Contract;
 - c. Making an estimate of the facilities available and needed for the contract to be bid, if any; and
 - d. Inquiring or securing Supplemental/Bid Bulletin(s) issued for the [Name of the Project].

9. *[Name of Bidder]* did not give or pay directly or indirectly, any commission, amount, fee, or any form of consideration, pecuniary or otherwise, to any person or official, personnel or representative of the government in relation to any procurement project or activity.
10. **In case advance payment was made or given, failure to perform or deliver any of the obligations and undertakings in the contract shall be sufficient grounds to constitute criminal liability for Swindling (Estafa) or the commission of fraud with unfaithfulness or abuse of confidence through misappropriating or converting any payment received by a person or entity under an obligation involving the duty to deliver certain goods or services, to the prejudice of the public and the government of the Philippines pursuant to Article 315 of Act No. 3815 s. 1930, as amended, or the Revised Penal Code.**

IN WITNESS WHEREOF, I have hereunto set my hand this ___ day of ___, 20__ at _____, Philippines.

Name of Bidder/ Authorized Representative
(Signatory's Legal Capacity)
AFFIANT

[Jurat]
[Format shall be based on the latest Rules on Notarial Practice]

Omnibus Sworn Statement for Corporation or Joint Venture
[shall be submitted with the Bid]

REPUBLIC OF THE PHILIPPINES)
CITY/MUNICIPALITY OF _____) S.S.

AFFIDAVIT

I, _____, of legal age, [Civil Status], [Nationality], and residing at _____, after having been duly sworn in accordance with law, do hereby depose and state that:

1. I am the duly authorized and designated representative of _____ with office address at _____;
2. I am granted full power and authority to do, execute and perform any and all acts necessary to participate, submit the bid, and to sign and execute the ensuing contract for **Restoration of Port Facilities Damaged by Typhoon “Tisoy”, Port of Claveria, Burias Island, Masbate**, as shown in the attached [state title of attached document showing proof of authorization (e.g., duly notarized Secretary’s Certificate, Board/Partnership Resolution, or Special Power of Attorney, whichever is applicable)];
3. [Name of Bidder] is not “blacklisted” or barred from bidding by the Government of the Philippines or any of its agencies, offices, corporations, or Local Government Units, foreign government/foreign or international financing institution whose blacklisting rules have been recognized by the Government Procurement Policy Board, by itself or by relation, membership, association, affiliation, or controlling interest with another blacklisted person or entity as defined and provided for in the Uniform Guidelines on Blacklisting;
4. Each of the documents submitted in satisfaction of the bidding requirements is an authentic copy of the original, complete, and all statements and information provided therein are true and correct;
5. [Name of Bidder] is authorizing the Head of the Procuring Entity or its duly authorized representative(s) to verify all the documents submitted;
6. None of the officers, directors, and controlling stockholders of [Name of Bidder] is related to the Head of the Procuring Entity, members of the Bids and Awards Committee (BAC), the Technical Working Group, and the BAC Secretariat, the head of the Project Management Office or the end-user unit, and the project consultants by consanguinity or affinity up to the third civil degree;
7. [Name of Bidder] complies with existing labor laws and standards; and
8. [Name of Bidder] is aware of and has undertaken the responsibilities as a Bidder in compliance with the Philippine Bidding Documents, which includes:
 - a. Carefully examining all of the Bidding Documents;
 - b. Acknowledging all conditions, local or otherwise, affecting the implementation of the Contract;
 - c. Making an estimate of the facilities available and needed for the contract to be bid, if any; and
 - d. Inquiring or securing Supplemental/Bid Bulletin(s) issued for the [Name of the Project].
9. [Name of Bidder] did not give or pay directly or indirectly, any commission, amount, fee, or any form of consideration, pecuniary or otherwise, to any person or official, personnel or representative

of the government in relation to any procurement project or activity.

10. In case advance payment was made or given, failure to perform or deliver any of the obligations and undertakings in the contract shall be sufficient grounds to constitute criminal liability for Swindling (Estafa) or the commission of fraud with unfaithfulness or abuse of confidence through misappropriating or converting any payment received by a person or entity under an obligation involving the duty to deliver certain goods or services, to the prejudice of the public and the government of the Philippines pursuant to Article 315 of Act No. 3815 s. 1930, as amended, or the Revised Penal Code.

IN WITNESS WHEREOF, I have hereunto set my hand this ___ day of ___, 20__ at _____, Philippines.

Name of Bidder/ Authorized Representative
(Signatory's Legal Capacity)
AFFIANT

[Jurat]

[Format shall be based on the latest Rules on Notarial Practice]

Bid Securing Declaration Form

[shall be submitted with the Bid if bidder opts to provide this form of bid security]

REPUBLIC OF THE PHILIPPINES)
CITY OF _____) S.S.

BID SECURING DECLARATION **Project Identification No.:** _____

To: Philippine Ports Authority
PPA Building, Bonifacio Drive,
South Harbor, Port Area, Manila

I/We, the undersigned, declare that:

1. I/We understand that, according to your conditions, bids must be supported by a Bid Security, which may be in the form of a Bid Securing Declaration.
2. I/We accept that: (a) I/we will be automatically disqualified from bidding for any procurement contract with any procuring entity for a period of two (2) years upon receipt of your Blacklisting Order; and, (b) I/we will pay the applicable fine provided under Section 6 of the Guidelines on the Use of Bid Securing Declaration, within fifteen (15) days from receipt of the written demand by the procuring entity for the commission of acts resulting to the enforcement of the bid securing declaration under Sections 23.1(b), 34.2, 40.1 and 69.1, except 69.1(f), of the IRR of RA No. 9184; without prejudice to other legal action the government may undertake.
3. I/We understand that this Bid Securing Declaration shall cease to be valid on the following circumstances:
 - a. Upon expiration of the bid validity period, or any extension thereof pursuant to your request;
 - b. I am/we are declared ineligible or post-disqualified upon receipt of your notice to such effect, and (i) I/we failed to timely file a request for reconsideration or (ii) I/we filed a waiver to avail of said right; and
 - c. I am/we are declared the bidder with the Lowest Calculated Responsive Bid, and I/we have furnished the performance security and signed the Contract.

IN WITNESS WHEREOF, I/We have hereunto set my/our hand/s this ____ day of [month] [year] at [place of execution].

Name of Bidder/ Authorized Representative
(Signatory's Legal Capacity)
AFFIANT

[Jurat]

[Format shall be based on the latest Rules on Notarial Practice]

CONSTRUCTION METHODOLOGY

Name of Project : _____
Project Description : _____
Location : _____

MINIMUM SCOPE OF CONSTRUCTION METHODOLOGY

A. RESTORATION OF DAMAGED ROCK CAUSEWAY/SLOPE PROTECTION

1. Demolition and Disposal of the collapsed portion in the marshalling area (1 lot)
2. Supply and place armour rocks, 1-2 tons per pc (97 cu.m.), and 50-100kg core rocks (285 cu.m.)
3. Supply, spread and compact selected fill materials (133 cu.m.), and aggregate base course (28 cu.m.). When side forms have been securely set to grade, the subgrade or base course shall be brought to proper cross-section. High areas shall be trimmed to proper elevation. Low areas shall be filled and compacted to a condition similar to that of surrounding grade. The finished grade shall be maintained in a smooth and compacted condition until the pavement is placed.
4. Supply and place 3,500 psi concrete (40.18 cu.m.). Only Type I Portland Cement shall be used unless otherwise provided for in the Special Provisions. Different brands or the same brands from different mills shall not be mixed nor shall they be used alternately unless the mix is approved by the Engineer.
5. Restoration of concrete toe supply and place 3,500 psi concrete (299.36 cu.m.) and reinforcing steel bars (4,544.64 kg of 16mm dia.) for superstructure
6. Restoration of concrete facing supply and place 3,500 psi concrete (285.72 cu.m.) and reinforcing steel bars (18,797.184 kg of 12mm dia.) for superstructure

B. RESTORATION OF DAMAGED PASSENGER TERMINAL BUILDING

1. Removal and Replacement of Canopy/Roofing (16 sq.m.) use polycarbonate skylight roofing
2. Replacement of various doors and windows (1 lot)
3. Replacement of various materials and fixtures for plumbing (1 lot)
4. Replacement of various materials and fixtures for electrical and lighting (1 lot)
5. Supply and application of painting (355 sq.m.) eliminate seepage, dirt, oil fatigue, paint imprint by using a variety of equipment such as cloth, sandpaper, plaster, and blades, sanding on the faulty surface, apply putty to fill the gaps of the needle, tv wall mount, AC mount, cracks on surface and patches. Wait for the putty to dry. Approx

3—4 hours, do another round of sanding after putty dry, this helps to level the surface then apply primer wait for the primer to dry and apply one coat of paint wait for the paint to dry then go for the second coat.

NOTES:

The narrative construction method will guide and familiarize the contractor and the PPA on how the project shall be carried out in accordance with the highest standard of workmanship.

The construction method shall be consistent with the Bar Chart / S-Curve Schedule, Equipment Schedule and Manpower Schedule.

Name of Bidder/Authorized Representative
(Signatory's Legal Capacity)

MANPOWER SCHEDULE

Name of Project : _____

Project Description : _____

Location : _____

MANPOWER (Minimum)	CONTRACT DURATION (<u>120</u> Calendar Days)																			
	M O N T H L Y																			
	1	2	3	4	5	6	7	8	9	10	11	12	13	14	15	16	17	18	19	20
Project Manager																				
Project Engineer																				
Materials Engineer I																				
Construction Safety and Health Officer																				
Construction Foreman																				
Specify other applicable positions, ie.:																				
- Skilled Worker																				
- Laborer																				
- Others																				

Name of Bidder/Authorized Representative
(Signatory's Legal Capacity)

Revised: September 2021

EQUIPMENT UTILIZATION SCHEDULE

Name of Project : _____

Project Description : _____

Location : _____

EQUIPMENT (Minimum)	No. of Units	CONTRACT DURATION (<u>120</u> Calendar Days)																			
		M O N T H L Y																			
		1	2	3	4	5	6	7	8	9	10	11	12	13	14	15	16	17	18	19	20
Jackhammer with Air Compressor (250 cfm, minimum), owned																					
Boom Truck (3T cap., minimum), owned																					
Crawler Crane (30T cap., minimum),,, owned/leased																					
Dump Truck (9 cu. yards, minimum),,, owned																					
Road Roller (10T Vibratory, minimum),,, owned																					
Concrete Mixer (1 bagger, minimum), owned																					
Concrete Vibrator (3.5 hp, minimum), owned																					
Concrete Cutter, owned																					
Bar Cutter, owned																					
Water Truck (1000 gals, minimum), 1 owned																					
Backhoe (2 cu.m, minimum), owned																					
Payloader (1.7 cu.m., 125 hp, minimum), 1 owned																					

Name of Bidder/Authorized Representative
(Signatory's Legal Capacity)

Revised: September 2021

CASHFLOW BY QUARTER AND PAYMENT SCHEDULE

Name of Project: _____

Project Description: _____

Location: _____

Project Duration (days or months)	Payment Schedule (Monthly, in Pesos)	Cash flow (Quarterly, in Pesos)
TOTAL		

NOTES

- The cash flow by quarter and payment schedule should be consistent with the Bar Chart and S-curb.
- Payment schedule shall not be more than once a month.

**Name of Bidder/Authorized Representative
(Signatory's Legal Capacity)**

Revised: September 2021

Contract Agreement Form for the Procurement of Infrastructure Projects (Revised)

[not required to be submitted with the Bid, but it shall be submitted within ten (10) days after receiving the Notice of Award]

CONTRACT AGREEMENT

THIS AGREEMENT, made this _____ day of _____, _____ between **Philippine Ports Authority** with principal office at PPA Building, Bonifacio Drive, South Harbor, Port Area, Manila (hereinafter called the "Entity") and **[name and address of Contractor]** (hereinafter called the "Contractor").

WHEREAS, the Entity is desirous that the Contractor execute **[name and identification number of contract]** (hereinafter called "the Works") and the Entity has accepted the Bid for **[contract price in words and figures in specified currency]** by the Contractor for the execution and completion of such Works and the remedying of any defects therein.

NOW THIS AGREEMENT WITNESSETH AS FOLLOWS:

1. In this Agreement, words and expressions shall have the same meanings as are respectively assigned to them in the Conditions of Contract hereinafter referred to.
2. The following documents as required by the 2016 revised Implementing Rules and Regulations of Republic Act No. 9184 shall be deemed to form and be read and construed as part of this Agreement, viz.:

- a. Philippine Bidding Documents (PBDs);
 - i. Drawings/Plans;
 - ii. Specifications;
 - iii. Bill of Quantities;
 - iv. General and Special Conditions of Contract;
 - v. Supplemental or Bid Bulletins, if any;
- b. Winning bidder's bid, including the Eligibility requirements, Technical and Financial Proposals, and all other documents or statements submitted;

Bid form, including all the documents/statements contained in the Bidder's bidding envelopes, as annexes, and all other documents submitted (e.g., Bidder's response to request for clarifications on the bid), including corrections to the bid, if any, resulting from the Procuring Entity's bid evaluation;

- c. Performance Security;
- d. Notice of Award of Contract and the Bidder's conforme thereto; and

- e. Other contract documents that may be required by existing laws and/or the Procuring Entity concerned in the PBDs. **Winning bidder agrees that additional contract documents or information prescribed by the GPPB that are subsequently required for submission after the contract execution, such as the Notice to Proceed, Variation Orders, and Warranty Security, shall likewise form part of the Contract.**
3. In consideration for the sum of [total contract price in words and figures] or such other sums as may be ascertained, [Named of the bidder] agrees to [state the object of the contract] in accordance with his/her/its Bid.
4. The **Philippine Ports Authority** agrees to pay the above-mentioned sum in accordance with the terms of the Bidding.

IN WITNESS whereof the parties thereto have caused this Agreement to be executed the day and year first before written.

JAY DANIEL R. SANTIAGO
General Manager

for:

Philippine Ports Authority

**Name of Bidder/ Authorized
Representative**
(Signatory's Legal Capacity)

for:

Contractor

Acknowledgment

[Format shall be based on the latest Rules on Notarial Practice]